

OBERLIN ROAD EASEMENT OVER B. & O. RAILROAD

FED. RD. DIVISION	STATE	PROJECT
2	OHIO	

OBERLIN ROAD VIADUCT
STARK COUNTY ROAD 374

44

3
5

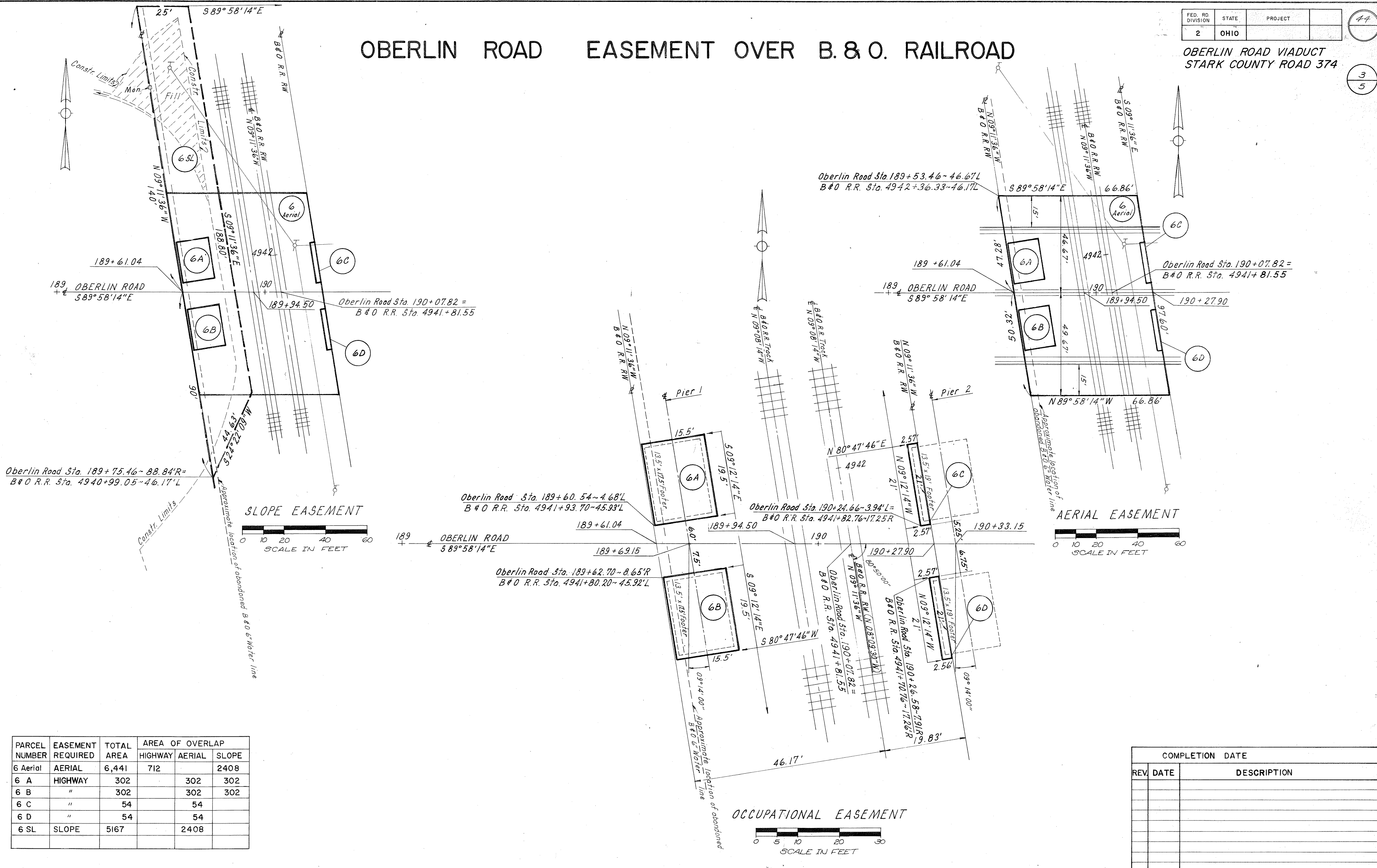

PARCEL NUMBER	EASEMENT REQUIRED	TOTAL AREA	AREA OF OVERLAP		
			HIGHWAY	AERIAL	SLOPE
6 Aerial	AERIAL	6,441	712		2408
6 A	HIGHWAY	302		302	302
6 B	"	302		302	302
6 C	"	54		54	
6 D	"	54		54	
6 SL	SLOPE	5167		2408	

COMPLETION DATE		
REV	DATE	DESCRIPTION