

DATE: MARCH 19, 2012

CLERK: MARY BETH BAILEY

MASSILLON CITY COUNCIL
CITY OF MASSILLON, OHIO
GLENN E. GAMBER, PRESIDENT

COUNCIL CHAMBERS

LEGISLATIVE DEPARTMENT

ORDINANCE NO. 29 - 2012

BY: COMMUNITY DEVELOPMENT COMMITTEE

TITLE: AN ORDINANCE accepting an application for annexation for the Cincinnati Area Annexation to the City of Massillon, Ohio, and declaring an emergency.

WHEREAS, a petition for the annexation for certain territory in Perry Township, was duly filed by Jason Haines, Agent for the petitioners, and

WHEREAS, the said petition was duly considered by the Board of County Commissioners of Stark County on December 7, 2011, and

WHEREAS, the Board of County Commissioners on December 7, 2011, approved the annexation of said territory to the City of Massillon as hereinafter described, and

WHEREAS, the Board of County Commissions certified the transcript and pertinent documents of proceedings in connection with said annexation with the map and petition required in connection therewith, to the Auditor of the City of Massillon

WHEREAS, at least two-thirds of the members elected to Council of the City of Massillon Ohio, have found, considered and determined that in order to annex said territory to the City of Massillon, this constitutes an emergency, requiring immediate action.

NOW, THEREFORE, BE IT ORDAINED BY THE COUNCIL OF THE CITY OF MASSILLON, STATE OF OHIO, THAT

Section 1:

The application of Jason Haines for the petitioners is hereby accepted for the annexation of the following described territory in the County of Stark and adjacent to the City of Massillon, to wit:
See Exhibit "A" attached hereto

Section 2:

The City Council Clerk be and is hereby directed to file certified copies of said annexation containing the petition, map accompanying the petition, a transcript of the proceedings of the County Commissioners, and this Ordinance, with the Stark County Recorder and the Secretary of State.

Section 3:

The Clerk of this Council be and is hereby directed to file with the Clerk of the Board of Commissioners of Stark County, as well as the County Board of Elections, notice in writing of the boundary changes of the City of Massillon hereby affected together with a map of the annexed territory.

Section 4:

This Ordinance is declared to be an emergency measure, the reason for the emergency being that said enactment is necessary for the more efficient operation of the City of Massillon, Ohio, and for the additional reason that it is in the best interest of the property owners in the annexed area that their property become a part of the City of Massillon. Provided it receives the affirmative vote of two-thirds of the elected members to Council, it shall take effect and be in force immediately upon its passage and approval by the mayor. Otherwise, it shall take effect and be in force from and after the earliest period allowed by law.

PASSED IN COUNCIL THIS 19th DAY OF March 2012

APPROVED:

Mary Beth Bailey
MARY BETH BAILEY, CLERK OF COUNCIL

Glenn E. Gamber
GLENN E. GAMBER, PRESIDENT

APPROVED:

March 00, 2012

Katherine Catazaro-Perry
KATHERINE CATAZARO-PERRY, MAYOR

I hereby certify that the foregoing ordinance is a true copy of the original, as passed by the Council of the City of Massillon, Ohio, and approved as noted thereon:

Mary Beth Bailey
Clerk of Council

Date 3/19/12

**PETITION
BY CITIZENS FOR THE CINCINNATI AREA ANNEXATION
TO THE CITY OF MASSILLON, OHIO**

TO THE COMMISSIONERS OF STARK COUNTY, STATE OF OHIO:

We, the undersigned, being a majority of the adult owners of real estate in the territory hereinafter described, hereby petition for the annexation of the following described territory to the City of Massillon, Massillon Township, Stark County, Ohio. The following description is based solely on record information found in the Stark County Official Records. A boundary survey was not performed.

Beginning at a point being the northwest corner of the Northwest Quarter of Section 28, Perry Township and also being the northwest corner of a parcel deeded to the State of Ohio in Volume 2510, Page 401;

Thence southeasterly along the northerly line of said section line S 88°07'16" E, 561.22 feet to a point, said point being on the northerly Right of Way line of US Route 30 and **THE TRUE PLACE OF BEGINNING** for the land hereinafter described;

Thence continuing southeasterly along said northerly right of way line S 88°07'16" E, 81.99 feet to a point also being a point of curvature;

Thence continuing northeasterly along said right of way line and the arc of a circle curving to the left, said curve having a radius of 2889.79 feet, a Delta of 01°25'42", a Chord Length of 72.04 feet, and a Chord bearing N 84°20'50" E to a point of tangency;

Thence continuing along said northerly right of way line the following courses;

- N 82°17'24" E, 163.36 feet;
- N 72°04'12" E, 565.56 feet;
- S 17°55'47" E, 30.00 feet;
- S 72°04'12" W, 120.74 feet;
- S 05°21'30" E, 40.11 feet;
- N 83°20'34" E, 589.81 feet;
- N 84°36'37" E, 1507.87 feet;
- N 80°16'20" E, 1101.98 feet;

- N 77°24'49" E, 1035.93 feet to a point located on the westerly line of Section 22, Perry Township, said section line also being an existing corporation line for the City of Massillon;

Thence continuing southwesterly along said Section line and corporation line, S 01°47'40" W, 273.57 feet to a point, said point also being located on the Southerly Right of Way line of US Route 30;

Thence continuing southwesterly along said right of way line S 77°09'54" W, 1037.09 feet to a point also being the northeast corner of a parcel of land deeded to the City of Massillon in I.R. # 200911180047026;

Thence continuing southwesterly along said City of Massillon parcel S 01°47'40" W, 341.14 feet to point, said point lying on the Northerly line of Section 28, Perry Township and also being the southerly line of said City of Massillon parcel;

Thence continuing northwesterly along said section line N 88°07'16" W, 1073.38 feet to a point; said point also being an existing corporation line for the City of Massillon and also the southwest corner of said deeded parcel to the City of Massillon;

Thence continuing northeasterly along said City of Massillon parcel, N 00°52'40" E, 155.95 feet to a point, said point also being located on the southerly Right of way line of US Route 30;

Thence continuing southwesterly along said Right of Way line the following courses:

- S 82°55'55" W, 348.46 feet;
- S 84°45'09" W, 2549.62 feet to a point, said point also being the southeast corner of a parcel of land deeded to the State of Ohio in Volume 3505, Page 259;

Thence continuing northeasterly along the east line of said State of Ohio parcel N 13°07'40" E, 218.77 feet, to **THE TRUE PLACE OF BEGINNING** and containing 34.947 acres of land, more or less.

The bearings for the above description are based on the northerly line of Section 28, S 88°07'16" E, as recorded in Volume 3510 Page 384 of the Stark County Official Records.

CITY OF MASSILLON
 CORPORATION LIMITS

PRESIDENT
 CHIEF CLERK
 AUDITOR

MAY 10 1961
 AVIATION

STARK COUNTY COMMISSIONER

LOCATION MAP
NOT TO SCALE

TOTAL ACREAGE IN ANNEXATION 31.965 ACRES (DEED)

BASIS OF BEARING

PERTINENT DOCUMENTS

DEEDS:

[illegible]

CINCINNATI AREA ANNEXATION
PART OF THE SE AND SW QUARTER SECTION 21, PERRY TOWNSHIP
AND PART OF THE NW QUARTER SECTION 20, PERRY TOWNSHIP
ANNEXATION MAP
CITY OF MASSILLON
STARK COUNTY, OHIO

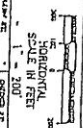

JAN	KAD
JAN 2011	JAN 2011

[illegible]

DETAIL "A"
NOT TO SCALE

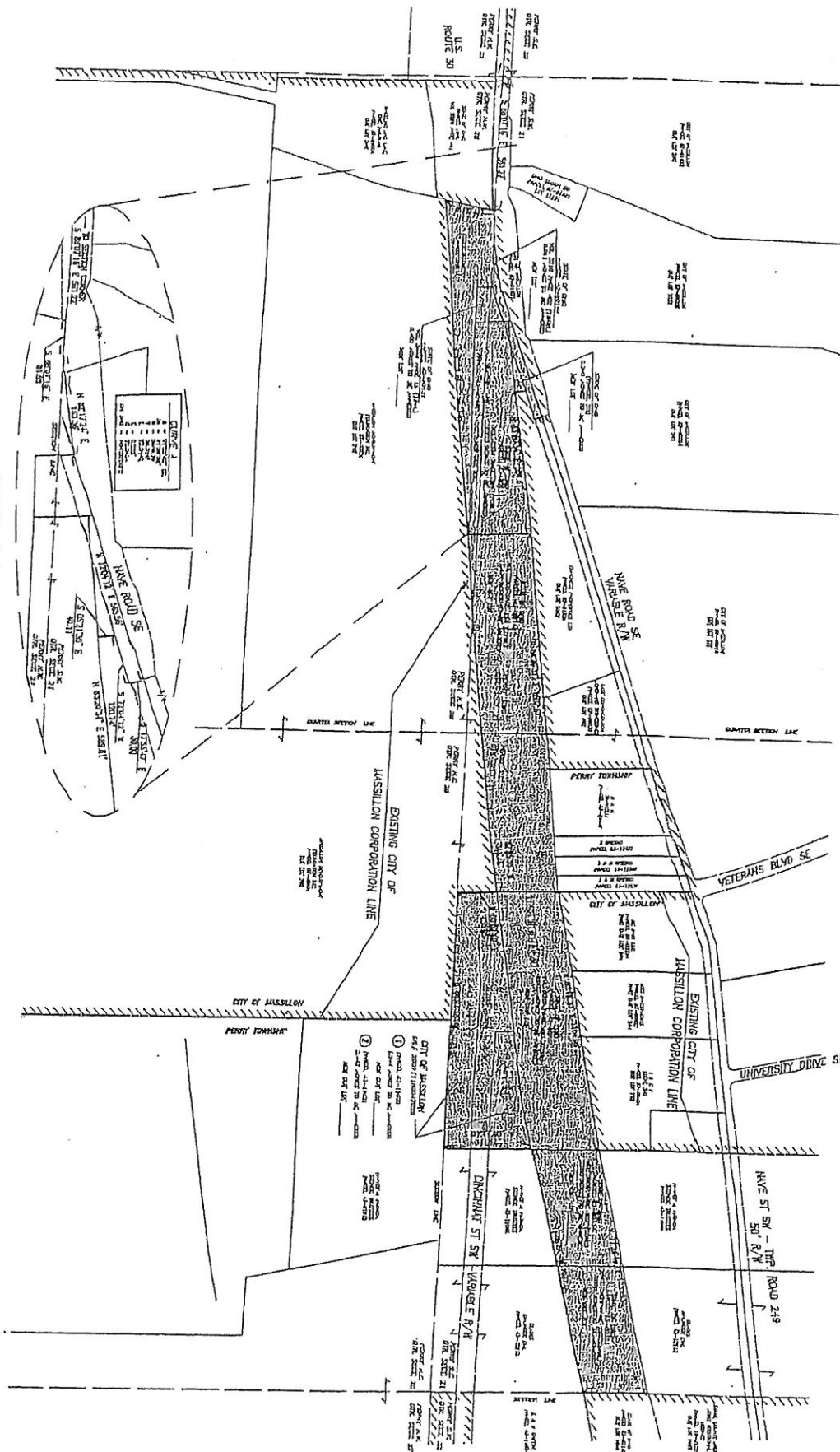

CINCINNATI AREA ANNEXATION
PART OF THE SE AND SW QUARTER SECTION 21, PERRY TOWNSHIP
AND PART OF THE NW QUARTER SECTION 20, PERRY TOWNSHIP
ANNEXATION MAP
CITY OF MASSILLON
STARK COUNTY, OHIO

HORIZONTAL SCALE IN FEET 1" = 200'	DATE JAN 2011
DRAWN BY JAN	DATE JAN 2011
CHECKED BY KAO	DATE JAN 2011



DATE	REVISIONS	DESCRIPTION

ELECTRONIC FILE NAME
 1040201.DWG
 DRAWN BY
 104020