

SAN. SEWER TORN OUT FOR NEW
 THE MASSINE CORP. San sewer lateral
 FROM EX. MH. ON SOUTH SIDE OF LINCOLN WAY E. SHOPPING CENTER,
 NORTHERLY 630 FT. BUILT IN 1948 BY H. SHULLO
 CONST. CO. H. PIPER CITY & CONST. ENGR. JOHN
 EHMER INSP. PLOTTED IN 1948 BY DOC.
 MAY 1986
 scale = 1" = 5' ver. 1" = 50' hor.
 ONLY 6" STUB OUT OF MANHOLE
 FOR PROPOSED MCDONALD RESTAURANT

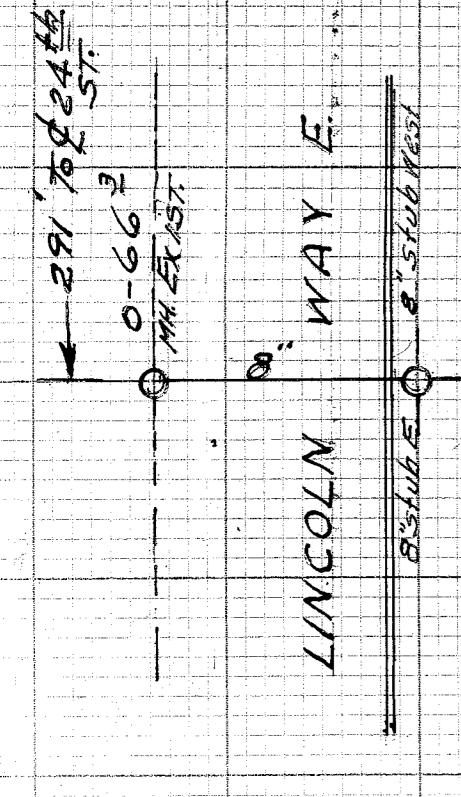
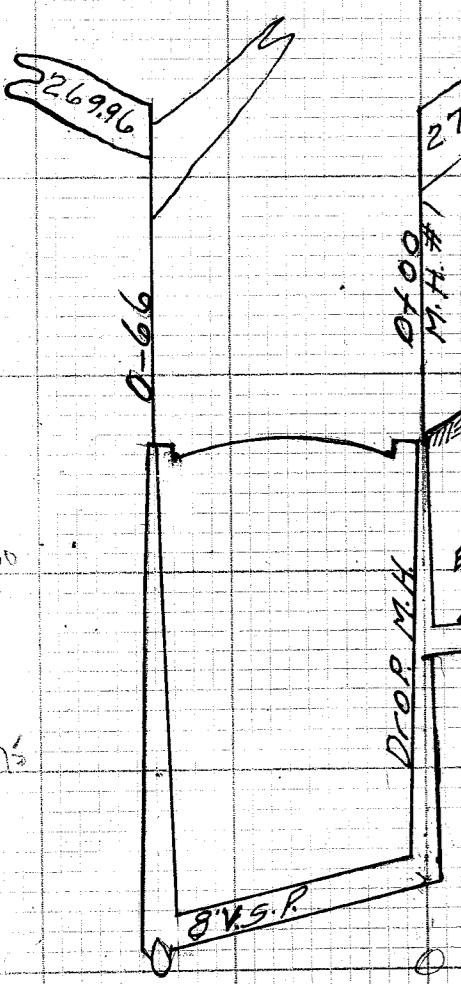

291' 78" 24" ST.
 0-66
 MH EXIST.
 LINCOLN WAY E.
 8" stub West

2269.96
 0-66
 MH #1
 277.74
 6" V.S.P. @ 1.00%
 6" V.S.P. @ 1.00%
 8" V.S.P.

279.99
 MH #2
 2425
 6" V.S.P. @ 1.00%
 3x25
 1.74%
 4' Deep
 10'
 SCREEN

MH #3
 4194
 6" V.S.P. @ 1.00%
 3' Deep
 Projecting Room

18268
 MH #3
 4194
 6" V.S.P. @ 1.00%

6" STUB FOR MCDONALD'S
 6" V.S.P. @ 1.00%