

MID-BLOCK PEDESTRIAN CROSSWALK

CITY OF MASSILLON
STARK COUNTY

INDEX OF SHEETS:

| | |
|---------------|---|
| TITLE SHEET | 1 |
| GENERAL NOTES | 2 |
| PLAN SHEET | 3 |

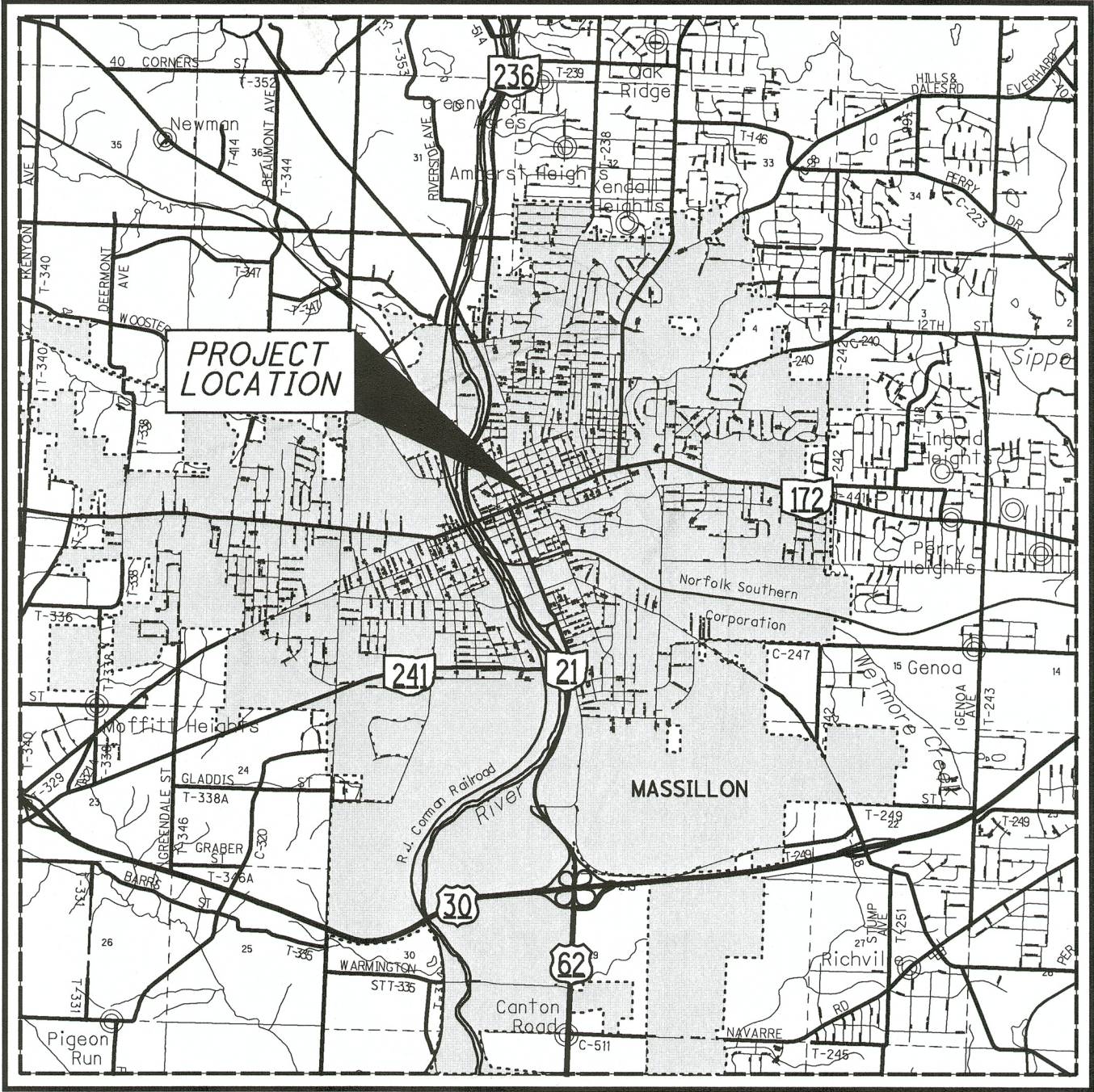

LOCATION MAP

LATITUDE: 40°47'50" LONGITUDE: 81°31'15"

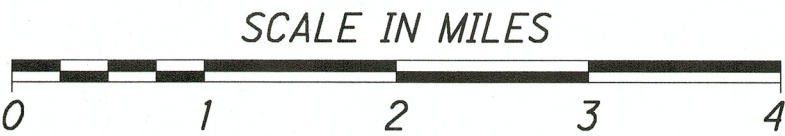

| | |
|-------------------------|--|
| INTERSTATE HIGHWAY | |
| STATE & FEDERAL ROUTES | |
| COUNTY & TOWNSHIP ROADS | |
| OTHER ROADS | |

2010 SPECIFICATIONS

THE STANDARD SPECIFICATIONS OF THE STATE OF OHIO, DEPARTMENT OF TRANSPORTATION, INCLUDING CHANGES AND SUPPLEMENTAL SPECIFICATIONS LISTED IN THE PROPOSAL SHALL GOVERN THIS IMPROVEMENT.

ENGINEER / SURVEYOR

HAMMONTREE & ASSOCIATES, LIMITED
5233 STONEHAM ROAD
NORTH CANTON, OHIO 44720

ATTN: WILLIAM L. CROXTON, P.E.
PHONE: 330-499-8817
FAX: 330-499-0149

OWNER / DEVELOPER

MASSILLON PUBLIC LIBRARY
208 LINCOLN WAY EAST
MASSILLON, OH 44646

ATTN: CAMILLE LESLIE, DIRECTOR
PHONE: 330-832-9831, EXT. 314

UNDERGROUND UTILITIES

CONTACT BOTH SERVICES
CALL TWO WORKING DAYS
BEFORE YOU DIG

CALL
1-800-362-2764
(TOLL FREE)

OHIO UTILITIES PROTECTION SERVICE
NON-MEMBERS
MUST BE CALLED DIRECTLY

OIL & GAS PRODUCERS PROTECTIVE
SERVICE CALL: 1-800-925-0988

| ENGINEERS SEAL: | | OHIO DEPT. OF TRANSPORTATION STANDARD CONSTRUCTION DRAWINGS | | CITY OF MASSILLON STANDARD CONSTRUCTION DRAWINGS | |
|-----------------|---------------------------|--|----------|---|--|
| | SIGNED DATE: 7/16/2011 | BP-7.1 | 10/15/10 | CURB RAMP ADA DETAIL | |
| | | TC-42.20 | 1/21/11 | | |
| | | TC-52.10 | 1/19/07 | | |
| | | TC-52.20 | 1/19/07 | | |
| | | | | | |

APPROVED DATE 7/15/11 MASSILLON CITY ENGINEER

APPROVED DATE _____ MASSILLON PUBLIC LIBRARY

NOTIFICATION OF MASSILLON PUBLIC LIBRARY

THE CONTRACTOR SHALL NOTIFY THE LIBRARY DIRECTOR OF THE MASSILLON PUBLIC LIBRARY AT LEAST 48 HOURS IN ADVANCE OF ANY CONSTRUCTION ACTIVITIES FOR THIS PROJECT.

CAMILLE J. LESLIE, DIRECTOR
MASSILLON PUBLIC LIBRARY
208 LINCOLN WAY EAST
MASSILLON, OH 44646
PHONE: 330-832-9831 x314
EMAIL: lesliec@massillonlibrary.org

NOTIFICATION OF SAFETY FORCES AND BUS GARAGES

THE CONTRACTOR SHALL NOTIFY ALL APPLICABLE AGENCIES LISTED BELOW AT LEAST 48 HOURS IN ADVANCE OF ANY STREET CLOSING OR TRAFFIC CHANGE.

| | |
|---|--|
| MASSILLON SAFETY SERVICE 330-830-1702 | PERRY TOWNSHIP HALL 330-833-2141 |
| TUSCARAWAS TOWNSHIP HALL 330-832-4337 | MASSILLON POLICE DEPARTMENT 330-830-1735 |
| JACKSON TOWNSHIP HALL 330-832-7416 | JACKSON POLICE DEPARTMENT 330-834-3960 |
| PERRY POLICE DEPARTMENT 330-478-5121 | STARK COUNTY SHERIFF 330-430-3800 |
| SARTA 330-454-5333 | NORTH LAWRENCE FIRE DEPT. 330-832-6347 |
| MASSILLON FIRE DEPARTMENT 330-833-1053 | MASSILLON SCHOOL BUS GARAGE 330-830-1849 |
| JACKSON FIRE DEPARTMENT 330-834-3950 | JACKSON SCHOOL BUS GARAGE 330-830-8042 |
| PERRY FIRE DEPARTMENT 330-833-3865 | TUSCARAWAS SCHOOL BUS GARAGE 330-837-7805 |
| PERRY SCHOOL BUS GARAGE 330-477-1300 | |

UTILITY OWNERSHIP

LISTED BELOW ARE ALL UTILITIES LOCATED WITHIN THE PROJECT LIMITS TOGETHER WITH THEIR RESPECTIVE OWNERS:

| | |
|---|---|
| <u>ELECTRIC</u> OHIO EDISON COMPANY ATTN: KEVIN MCCLUSKY 2600 SOUTH ERIE STREET MASSILLON, OHIO 44646 PHONE: (330) 830-7085 FAX: (330) 830-7054 EMAIL: mcclusky@firstenergycorp.com | <u>CABLE TV</u> MASSILLON CABLE TV, INC. ATTN: JEFFREY L. CAMPBELL P.O. BOX 1000 MASSILLON, OHIO 44648-1000 PHONE: (330) 833-0202 FAX: (330) 833-9775 EMAIL: jlcampbell@massilloncabletv.com |
| <u>GAS</u> DOMINING EAST OHIO ATTN: MARY J. LONG 320 SPRINGSIDE DRIVE SUITE 320 AKRON, OHIO 44333 PHONE: (330) 664-2409 FAX: (888) 504-0126 EMAIL: mary.j.long@dom.com | <u>TELEPHONE</u> AT&T OHIO ATTN: GINO SANTILLO 50 WEST BOWERY STREET 6TH FLOOR AKRON, OHIO 44308 PHONE: (330) 384-2245 EMAIL: ls2671@att.com |
| <u>WATER</u> AQUA OHIO, INC. STARK REGIONAL DIVISION ATTN: DON SNYDER 870 THIRD STREET NW MASSILLON, OHIO 44647-4206 PHONE: (330) 833-4156 FAX: (330) 832-5770 EMAIL: dlsnyder@aquamerica.com | <u>SANITARY</u> CITY OF MASSILLON 151 LINCOLN WAY EAST MASSILLON, OHIO 44646 PHONE: (330) 830-1722 |

THE LOCATION OF THE UNDERGROUND UTILITIES SHOWN ON THE PLANS ARE AS OBTAINED FROM THE OWNERS AS REQUIRED BY SECTION 153.64 O.R.C.

REMOVAL AND RELOCATION OF EXISTING UTILITIES

THE CONTRACTOR IS REQUIRED TO COOPERATE WITH EACH RESPECTIVE UTILITY OWNER FOR THE REMOVAL AND RELOCATION OF ANY AND ALL UTILITIES THAT CREATE A CONFLICT WITH CONSTRUCTION OF THE PROJECT.

LICENSING AND PERMITTING

THE CONTRACTOR IS REQUIRED TO BE LICENSED WITH THE CITY OF MASSILLON ENGINEERING DEPARTMENT AND THE CITY OF MASSILLON INCOME TAX DEPARTMENT. THE CONTRACTOR SHALL ALSO BE RESPONSIBLE FOR OBTAINING ALL APPLICABLE PERMITS.

QUANTITIES

QUANTITIES ARE INDICATED FOR COMPARISON OF BIDS ONLY. IT SHALL BE THE RESPONSIBILITY OF THE CONTRACTOR TO VERIFY QUANTITIES BEFORE ORDERING MATERIALS. VARIATIONS FROM THE PLAN QUANTITIES SHALL BE APPROVED BY THE ENGINEER OR OWNER BEFORE MATERIALS ORDERS ARE PLACED. MATERIALS REJECTED DUE TO INCOMPATIBILITY BETWEEN ORDERED QUANTITIES AND FIELD CONDITIONS SHALL BE REPLACED AT THE CONTRACTOR'S EXPENSE.

MAINTENANCE OF TRAFFIC

THE CONTRACTOR SHALL SUPPLY A MAINTENANCE OF TRAFFIC PLAN TO THE CITY ENGINEER. MAINTENANCE OF TRAFFIC PLAN MUST BE APPROVED BY THE CITY ENGINEER AND TOWNSHIP PRIOR TO ANY CONSTRUCTION. COMMENCING SAID APPROVED DETOUR SHALL BE FORWARDED TO THE LOCAL NEWSPAPER BY THE CONTRACTOR. MATERIALS AND LABOR SHALL BE INCLUDED IN LUMP SUM BID. ALL ABOVE SAID WORK SHALL BE PAID FOR UNDER ITEM 614-MAINTAINING TRAFFIC.

CONTRACTOR AVAILABILITY

THE CONTRACTOR SHALL SUPPLY THE ENGINEER WITH A 24 HOUR PHONE NUMBER WHERE THE CONTRACTOR SHALL BE AVAILABLE FOR EMERGENCIES.

PRESERVATION OF PRIVATE PROPERTY

THE CONTRACTOR SHALL PERFORM WORK AS TO NOT DISTURB, DAMAGE OR DESTROY ANY TELEPHONE OR POWER POLES, SIGNS, LANDSCAPING ITEMS, ETC. ANY ITEM DAMAGED OR DESTROYED SHALL BE REPLACED AT THE CONTRACTOR'S EXPENSE. ANY ITEM DISTURBED OR IN CONFLICT WITH THE WORK TO BE PERFORMED SHALL BE REMOVED AND RESET AT THE CONTRACTOR'S EXPENSE. PRIOR ENGINEER APPROVAL IS REQUIRED BEFORE ANY OF THE ABOVE ITEMS ARE PERFORMED.

CONSTRUCTION SPECIFICATIONS & STANDARDS

ALL CONSTRUCTION TO BE CITY OF MASSILLON SPECIFICATIONS AND STANDARDS, THE LATEST EDITION OF THE STATE OF OHIO DEPARTMENT OF TRANSPORTATION CONSTRUCTION AND MATERIAL SPECIFICATIONS AND FOLLOW ALL OSHA AND ADA REGULATIONS AND REQUIREMENTS, SEDIMENT EROSION STANDARDS.

CONDITIONS OF WORK

ALL WORK PERFORMED UNDER THIS CONTRACT SHALL COMPLY WITH THE U.S. DEPARTMENT OF LABOR, OCCUPATIONAL SAFETY AND HEALTH ACT, STATE, COUNTY AND CITY OF MASSILLON LAWS AND REGULATIONS. ALL WORK, AT ALL TIMES, SHALL BE SUBJECT TO OBSERVATION BY THE OWNER AND/OR ENGINEER. ALL WORK SHALL COMPLY WITH THE CONDITIONS OF THE CONTRACT DOCUMENTS AND OHIO EPA, AND STANDARDS OF THE CITY OF MASSILLON. ALL ELECTRICAL WORK SHALL COMPLY WITH THE NATIONAL ELECTRIC CODE, AND APPLICABLE CITY, COUNTY, STATE AND FEDERAL CODES.

IT SHALL BE THE RESPONSIBILITY OF THE CONTRACTOR TO MAINTAIN SAFE AND SATISFACTORY ACCESS TO ALL ABUTTING PROPERTIES TO THE PROJECT SITE. ADJACENT ROADS SHALL BE MAINTAINED AND KEPT CLEAN OF MUD AND OTHER DEBRIS THAT MAY BE CAUSED BY TRAFFIC EXITING THE WORK SITE. THE CONTRACTOR SHALL COORDINATE AND PROVIDE FOR ALL NECESSARY TRAFFIC CONTROL. TRAFFIC CONTROL SHALL FOLLOW THE MORE STRINGENT GUIDELINES OF THE CITY OF MASSILLON OR ODOT.

CONDITIONS OF WORK (CONTINUED)

IT SHALL BE THE RESPONSIBILITY OF THE CONTRACTOR TO PROVIDE AND MAINTAIN FACILITIES FOR A CONSTRUCTION OFFICE, EMPLOYEE PARKING AND EMPLOYEE SANITARY FACILITIES. ON-STREET PARKING WILL NOT BE PERMITTED. THE CONTRACTOR SHALL PROVIDE FOR THE LAWFUL OFF-SITE DISPOSAL OF DEMOLITION DEBRIS AND CONSTRUCTION WASTE.

PRESERVATION OF PROPERTY CORNERS, SURVEY MARKERS AND MONUMENTS

THE CONTRACTOR SHALL PRESERVE ALL CORNERSTONES, IRON PINS, CONCRETE MONUMENTS AND ANY TYPE OF LAND MONUMENT. HE SHALL HAVE ALL LAND MONUMENTS IN THE PROXIMITY OF THE WORK REFERENCED. HE SHALL REPLACE DESTROYED OR DAMAGED MOUNMENTS AND SHALL FURNISH A CERTIFICATION BY AN OHIO REGISTERED SURVEYOR THAT THE MONUMENTS HAVE BEEN RESTORED.

EXISTING DATA

EACH CONTRACTOR SHALL VISIT THE SITE PERSONALLY TO ASCERTAIN THE NATURE OF THE WORK AND BECOME THOROUGHLY FAMILIARIZED WITH THE SITE PRIOR TO BID SUBMISSION.

EXISTING STRUCTURES, GRADES, PIPING, ETC. ARE INDICATED IN APPROXIMATE LOCATION ON THE PLAN. INFORMATION SHOWN IS NOT GUARANTEED TO BE CORRECT AND COMPLETE. THE DATA SHALL BE VERIFIED IN THE FIELD BY THE CONTRACTOR. THE EXISTENCE OF FACILITIES ABOVE OF BELOW GROUND, WHICH MAY NOT BE SHOWN, WILL NOT BE A BASIS FOR A CLAIM FOR EXTRA WORK.

EXISTING UNDERGROUND UTILITIES SHOWN ARE RECORDS PROVIDED BY UTILITY COMPANIES AND ARE APROXIMATE ONLY. SERVICE LATERALS ARE NOT SHOWN.

IT IS THE RESPONSIBILITY OF CONTRACTOR TO NOTIFY THE CITY, PRIOR TO BID OPENING, NON-CONFORMING OR CONFLICTING INFORMATION.

REMOVAL OF TRAFFIC CONTROL DEVICES AND PRE-CAST STRUCTURES

ALL TRAFFIC CONTROL DEVICES AND PRE-CAST STRUCTURES WITH CASTINGS SHALL BE REMOVED IN A WAY NOT TO DAMAGE. AT THE TIME OF REMOVAL THE INSPECTOR WILL MARK EACH SALVAGABLE STRUCTURE. SAID ITEMS SHALL BE STORED UNTIL THEY CAN BE TRANSPORTED TO ITS RESPECTIVE OWNER BY THE CONTRACTOR. THE CONTRACTOR MUST COORDINATE SAID DELIVERIES WITH MARK LIGHTFOOT AT MASSILLON (330) 833-5746 AND JOHN MASACKO AT PERRY TOWNSHIP (330) 833-2141.

ALL OF THE ABOVE SAID WORK SHALL BE INCLUDED IN PERTINENT 202 ITEM.

FINAL APPROVAL

A VIDEO TAPE WILL BE MADE BY THE CONTRACTOR AND SUBMITTED TO THE CITY PRIOR TO THE PROJECT COMMENCING. AFTER THE FINAL INVOICE IS RECEIVED THE SITE WILL BE VIDEO TAPED AGAIN BY THE CONTRACTOR. ANY DISCREPANCIES WILL BE RESOLVED PRIOR TO FINAL PAYMENT. AS BUILT DRAWING SHALL BE CREATED BY THE CONTRACTOR AND SUBMITTED TO THE CITY IN A CLEAR AND LEGIBLE MANNER PRIOR TO FINAL INVOICE.

COST OF THIS WORK SHALL BE INCLUDED IN ITEM 623-CONSTRUCTION STAKING.

ITEM 623-CONSTRUCTION STAKING

CONTRACTOR IS RESPONSIBLE FOR ALL CONSTRUCTION LAYOUT AND AS-BUILT DRAWINGS. THIS WORK IS TO BE PERFORMED UNDER ITEM 623 CONSTRUCTION STAKING.

CURB RAMPS

SURFACE TEXTURE

TEXTURE OF CONCRETE SURFACES SHALL BE OBTAINED BY COARSE BROOMING TRANSVERSE TO THE RAMP SLOPES AND SHALL BE ROUGHER THAN THE ADJACENT WALK.

TRUNCATED DOMES

INSTALL DETECTABLE WARNINGS (TRUNCATED DOMES) FOR A DISTANCE OF 24" FROM THE BACK OF CURB FOR THE ENTIRE WIDTH OF THE RAMP OPENING.

PAVERS WILL MEET ASTM C 902 CLASS SX, TYPE 1, OR C 936, OR C1272 TYPE R.

ACCEPTABLE MANUFACTURERS AND PRODUCTS ARE AS FOLLOWS:

- 1.) WHITACRE-GREER FIREPROOFING COMPANY
1400 SOUTH MAHONING AVE.
ALLIANCE, OH 44601
1-800-WG PAVER
ADA PAVER, 4"x8"x2- 1/4" CLEAR RED, RUSTIC, #30
- 2.) HANOVER ARCHITECTURAL PRODUCTS
240 BENDER ROAD
HANOVER, PA 17331
(717) 637-0500
DETECTABLE WARNING PAVER, 12"x12"x2" OR 24"x24"x2", RED OR QUARRY RED
- 3.) ENDICOTT CLAY PRODUCTS
P.O. BOX 17
FAIRBURY, NE 68352
(402) 729-5804
HANDICAP DETECTABLE WARNING PAVER, 4"x8"x2-1/4", RED BLEND

PAVERS WILL BE LAID ON TOP OF A 4" UNREINFORCED CONCRETE BASE. SETTING BED AND JOINTS TO BE MORTARED IN ACCORDANCE WITH MANUFACTURER'S INSTRUCTION, OR WITH A MAXIMUM 1/2" THICK BED OF LATEX MODIFIED CEMENT MORTAR. MORTAR JOINTS TO A WIDTH NOT GREATER THAN 3/32" AND NOT LESS THAN 1/16". PAVERS SHALL NOT BE DIRECTLY TOUCHING EACH OTHER UNLESS THEY HAVE SPACING BARS.

MORTARED JOINTS ARE TO BE FLUSH WITH TOP SURFACE AND STRUCK SO AS TO GIVE A SMOOTH SURFACE. PAVERS SHALL BE LAID SUCH THAT JOINTS ARE LEVEL WITH ADJOINING JOINTS SO AS TO PROVIDE A SMOOTH TRANSITION FROM BRICK TO BRICK AND BRICK TO CONCRETE SURFACE.

THE SURFACE OF ANY TWO ADJACENT UNITS SHOULD NOT DIFFER BY MORE THAN 1/8" IN HEIGHT. BRICKS SHALL BE PLACED IN A RUNNING BOND PATTERN. FACE OF ALL BRICK SHALL BE CLEAN OF CEMENT AND PROTECTED SO AS TO AVOID CHIPPING DURING CONSTRUCTION.

EXPANSION JOINTS

SHALL BE PROVIDED IN THE CURB RAMP AS EXTENSIONS OF WALK JOINTS AND CONSISTENT WITH ITEM 608.03 REQUIREMENTS FOR A NEW CONCRETE WALK. A 1/2" ITEM 705.03 EXPANSION JOINT FILLER SHALL BE PROVIDED AROUND THE EDGE OF RAMPS BUILT IN EXISTING CONCRETE WALK. LINES SHOWN ON THIS DRAWING INDICATE THE RAMP EDGE AND SLOPE CHANGES AND ARE NOT NECESSARILY JOINT LINES.

RELIEF JOINTS

MUST BE PROVIDED AT ALL POINTS OF CONTINUOUS SLOPE CHANGES IN CURB TYPE A AND TYPE C.

PAYMENT
ITEM 608-CURB RAMP, SQ. FT., SHALL INCLUDE THE COST OF FURNISHING AND INSTALLING ALL MATERIALS (INCLUDING TRUNCATED DOMES), GRADING, FORMING AND FINISHING OF THE CURB AND WALK OF THE CURB RAMP AND REMOVAL OF ANY EXISTING MATERIAL TO PERFORM SUCH WORK.

GENERAL NOTES

2ND STREET MID-BLOCK PEDESTRIAN CROSSWALK
FOR: MASSILLON PUBLIC LIBRARY
LOCATED IN THE CITY OF MASSILLON,
STARK COUNTY, OHIO

2
3

DESIGN BY: JMK
DRAWN BY: JMK
CHECKED BY: WLC
REVIEWED BY: WLC
DATE:

FIELD BOOK
BK PG:
CRW CHF:
COPYRIGHT: 2011

SCALES
HORIZ:
VERT:
CONTOUR INT:

REV. BY: _____
REV. BY: _____
REV. BY: _____
DESC: _____
DESC: _____
DESC: _____
DESC: _____

DATE: _____
DATE: _____
DATE: _____
DATE: _____

DOCUMENTS AND SETTINGS
C:\DOCUMENTS AND SETTINGS\JMK\DESIGN\WALKS\BTS.DWG

@HAMMONTREE & ASSOCIATES, LTD.
ENGINEERS, PLANNERS, SURVEYORS
CANTON-AKRON-PITTSBURGH
5233 STONEHAM ROAD NORTH CANTON, OHIO 44720
CANTON: (330)499-8817 AKRON:(330)633-7274
TOLL FREE: 1-800-394-8817 FAX: (330)499-0149
www.hammontree-engineers.com

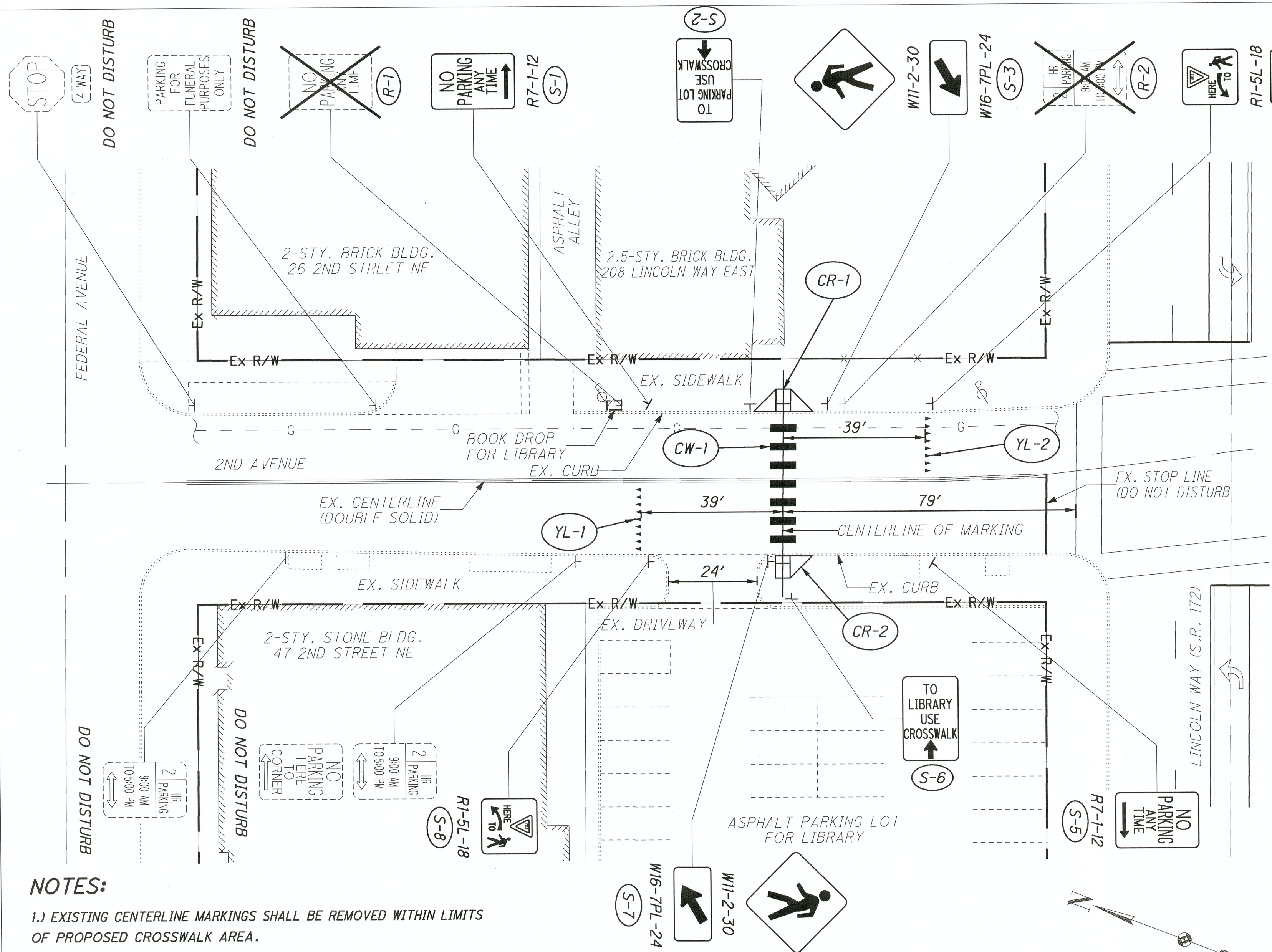

NOTES:

- 1.) EXISTING CENTERLINE MARKINGS SHALL BE REMOVED WITHIN LIMITS OF PROPOSED CROSSWALK AREA.
- 2.) PROPOSED CURB RAMPS SHALL BE CONSTRUCTED ALONG CENTERLINE OF PROPOSED CROSSWALK MARKINGS.
- 3.) CROSSWALK LINE, TYPE 1 SHALL BE 7 FEET IN WIDTH AND THE GAP BETWEEN THE TRANSVERSE LINES SHALL NOT BE LESS THAN 6 FEET.
- 4.) THE GRADES OF THE CURB RAMPS SHALL BE CONSTRUCTED WITHIN TOLERANCES OF THE STANDARD DRAWING AND SHALL BE KEPT WITHIN LIMITS OF ACTUAL CURB RAMP.
- 5.) THE LOCATION OF EXISTING TOPOGRAPHIC ITEMS AND UTILITIES ARE APPROXIMATE. FIELD SURVEYING WAS NOT PERFORMED FOR THIS PROJECT.

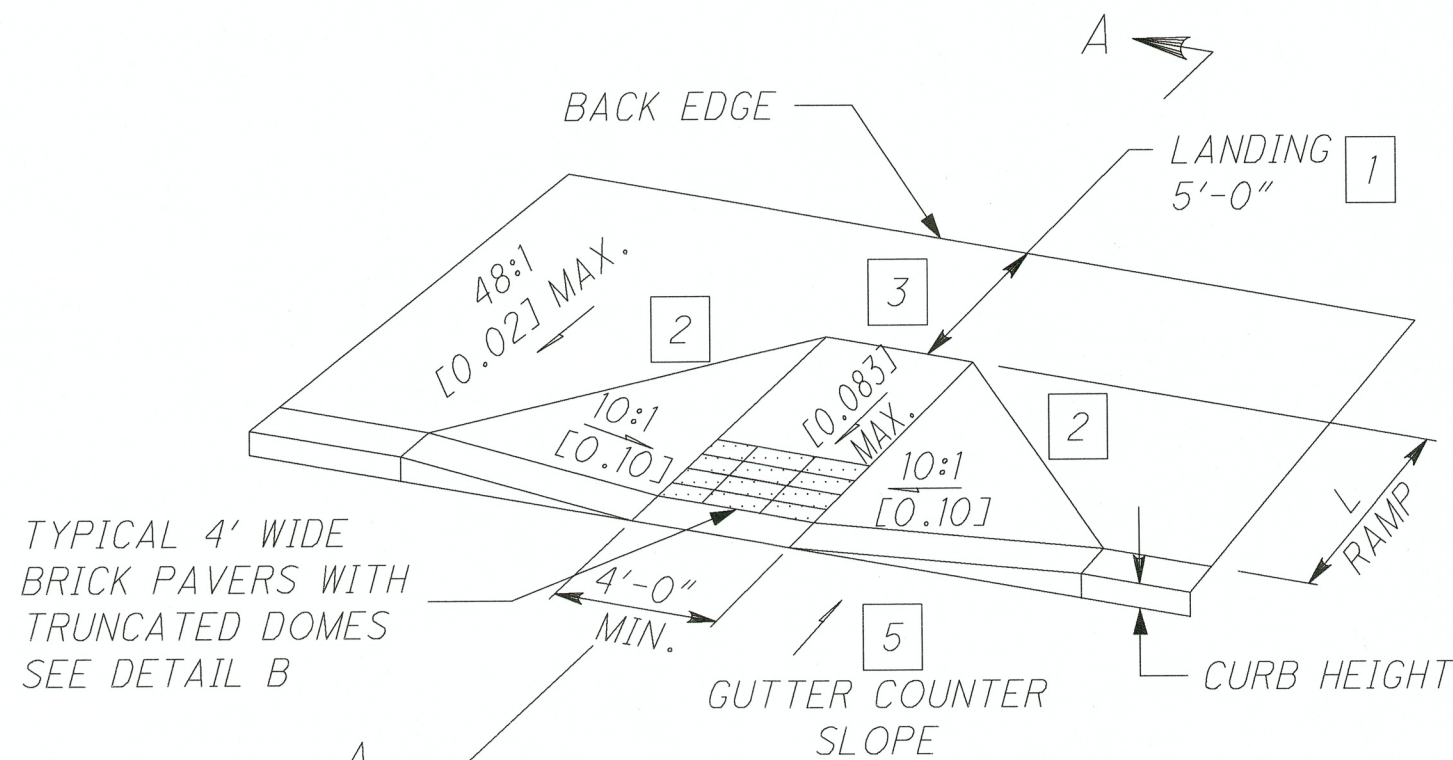

CURB RAMP TYPE A

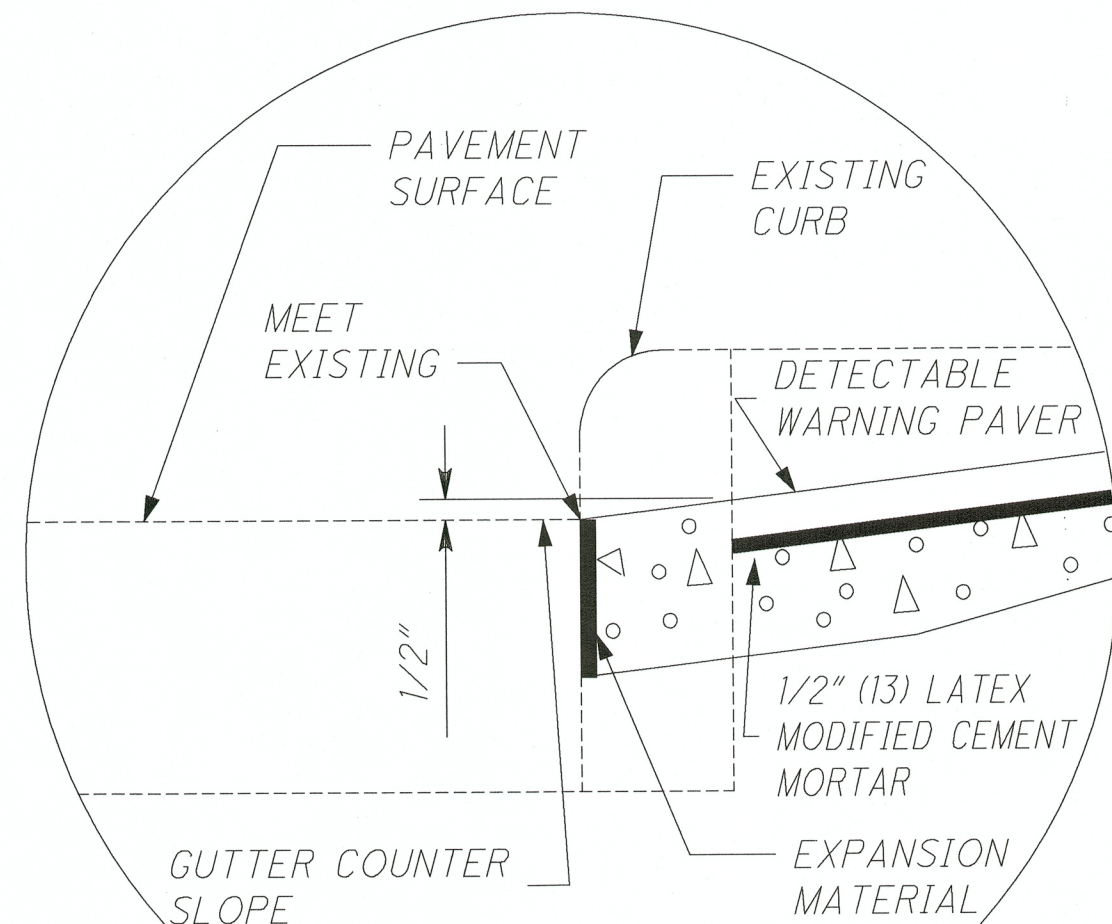

DETAIL A

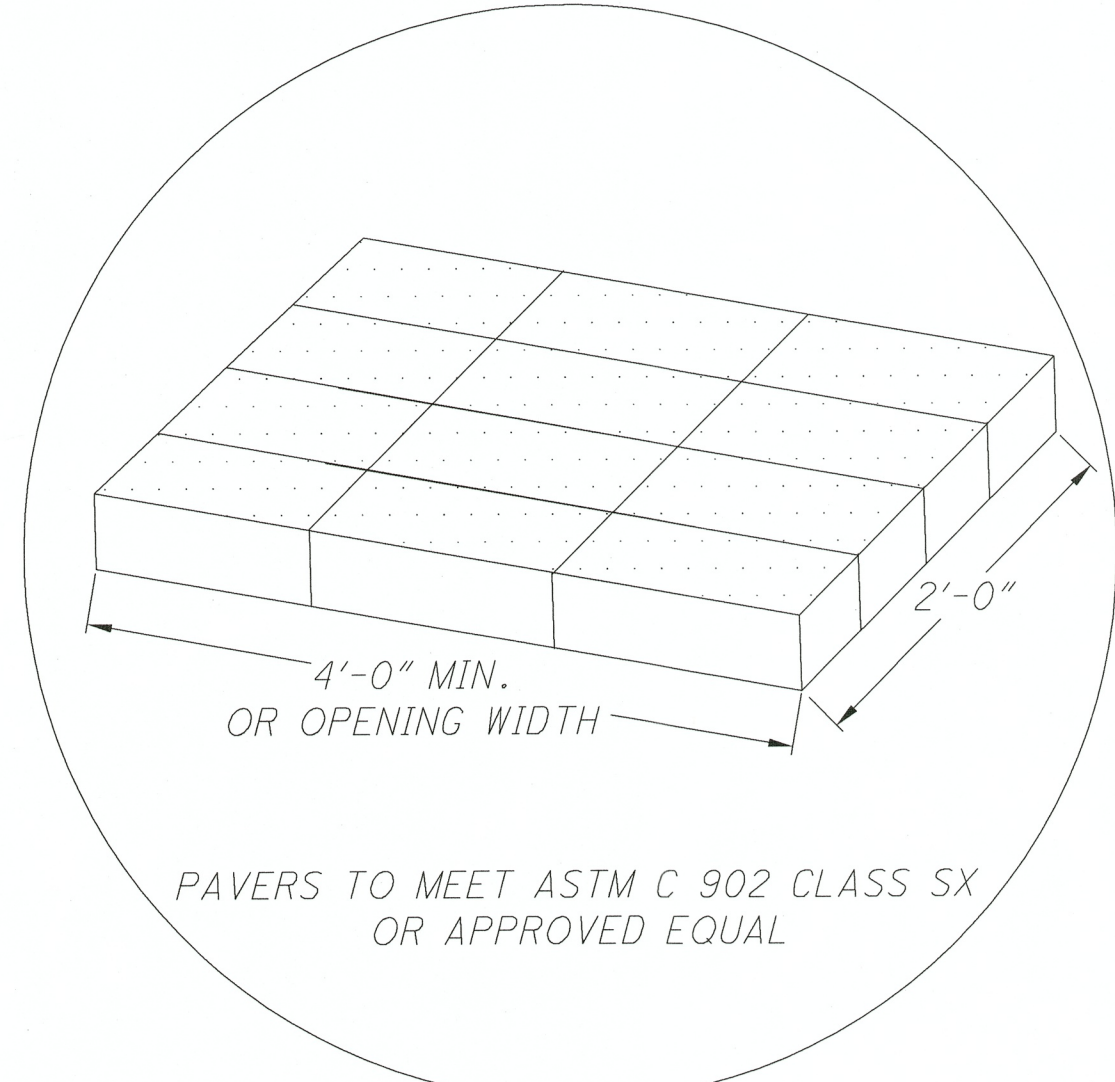

DETAIL B

| SIGNING ESTIMATED QUANTITIES | | | | | | |
|------------------------------|------|------------|---------------|------------------|------------------------------------|---|
| REFERENCE NO. | SIDE | CODE | SIZE (INCHES) | 630 | 630 | 630 |
| | | | | SIGN, FLAT SHEET | GROUND MOUNTED SUPPORT, NO. 3 POST | REMOVAL OF GROUND MOUNTED SIGN AND DISPOSAL |
| | | | | SQ. FT. | FT. | EACH |
| S-1 | RT. | R7-1-12 | 12" X 18" | 1.5 | 12 | |
| S-2 | RT. | SPECIAL | 12" X 18" | 1.5 | 12 | |
| S-3 | RT. | W11-2-30 | 30" X 30" | 6.3 | 15 | |
| | | W16-7PL-24 | 24" X 12" | 2.0 | | |
| S-4 | RT. | R1-5L-18 | 18" X 18" | 2.3 | 12 | |
| S-5 | LT. | R7-1-12 | 12" X 18" | 1.5 | 12 | |
| S-6 | LT. | SPECIAL | 12" X 18" | 1.5 | 12 | |
| S-7 | LT. | W11-2-30 | 30" X 30" | 6.3 | 15 | |
| | | W16-7PL-24 | 24" X 12" | 2.0 | | |
| S-8 | LT. | R1-5L-18 | 18" X 18" | 2.3 | 12 | |
| R-1 | RT. | | | | | 1 |
| R-2 | RT. | | | | | 1 |
| TOTAL | | | | 28 | 102 | 2 |

| PAVEMENT MARKINGS ESTIMATED QUANTITIES | | | |
|--|---------|------------------------|------------|
| REFERENCE NO. | SIDE | 642 | 642 |
| | | CROSSWALK LINE, TYPE 1 | YIELD LINE |
| | | FT. | FT. |
| CW-1 | LT./RT. | 49 | |
| YL-1 | LT. | | 20 |
| YL-2 | RT. | | 20 |
| TOTAL | | 49 | 40 |

| ROADWAY ESTIMATED QUANTITIES | | | | |
|------------------------------|------|--------------------|---------------------|----------------------------|
| REFERENCE NO. | SIDE | 608 | 614 | 623 |
| | | CURB RAMP, TYPE A1 | MAINTAINING TRAFFIC | CONSTRUCTION LAYOUT STAKES |
| | | SQ. FT. | LUMP | LUMP |
| CR-1 | RT. | 60 | | |
| CR-2 | LT. | 42 | | |
| | | | LUMP | |
| | | | | LUMP |
| TOTAL | | 102 | LUMP | LUMP |

LEGEND

- 1 THE ENGINEER MAY PERMIT NO LESS THAN 3'-0" IN EXISTING SIDEWALKS IF THE LANDING IS UNCONSTRAINED ALONG THE BACK EDGE.
- 2 WHERE LANDING WIDTH HAS BEEN REDUCED TO 3'-0" THE FLARED SIDES SHALL HAVE A MAXIMUM SLOPE OF 12:1 [0.083].
- 3 THE MAX. SLOPE OF THE RAMP TOWARD THE CURB IS 12:1 [0.083] AS RELATED TO THE HORIZONTAL, BUT RELATIVE TO THE EXISTING OR PROPOSED WALK SLOPE. THE ENGINEER MAY ALLOW THE FOLLOWING IN HISTORICAL AREAS:
A) 10:1 [0.10] FOR A MAX. RISE OF 6"
B) 8:1 [0.125] FOR A MAX. RISE OF 3"
C) 6:1 [0.167] OVER A MAX. RUN OF 2'-0" FOR HISTORICAL AREAS WHERE A FLATTER SLOPE IS NOT FEASIBLE
- 4 THE MINIMUM LENGTH OF A TYPE A OR B RAMP IS 6' FROM THE BACK OF A 6" CURB AND MAY BE INCREASED WHERE FEASIBLE TO OBTAIN A FLATTER RAMP SLOPE OR TO BETTER BLEND WITH THE WALK CONFIGURATION.
- 5 GUTTER COUNTER SLOPES AT THE FOOT OF PERPENDICULAR CURB RAMPS SHOULD NOT EXCEED 20:1 [0.05] OVER A DISTANCE OF 2'-0" FROM THE CURB.