

**GENERAL NOTES:**

- A. ALL EXISTING UTILITIES, TOPOGRAPHY AND PROPERTY INFORMATION ARE TAKEN FROM A SURVEY OF LAND SITUATED IN THE CITY OF MASSILLON, COUNTY OF STARK, STATE OF OHIO, BY SURVEYOR: ms consultants, inc., 2221 SCHROCK ROAD, COLUMBUS, OHIO 43229.
- B. BY GRAPHICAL PLOTTING ONLY, THIS SITE IS SITUATED IN FEMA FLOOD ZONE X PER FIRM #39151C10194E, EFFECTIVE SEPTEMBER 29, 2011.
- C. CONTRACTOR IS RESPONSIBLE FOR LOCATING AND VERIFYING ALL EXISTING UNDERGROUND UTILITIES PRIOR TO CONSTRUCTION, AND IS RESPONSIBLE FOR ANY DAMAGE TO THEM DURING CONSTRUCTION.
- D. PROVIDE SMOOTH TRANSITION FROM NEWLY PAVED AREAS TO EXISTING PAVED AREAS AS NECESSARY. THE EXISTING EDGE OF PAVEMENT SHALL BE FREE OF ALL LOOSE DEBRIS AT ALL AREAS WHERE PROPOSED PAVEMENT MEETS EXISTING PAVEMENT. THE EDGE OF EXISTING CONCRETE PAVEMENT SHALL BE PROPERLY SEALED WITH A TACK COAT MATERIAL IN ALL AREAS WHERE NEW CONCRETE PAVEMENT IS INDICATED TO JOIN EXISTING.
- E. ALL DIMENSIONS TO FACE OF CURB UNLESS OTHERWISE NOTED.
- F. ALL PAVEMENT MARKINGS DEPICTING PARKING SPACES, ACCESSIBLE PARKING SPACES, BARRIER FREE SYMBOLS, ACCESS AISLES, NO PARKING SIGNAGE, RESTRICTED PARKING AREAS, DRIVE LINES, VEHICULAR DIRECTION ARROWS AND STOP BARS SHALL BE APPLIED WITH MECHANICAL EQUIPMENT AND TEMPLATES AT THE LOCATIONS AND LENGTHS SHOWN ON THE PLANS (TWO COATS ALL LOCATIONS). PAINT SHALL BE WHITE IN COLOR (UNLESS OTHERWISE SPECIFIED) AND SHALL MEET ALL APPLICABLE REQUIREMENTS OF LOCAL, STATE, AND FEDERAL REQUIREMENTS.
- G. CONTRACTOR SHALL BE SOLELY RESPONSIBLE FOR AND TAKE ALL PRECAUTIONS NECESSARY TO AVOID DAMAGE TO ADJACENT PROPERTIES DURING THE CONSTRUCTION PHASES OF THIS PROJECT.
- H. REFER TO ARCHITECTURAL DRAWINGS FOR BUILDING DIMENSIONS AND ADDITIONAL INFORMATION.
- I. ALL CONSTRUCTION METHODS AND MATERIALS MUST CONFORM TO CURRENT STANDARDS AND SPECIFICATIONS OF THE FEDERAL, STATE, COUNTY, CITY OR LOCAL REQUIREMENTS, WHICHEVER HAS JURISDICTION.
- J. ALL EXCAVATED AREAS TO BE SEEDDED AND/OR SODDED AFTER FINISH GRADING UNLESS OTHERWISE NOTED. ALL NEWLY SEEDDED/SODDED AREAS SHALL HAVE A MINIMUM OF 4" OF TOPSOIL. HOLD SOIL DOWN 1" FROM PAVEMENT ELEVATION. CONTRACTOR TO SUPPLY STRAW MULCH WHERE GRASS SEED HAS BEEN PLANTED.
- K. ALL RADII ARE 5.0 FEET UNLESS OTHERWISE SHOWN. ALL RADII INDICATED ON PLANS SHALL BE CONSTRUCTED AS CIRCULAR ARCS.
- L. PROPOSED BUILDING AND PARKING ARE PARALLEL AND PERPENDICULAR TO THE EASTERN PROPERTY LINE HAVING THE BEARING N 03° 13' 24" E AND DISTANCE OF 383.98'.

**KEYED NOTES:**

- 1 PROPOSED STANDARD DUTY ASPHALT PAVEMENT. SEE DETAIL ON SHEET C-106.
- 2 PROPOSED HEAVY DUTY ASPHALT PAVEMENT. SEE DETAIL ON SHEET C-106.
- 3 PROPOSED ASPHALT PAVEMENT TO BE FLUSH WITH EXISTING.
- 4 PROPOSED ACCESS ROAD PAVEMENT PER CITY OF MASSILLON REQUIREMENTS. SEE CROSS SECTION FOR PRIVATE ROAD DETAIL ON SHEET C-106.
- 5 PROPOSED CONCRETE LOADING DOCK. SEE ARCHITECTURAL AND STRUCTURAL PLANS FOR DETAILS.
- 6 PROPOSED CONCRETE TO BE FLUSH WITH ADJACENT ASPHALT PAVEMENT.
- 7 PROPOSED CONCRETE SIDEWALK. SEE STRUCTURAL PLANS FOR DETAILS.
- 8 PROPOSED 6" CONCRETE CURB PER ODOT ROADWAY STANDARD CONSTRUCTION DRAWING BP-5.1 ITEM 609 TYPE 6.
- 9 TAPER LAST 10' OF NEW CURB TO MEET AND MATCH CONFIGURATION AND ELEVATION OF EXISTING ADJOINING CURB.
- 10 EXISTING CONCRETE CURB TO REMAIN.
- 11 PROPOSED PAINTED "NO PARKING" MARKINGS. SEE DETAIL ON SHEET C-106.
- 12 PROPOSED PAINTED PARKING STRIPING (TYPICAL). ALL PARKING STRIPES ARE TO BE 4" PAINTED WHITE, UNLESS OTHERWISE NOTED ON THE PLANS, DETAILS OR SPECIFICATIONS.
- 13 PROPOSED PAINTED HANDICAP PARKING SYMBOL (TYP. OF 4). SEE DETAILS ON SHEET C-106.
- 14 PROPOSED PAINTED "YIELD" MARKINGS PER MANUAL ON UNIFORM TRAFFIC CONTROL DEVICES SECTION 3B.20.
- 15 GENERAL CONTRACTOR TO PROVIDE AND INSTALL (3) POLE-MOUNTED "VAN ACCESSIBLE" HANDICAP PARKING SIGNS. SIGNS PROVIDED BY CONTRACTOR SHALL MEET LOCAL REQUIREMENTS. SEE DETAIL ON SHEET C-106.
- 16 GENERAL CONTRACTOR TO PROVIDE AND INSTALL (1) POLE-MOUNTED HANDICAP PARKING SIGNS. SIGNS PROVIDED BY CONTRACTOR SHALL MEET LOCAL REQUIREMENTS. SEE DETAIL ON SHEET C-106.
- 17 PROPOSED BOLLARD (TYP. OF 16). SEE STRUCTURAL AND ARCHITECTURAL PLANS FOR DETAILS.
- 18 PROPOSED LIGHT POLE. SEE SHEET C-106 FOR BASE DETAIL. SEE ARCHITECTURAL, STRUCTURAL, AND ELECTRICAL PLANS FOR ADDITIONAL DETAILS.
- 19 PROPOSED DUMPSTER. SEE ARCHITECTURAL PLANS FOR DETAILS.
- 20 EXISTING MENARDS SITE SIGN TO REMAIN. PROPOSED ALDI SIGN TO BE ADDED TO PYLON. CONTRACTOR TO COORDINATE WITH OWNER. SEE ELECTRICAL PLANS FOR DETAILS.
- 21 PROPOSED 6" CONCRETE CURB AND GUTTER PER ODOT ROADWAY STANDARD CONSTRUCTION DRAWING BP-5.1 ITEM 609 TYPE 2. MATCH EXISTING ADJACENT CURB SECTIONS.
- 22 GENERAL CONTRACTOR TO PROVIDE AND INSTALL ONE (1) POLE MOUNTED "STOP" SIGN PER ODOT ITEM 630.
- 23 PROPOSED PAINTED 24" WIDE STOP BAR, 18 FT. IN LENGTH PER ODOT ITEM 641.
- 24 PROPOSED GUARDRAIL PER ODOT ITEM 606.

## LEGEND

FEATURE	DESCRIPTION	
	CONCRETE	
	STANDARD DUTY ASPHALT PAVEMENT	
	HEAVY DUTY ASPHALT PAVEMENT	
	ACCESS ROAD PAVEMENT	
	GRASS / LANDSCAPED AREA	
	FULL-DEPTH SAWCUT LINE	
	CONSTRUCTION LIMITS	
	BUILDING SETBACK LINE	
EXISTING	PROPOSED	
		SANITARY STRUCTURE
		STORM STRUCTURE
		WATER VALVE
		FIRE HYDRANT
		ELECTRICAL STRUCTURE
		LIGHT POLE
		UTILITY POLE
		GUY WIRE
		GAS STRUCTURE
		SHRUBBERY

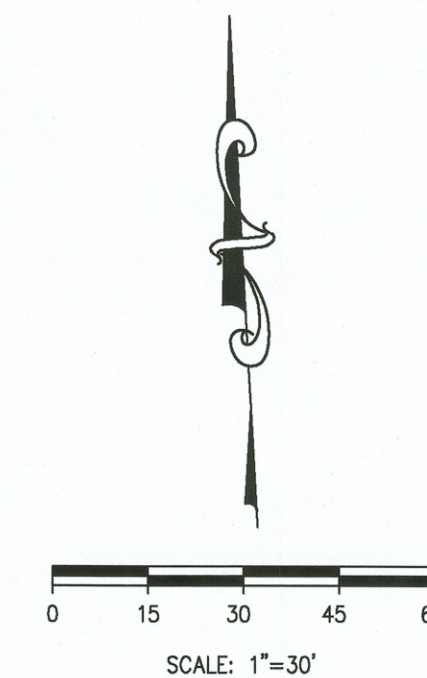
[illegible]

DO NOT SCALE PLANS

Copying, Printing, Software and other processes required to produce these prints can stretch or shrink the actual paper or layout. Therefore, scaling of this drawing may be inaccurate. Contact ms consultants with any need for additional dimensions or clarifications.

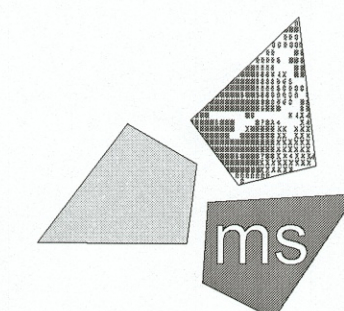

**ms consultants, inc.**  
engineers, architects, planners  
2221 Schrock Road  
Columbus, Ohio 43229-1547  
phone 614.898.7100  
fax 614.898.7570

DRAWN BY: KEA

REVIEWED BY: IA

Seal

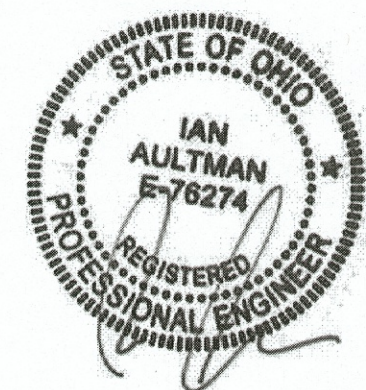

PROFESSIONAL OF RECORD:  
IAN AULTMAN No. E-76274  
EXP. DATE: 12/31/19

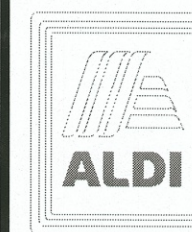

**ALDI Inc.**  
1319 W. 130th Street  
Hinckley, OH 44233  
(330) 273-7351  
(330) 273-7352 fax

ALDI Inc. Store #: 76  
Massillon, OH  
Erie Street South  
Massillon, Ohio 44646  
Stark County  
Project Name & Location:

## Site Plan

Drawing Name:	
Prototype Rls. 07/27/18	Project No.
Type: LHRD-V7ER	40192-93
	C-105
Scale: As Noted	Drawing No.



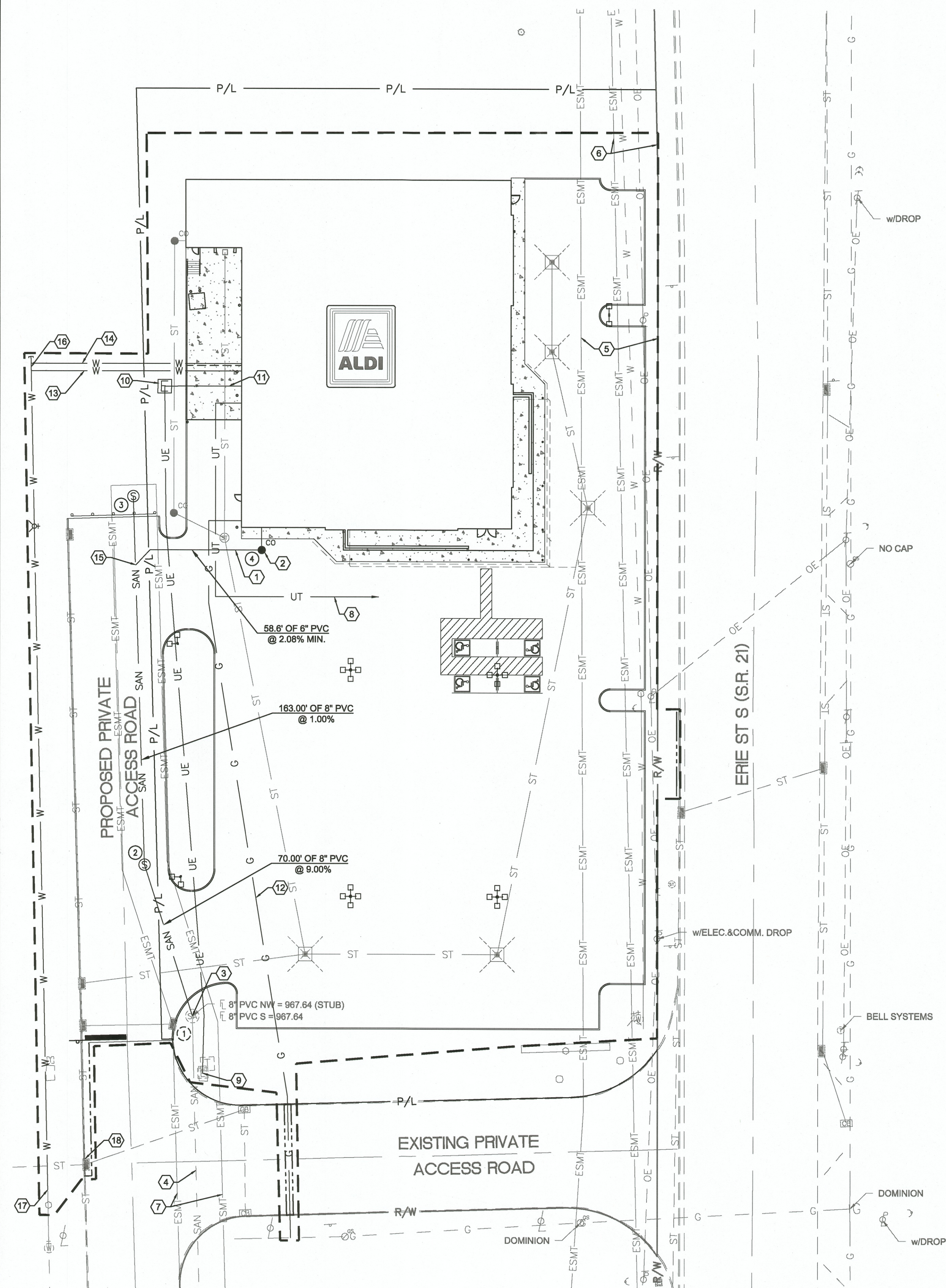

**GENERAL NOTES:**

- A. ALL EXISTING UTILITIES, TOPOGRAPHY, UTILITIES AND PROPERTY INFORMATION ARE TAKEN FROM A SURVEY OF LAND SITUATED IN THE CITY OF HILLIARD, COUNTY OF FRANKLIN, STATE OF OHIO, BY SURVEYOR: ms consultants, inc, 2221 SCHROCK ROAD, COLUMBUS, OHIO 43229.
- B. ALL CONSTRUCTION METHODS AND MATERIAL MUST CONFORM TO CURRENT STANDARDS AND SPECIFICATIONS OF THE FEDERAL, STATE, COUNTY, CITY OR LOCAL REQUIREMENTS, WHICHEVER HAS JURISDICTION.
- C. ALL EXISTING UTILITIES, ARE TAKEN FROM SURVEY AND DO NOT NECESSARILY REPRESENT ALL UNDERGROUND UTILITIES ADJACENT TO OR UPON PREMISES SHOWN ON PLAN.
- D. CONTRACTOR IS RESPONSIBLE FOR LOCATING AND VERIFYING ALL EXISTING UNDERGROUND UTILITIES PRIOR TO CONSTRUCTION. PROPOSED UTILITIES SHOULD TIE INTO EXISTING UTILITIES AT A POINT INDICATED ON PLANS.
- E. THE CONTRACTOR SHALL NOTIFY ALL UTILITY COMPANIES 48 HOURS BEFORE CONSTRUCTION IS TO START, TO VERIFY IF ANY UTILITIES ARE PRESENT ON SITE. ALL VERIFICATIONS (LOCATION, SIZE AND DEPTH) SHALL BE MADE BY THE APPROPRIATE UTILITY COMPANIES. WHEN EXCAVATION IS AROUND OR OVER EXISTING UTILITIES, THE CONTRACTOR MUST NOTIFY THE UTILITY SO A REPRESENTATIVE OF THAT UTILITY COMPANY CAN BE PRESENT TO INSTRUCT AND OBSERVE DURING CONSTRUCTION.
- F. CONTRACTOR IS RESPONSIBLE FOR ANY DAMAGE TO THE EXISTING UTILITIES DURING CONSTRUCTION AND ALL DAMAGE SHALL BE REPAIRED TO ORIGINAL CONDITION AT NO ADDITIONAL COST TO THE OWNER OR CITY.
- G. THE EXCAVATING CONTRACTOR MUST TAKE PARTICULAR CARE WHEN EXCAVATING IN AND AROUND EXISTING UTILITY LINES AND EQUIPMENT. VERIFY COVER REQUIREMENTS BY UTILITY CONTRACTORS AND/OR UTILITY COMPANIES SO AS TO NOT CAUSE DAMAGE.
- H. STORM SEWER SHOWN HERE FOR REFERENCE ONLY. SEE SHEET GRADING PLAN ON SHEET C-108.
- I. CONTRACTOR TO VERIFY ELEVATIONS OF EXISTING SANITARY SEWER PRIOR TO CONSTRUCTION AND NOTIFY OWNER AND ENGINEER 3 DAYS PRIOR TO CONSTRUCTION.
- J. CONTRACTOR SHALL MAINTAIN A MINIMUM COVER OF 4' OVER PROPOSED WATER SERVICE.
- K. THERE SHALL BE A MINIMUM TEN-FOOT HORIZONTAL SEPARATION BETWEEN WATER TAPS, WATER SERVICES, PRIVATE WATER SYSTEMS, AND ANY SANITARY AND/OR STORM SEWER SYSTEMS. WHERE 10-FOOT HORIZONTAL SEPARATION CANNOT BE OBTAINED, THE BOTTOM OF THE WATER LINE SHALL BE AT LEAST 18 INCHES ABOVE THE TOP OF THE SEWER.
- L. SEE PLUMBING PLANS FOR CONTINUATION OF UTILITY LINES INTO BUILDING.
- M. CONTRACTOR SHALL INSTALL AND BACKFILL ALL UTILITY PIPES, CONDUITS, STRUCTURES, AND TRENCHES PER DETAIL ON SHEET C-110.

**KEYED NOTES:**

- 1 PROPOSED 6" P.V.C. SANITARY SEWER. ASTM F-794, SDR-26. SEWER TO HAVE MINIMUM SLOPE OF 2.08%.
- 2 PROPOSED SANITARY CLEANOUT (TYP.). SEE DETAIL ON SHEET C-110.
- 3 PROPOSED 8" SANITARY TO CONNECT TO EXISTING MANHOLE. CORE INTO EXISTING STRUCTURE.
- 4 EXISTING 8" SANITARY SEWER MAIN.
- 5 EXISTING 30' ELECTRICAL EASEMENT.
- 6 EXISTING 10' WATER EASEMENT.
- 7 EXISTING 10' SANITARY EASEMENT.
- 8 PROPOSED UNDERGROUND TELEPHONE SERVICE. CONTRACTOR TO COORDINATE WITH UTILITY OWNER.
- 9 CONNECT TO EXISTING ELECTRICAL STRUCTURES. CONTRACTOR TO COORDINATE WITH UTILITY OWNER.
- 10 PROPOSED ELECTRIC TRANSFORMER. CONTRACTOR TO COORDINATE LOCATION AND CONNECTION WITH UTILITY OWNER.
- 11 PROPOSED ELECTRICAL SERVICE. CONTRACTOR TO COORDINATE CONDUIT SIZE, NUMBER OF CONDUITS, CONNECTIONS, AND BEND RADII WITH UTILITY OWNER AND MEP PLANS. CONTRACTOR TO COORDINATE CONNECTION TO TRANSFORMER WITH UTILITY OWNER.
- 12 PROPOSED 2" GAS LINE FOR ANTICIPATED NG LOAD OF 905 MBH AT 10" W.C., CONFIRM AND COORDINATE WITH MEP PLANS. ALL MATERIALS AND INSTALLATION ARE TO BE IN ACCORDANCE WITH ALL STATE AND LOCAL CODES. CONTRACTOR TO COORDINATE LOCATION OF GAS MAIN AND CONNECTION CONNECTION WITH UTILITY OWNER.
- 13 PROPOSED 6" DUCTILE IRON FIRE SERVICE LINE. INCLUDE IN BASE BID ALL VALVES, PIPING, STRUCTURES, ETC. THAT WILL BE REQUIRED.
- 14 PROPOSED 2" TYPE K COPPER DOMESTIC SERVICE LINE. INCLUDE IN BASE BID ALL VALVES, PIPING, STRUCTURES, ETC. THAT WILL BE REQUIRED.
- 15 PROPOSED 8X8 WYE WITH RISER CONNECTION.
- 16 PROPOSED 10" DUCTILE IRON WATER LINE. INCLUDE IN BASE BID ALL VALVES, PIPING, STRUCTURES, ETC. THAT WILL BE REQUIRED.
- 17 CONNECT TO EXISTING 10" WATER LINE. CONTRACTOR TO COORDINATE LOCATION AND CONNECTION WITH UTILITY OWNER.
- 18 CORE DRILL EXISTING PRECAST CATCH BASIN AND CONNECT NEW STORM SEWER PIPE TO INLET WITH A CONCRETE COLLAR.

## SANITARY STRUCTURE DATA

- ① EXISTING MANHOLE  
TC: 983.85  
EX: 8" (NW,S) = 967.64
- ② PROPOSED MANHOLE  
TC: 985.27  
PR: 8" (N,S) = 973.94
- ③ PROPOSED MANHOLE  
TC: 986.50  
PR: 8" (S) = 975.57
- ④ PROPOSED CLEANOUT  
TC: 989.25  
PR: 6" (N,W) = 984.79

[illegible]

DO NOT SCALE PLANS

Copying, Printing, Software and other processes required to produce these prints can stretch or shrink the actual paper or layout. Therefore, scaling of this drawing may be inaccurate. Contact ms consultants with any need for additional dimensions or clarifications.

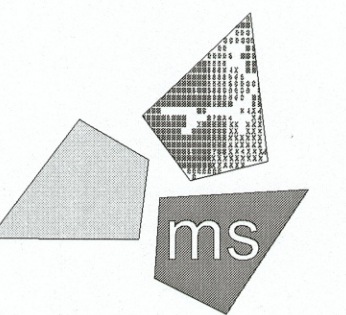

**ms consultants, inc.**  
engineers, architects, planners  
2221 Schrock Road  
Columbus, Ohio 43229-1547  
phone 614.898.7100  
fax 614.898.7570

DRAWN BY: KEA

REVIEWED BY: IA

Seal



PROFESSIONAL OF RECORD:  
IAN AULTMAN No. E-76274  
EXP. DATE: 12/31/19

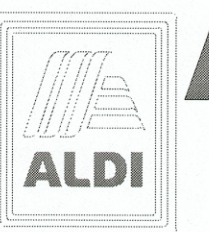

**ALDI Inc.**  
1319 W. 130th Street  
Hinckley, OH 44233  
(330) 273-7351  
(330) 273-7352 fax

ALDI Inc.      Store #: 76  
Massillon, OH  
Erie Street South  
Massillon, Ohio 44646  
Stark County  
Project Name & Location:

## Utility Plan

Drawing Name:

Prototype Rls.	07/27/18
----------------	----------

Project No.

40192-93

Type:LHRD-V7ER

C-109

Scale: As Noted

Drawing No.

