

EXCEL LEGEND

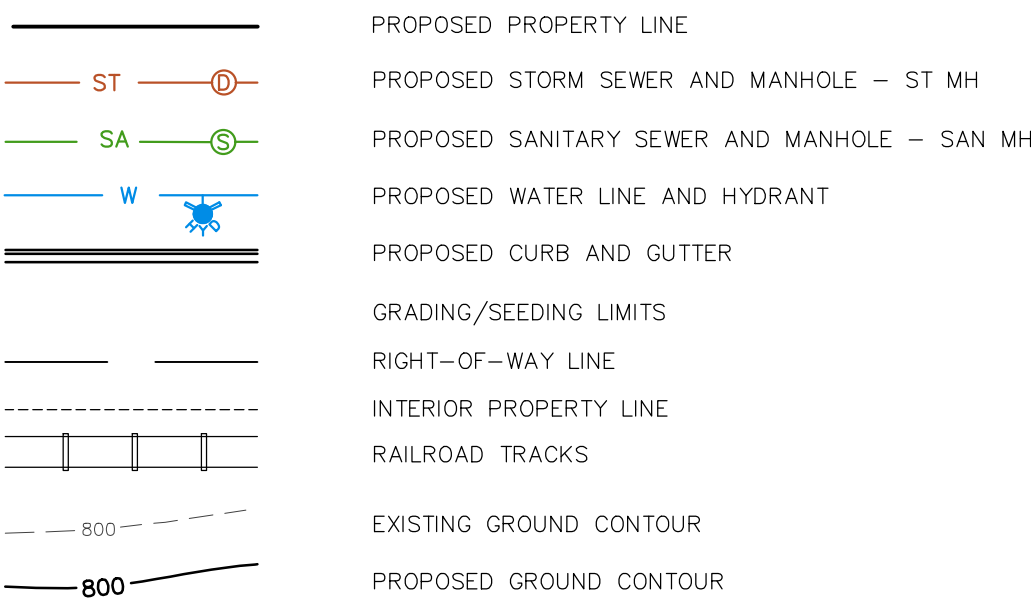

CIVIL SHEET INDEX

SHEET	SHEET TITLE
C0.1	CIVIL COVER AND SPECIFICATION SHEET
C1.0	EXISTING SITE AND DEMOLITION PLAN
C1.1	SITE PLAN
C1.2	GRADING AND EROSION CONTROL PLAN
C1.3	UTILITY PLAN
C1.4	LANDSCAPE AND RESTORATION PLAN
C2.0	DETAILS
C2.1	DETAILS
C2.2	PANDA EXPRESS SITE NOTES & DETAILS
C3.1	SITE PHOTOMETRIC PLAN & DETAILS

CONTACTS

CIVIL ENGINEER

EXCEL ENGINEERING
100 CAMELOT DRIVE
FOND DU LAC, WISCONSIN 54935
CONTACT: JASON DAYE, PE
P: (920) 926-9800
F: (920) 926-9801
jason.d@excelengineer.com



CONTRACTOR SHALL CALL OUPS AT 1-800-362-2764 AT
LEAST 48 HOURS BUT NO MORE THAN 10 WORKING DAYS
PRIOR TO EXCAVATION ON SITE.

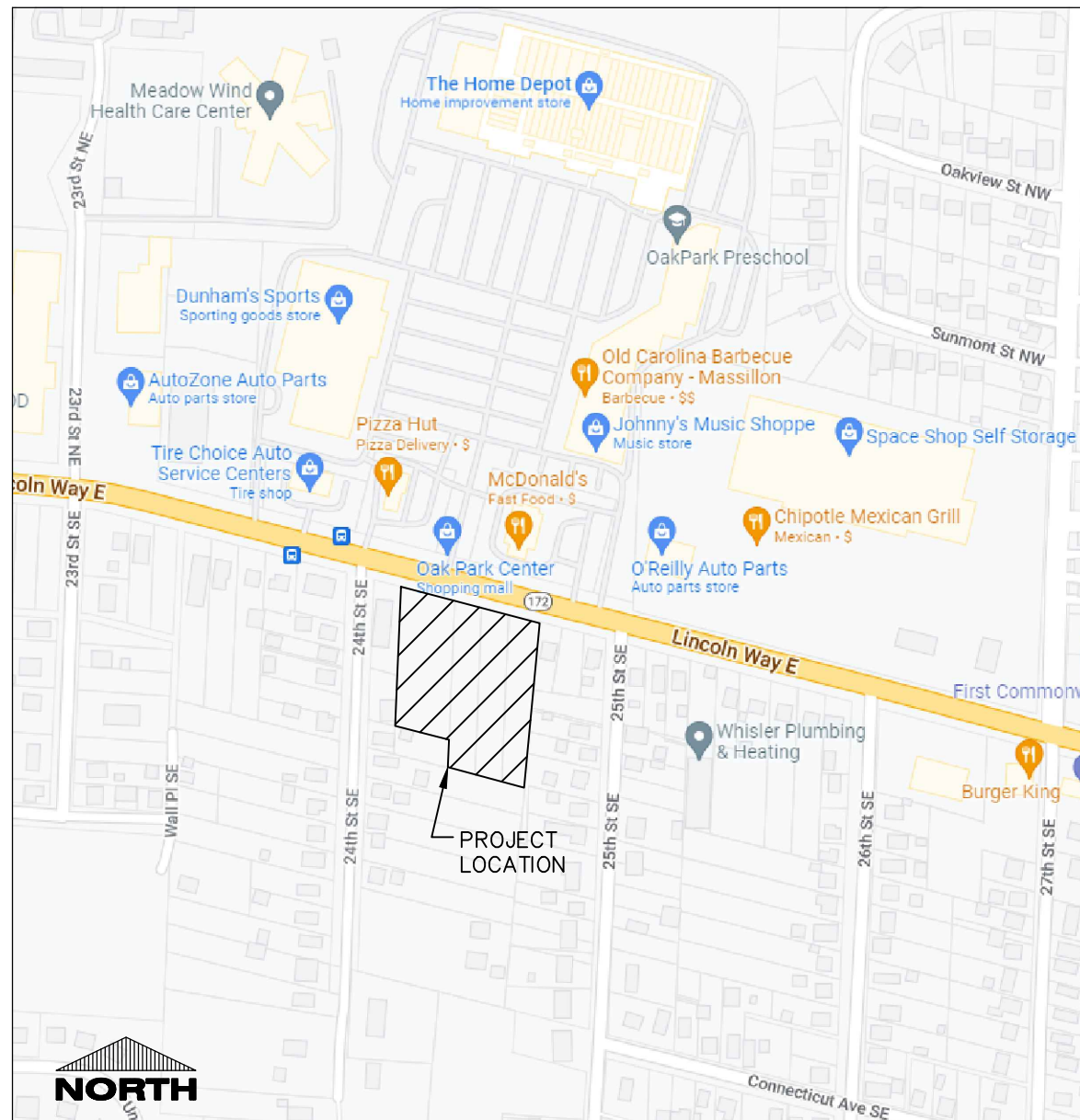

PROJECT LOCATION MAP

DIVISION 31 EARTH WORK

31 10 00 SITE CLEARING (DEMOLITION)

- A. CONTRACTOR SHALL CALL OHIO ONE CALL AND CONDUCT A PRIVATE UTILITY LOCATE AS REQUIRED TO ENSURE THAT ALL UTILITIES HAVE BEEN LOCATED BEFORE STARTING SITE DEMOLITION. DESIGN ENGINEER SHALL BE NOTIFIED OF ANY DISCREPANCIES BETWEEN PLAN AND FIELD CONDITIONS PRIOR TO CONSTRUCTION.
- B. DEMOLITION PLAN IS AN OVERVIEW OF DEMOLITION TO TAKE PLACE ON SITE. CONTRACTOR TO FIELD VERIFY EXISTING SITE CONDITIONS PRIOR TO BIDDING. CONTRACTOR SHALL REMOVE, REPLACE, OR DEMOLISH ALL ITEMS AS NEEDED DURING CONSTRUCTION.
- C. CONTRACTOR TO PROTECT EXISTING IMPROVEMENTS THAT ARE SCHEDULED TO REMAIN. ANY DAMAGE TO EXISTING FACILITIES SHALL BE REPLACED AT CONTRACTORS EXPENSE.
- D. ALL CONCRETE NOTED TO BE REMOVED SHALL BE REMOVED TO THE NEAREST CONTROL JOINT.

31 20 00 EARTH MOVING

- A. CONTRACTOR SHALL CALL ONE CALL AND CONDUCT A PRIVATE UTILITY LOCATE AS REQUIRED TO ENSURE THAT ALL UTILITIES HAVE BEEN LOCATED BEFORE STARTING CONSTRUCTION. DESIGN ENGINEER SHALL BE NOTIFIED OF ANY DISCREPANCIES BETWEEN PLAN AND FIELD LOCATIONS.
- B. PROVIDE ALL MATERIALS AND EQUIPMENT FOR ROAD ELEVATION, GRADING, FILL AND BACKFILL WORK AS REQUIRED TO COMPLETE THE GENERAL CONSTRUCTION. CONTRACTOR SHALL BE RESPONSIBLE FOR ELECTRICAL AND MECHANICALS ARE THE RESPONSIBILITY OF THE ELECTRICAL CONTRACTOR UNLESS OTHERWISE SPECIFIED IN THE SPECIFICATIONS.
- C. ALL ORGANIC TOPSOIL INSIDE THE BUILDING AREA, UNPAVED AREAS AND AT SITE FILL AREAS SHALL BE REMOVED. POOR ROLL MATERIAL SHALL BE REMOVED TO THE EXISTING GRADE. CONTRACTOR SHALL VERIFY TOPSOIL DEPTHS PRIOR TO CONSTRUCTION. THE CONTRACTOR SHALL REVIEW AND FOLLOW THE RECOMMENDATIONS OF THE GEOTECHNICAL REPORT AND ACCOUNT FOR EXISTING CONDITIONS. CONTRACTOR SHALL BE RESPONSIBLE FOR OBTAINING ALL NECESSARY PERMITS AND APPROVALS. ALL WORK SHALL BE DIRECTED IN THE PLANS OR BY LOCAL ZONING REGULATIONS.
- D. PROVIDE ALL BACKFILL FILL OR FILL LAYER MATERIALS TO MEET THE FOLLOWING REQUIREMENTS: UNIFORM, MOISTEN OR REARATE SUBGRADE AND EACH SUBGRADE FILL OR FILL LAYER SHALL BE COMPACTED AS RECOMMENDED TO ACHIEVE SPECIFIED DENSITY. REMOVE AND REPLACE OR SCARP AND RY FILL OR FILL, OTHERWISE SATISFACTORY SOIL MATERIAL THAT IS TOO WEAK TO COMPACT TO SPECIFIED DENSITY SHALL BE REMOVED AND REPLACED WITH SATISFACTORY MATERIAL. CONTRACTOR SHALL BE RESPONSIBLE FOR OBTAINING ALL NECESSARY PERMITS AND APPROVALS. EQUIPMENT, AND NOT MORE THAN 4" IN LOOSE FILL FOR MATERIAL COMPACTED BY HAND-OPERATED METHODS.
- E. COMPACT THE SOIL TO NOT LESS THAN THE FOLLOWING PERCENTAGES OF MAXIMUM DRY DENSITY ACCORDING TO ASTM D 698, STANDARD PROCTOR METHOD, MAY BE USED FOR ALL SUBGRADE AND FILL LAYER MATERIALS. CONTRACTOR SHALL APPLY THE FOLLOWING MINIMUM STRONG REQUIREMENTS WHEN COMPARING BETWEEN THE FOLLOWING AND THE GEOTECHNICAL REPORT:
- 1. UNDER FLOORS - SUBGRADE AND EACH LAYER OF FILL OR FILL MATERIAL TO NOT LESS THAN 95 PERCENT.
 - 2. UNDER EXTERIOR SUBGRADE AND EACH LAYER OF BACKFILL OR FILL MATERIAL TO NOT LESS THAN 95 PERCENT.
 - 3. UNDER EXTERIOR SLAB-ON-GRADE WHERE GROUNDWATER IS WITHIN 3 FEET OF THE SLAB SURFACE - PLACE A DRAINAGE COURSE LAYER CLEAN 3/4" CRUSHED STONE, WITH 10 TO 12% FINES, PER THICKNESS INDICATED ON FOUNDATION PLANS ON PREPARED SUBGRADE.
 - 4. UNDER EXTERIOR SLAB-ON-GRADE WHERE GROUNDWATER IS WITHIN 3 FEET OF THE SLAB SURFACE - PLACE A DRAINAGE COURSE LAYER CLEAN 3/4" CRUSHED STONE, WITH NO MORE THAN 5% FINES, PER THICKNESS INDICATED ON FOUNDATION PLANS ON PREPARED SUBGRADE.
 - 5. UNDER EXTERIOR CONCRETE AND ASPHALT PAVEMENTS - COMPACT THE SUBGRADE AND EACH LAYER OF BACKFILL OR FILL MATERIAL TO NOT LESS THAN 95 PERCENT.
 - 6. UNDER LAWN OR UNPAVED AREAS - COMPACT SUBGRADE AND EACH LAYER OF BACKFILL OR FILL MATERIAL TO NOT LESS THAN 95 PERCENT.
 - 7. UNDER LAWN OR UNPAVED AREAS - COMPACT SUBGRADE AND EACH LAYER OF BACKFILL OR FILL MATERIAL TO NOT LESS THAN 85 PERCENT.

G. CONTRACTOR SHALL ENGAGE A QUALIFIED INDEPENDENT TESTING AND INSPECTING AGENCY TO PERFORM FIELD TESTS AND INSPECTIONS. CONTRACTOR SHALL PROVIDE DOCUMENTATION OF PASSING DENSITY TESTING AND PROOF-ROLLING TO ENGINEER UPON COMPLETION. IT IS SUGGESTED THAT THE GEOTECHNICAL FIRM USED TO PERFORM THE SUBSURFACE SOIL INVESTIGATION BE ENGAGED FOR THE FIELD QUALITY CONTROL TESTS.

- H. ALLOW THE TESTING AGENCY TO TEST AND INSPECT SUBGRADES AND EACH ILL OR BACKFILL AREA. PROCEED WITH SUBSEQUENT EARTHWORK ONLY AFTER TEST RESULTS FOR PREVIOUSLY COMPLETED WORK COMPLY WITH REQUIREMENTS. PROVIDE ONE TEST FOR EVERY 2000 SQUARE FEET OF PAVED AREA OR BUILDING SLAB (ONE TEST FOR EACH SPREAD FOOTING, AND ONE TEST FOR EVERY 50 LINEAR FEET OF WALL). STOP FOOTING.
- I. WHEN THE TESTING AGENCY REPORTS THAT SUBGRADES, FILLS, OR BACKFILLS HAVE NOT ACHIEVED DEGREE OF COMPRESSION SPECIFIED, SCARIFY AND MOISTEN OR AERATE, OR REMOVE AND REPLACE SOIL TO DEPTH REQUIRED; RECOMPACT AND RETEST UNTIL SPECIFIED COMPRESSION IS OBTAINED.
- J. THE SUBGRADE SHALL BE GRADDED TO PROVIDE DRAINAGE AWAY FROM THE BUILDING AS INDICATED ON THE PLANS. SEE EARTHWORK SECTION FOR DRAINAGE REQUIREMENTS. THE FINISHED GRADE SHALL BE GRADDED TO WITHIN 0.10' OF REQUIRED EARTHWORK ELEVATIONS ASSUMING POSITIVE DRAINAGE IS MAINTAINED IN ACCORDANCE WITH THE GRADING PLAN.

31 30 00 EROSION CONTROL/STORMWATER MANAGEMENT & POLLUTION PREVENTION

1. THE DESIGN ENGINEER SHALL PREPARE A SITE SPECIFIC EROSION CONTROL AND A STORMWATER MANAGEMENT PLAN PURSUANT TO THE REQUIREMENTS OF THE OHIO PERMIT NO. 004000000. CONSTRUCTION GENERAL PERMIT AUTHORIZATION FOR STORM WATER POLLUTION PREVENTION AND EROSION CONTROL. THE EROSION CONTROL PLAN SHALL BE SUBMITTED TO THE OHIO DEPARTMENT OF NATURAL RESOURCES FOR REVIEW AND APPROVAL. THE EROSION CONTROL PLAN SHALL BE APPROVED PRIOR TO THE START OF CONSTRUCTION. THE EROSION CONTROL PLAN SHALL BE MAINTAINED AND UPDATED AS NECESSARY TO ENSURE EROSION CONTROL AND STORMWATER MANAGEMENT PLANS, MEASURES AND PROCEDURES ARE EFFECTIVE AND COMPLIANT WITH ALL APPLICABLE EROSION CONTROL REQUIREMENTS UNTIL PERMIT COVERAGE IS TERMINATED.
2. THE CONTRACTOR IS RESPONSIBLE FOR THE FOLLOWING:
- A. THE CONTRACTOR SHALL FURNISH FOR MEETING THE MONITORING, MAINTENANCE AND REPORTING REQUIREMENTS OF THE CONSTRUCTION GENERAL PERMIT. INSPECTIONS OF IMPLEMENTED EROSION AND SEDIMENT CONTROL BEST MANAGEMENT PRACTICES SHALL BE CONDUCTED AT THE FOLLOWING FREQUENCIES:
 - 1. DURING THE PRELIMINARY PHASE OF CONSTRUCTION, THE CONTRACTOR SHALL CONDUCT INSPECTIONS OF EROSION AND SEDIMENT CONTROL MEASURES AT LEAST ONCE PER WEEK.
 - 2. DURING THE PRESENT PHASE OF LAND DISTURBING CONSTRUCTION, THE CONTRACTOR SHALL CONDUCT INSPECTIONS OF EROSION AND SEDIMENT CONTROL MEASURES AT LEAST ONCE PER WEEK.
 - 3. DURING THE FINAL PHASE OF CONSTRUCTION, THE CONTRACTOR SHALL CONDUCT INSPECTIONS OF EROSION AND SEDIMENT CONTROL MEASURES AT LEAST ONCE PER WEEK.
 - 4. THE CONTRACTOR SHALL MAINTAIN A RECORD OF THE CONSTRUCTION SITE OR AVAILABLE VIA AN INTERNET WEBSITE, WEEKLY WRITTEN REPORTS OF EROSION AND SEDIMENT CONTROL MEASURES AND PROCEDURES. THE EROSION AND SEDIMENT CONTROL MEASURES AND PROCEDURES SHALL INCLUDE ALL OF THE FOLLOWING:
 - 1. THE DATE, TIME, AND LOCATION OF EACH EROSION AND SEDIMENT CONTROL INSPECTION.
 - 2. THE NAME OF THE PERSON WHO PERFORMED THE INSPECTION.
 - 3. A DETAILED DESCRIPTION OF THE CONDITION OF THE EROSION AND SEDIMENT CONTROLS.
 - 4. A SUMMARY OF THE RESULTS OF THE INSPECTION AND THE ACTIONS TO BE TAKEN TO CORRECT DEFICIENCIES.
 - 5. A SUMMARY OF THE RESULTS OF THE PRESENT PHASE OF LAND DISTURBING CONSTRUCTION ACTIVITY AT THE CONSTRUCTION SITE.
 - 6. A SUMMARY OF THE RESULTS OF THE FINAL PHASE OF LAND DISTURBING CONSTRUCTION ACTIVITY AT THE CONSTRUCTION SITE.
 - 7. A SUMMARY OF THE RESULTS OF THE FINAL PHASE OF LAND DISTURBING CONSTRUCTION ACTIVITY AT THE CONSTRUCTION SITE.
3. THE EROSION AND SEDIMENT CONTROL IMPLEMENTED DURING CONSTRUCTION SHALL STRICTLY COMPLY WITH THE GUIDELINES AND REQUIREMENTS SET FORTH IN THE OHIO EPA RAINWATER AND LAND DEVELOPMENT MANUAL. THE METHODS AND TYPES OF EROSION AND SEDIMENT CONTROL MEASURES SHALL BE DETERMINED BY THE DESIGN ENGINEER AND THE CONTRACTOR SHALL BE RESPONSIBLE TO MEET FIELD CONDITIONS AT THE TIME OF CONSTRUCTION, AND INSTALLED PRIOR TO ANY GRADING OR DISTURBANCE OF EXISTING SURFACES. REQUIRED: IS A LIST OF EROSION AND SEDIMENT CONTROL BEST MANAGEMENT PRACTICES TO ACHIEVE THE PERFORMANCE STANDARDS BELOW.
4. SILT FENCE SHALL BE PLACED ON SITE AT LOCATIONS SHOWN ON THE EROSION CONTROL PLAN. SILT FENCE SHALL ALSO BE PROVIDED TO PREVENT EROSION AND SEDIMENT FROM ENTERING THE FOLLOWING LOCATIONS:
- A. NEAR THE EROSION AND SEDIMENT CONTROL MEASURES.
 - B. NEAR THE EROSION AND SEDIMENT CONTROL MEASURES.
 - C. NEAR THE EROSION AND SEDIMENT CONTROL MEASURES.
 - D. NEAR THE EROSION AND SEDIMENT CONTROL MEASURES.
 - E. NEAR THE EROSION AND SEDIMENT CONTROL MEASURES.
 - F. NEAR THE EROSION AND SEDIMENT CONTROL MEASURES.
 - G. NEAR THE EROSION AND SEDIMENT CONTROL MEASURES.
 - H. NEAR THE EROSION AND SEDIMENT CONTROL MEASURES.
 - I. NEAR THE EROSION AND SEDIMENT CONTROL MEASURES.
 - J. NEAR THE EROSION AND SEDIMENT CONTROL MEASURES.
 - K. NEAR THE EROSION AND SEDIMENT CONTROL MEASURES.
 - L. NEAR THE EROSION AND SEDIMENT CONTROL MEASURES.
 - M. NEAR THE EROSION AND SEDIMENT CONTROL MEASURES.
 - N. NEAR THE EROSION AND SEDIMENT CONTROL MEASURES.
 - O. NEAR THE EROSION AND SEDIMENT CONTROL MEASURES.
 - P. NEAR THE EROSION AND SEDIMENT CONTROL MEASURES.
 - Q. NEAR THE EROSION AND SEDIMENT CONTROL MEASURES.
 - R. NEAR THE EROSION AND SEDIMENT CONTROL MEASURES.
 - S. NEAR THE EROSION AND SEDIMENT CONTROL MEASURES.
 - T. NEAR THE EROSION AND SEDIMENT CONTROL MEASURES.
 - U. NEAR THE EROSION AND SEDIMENT CONTROL MEASURES.
 - V. NEAR THE EROSION AND SEDIMENT CONTROL MEASURES.
 - W. NEAR THE EROSION AND SEDIMENT CONTROL MEASURES.
 - X. NEAR THE EROSION AND SEDIMENT CONTROL MEASURES.
 - Y. NEAR THE EROSION AND SEDIMENT CONTROL MEASURES.
 - Z. NEAR THE EROSION AND SEDIMENT CONTROL MEASURES.
5. THE CONTRACTOR SHALL MAINTAIN A RECORD OF THE CONSTRUCTION SITE OR AVAILABLE VIA AN INTERNET WEBSITE, WEEKLY WRITTEN REPORTS OF EROSION AND SEDIMENT CONTROL MEASURES AND PROCEDURES. THE EROSION AND SEDIMENT CONTROL MEASURES AND PROCEDURES SHALL INCLUDE ALL OF THE FOLLOWING:
- 1. THE DATE, TIME, AND LOCATION OF EACH EROSION AND SEDIMENT CONTROL INSPECTION.
 - 2. THE NAME OF THE PERSON WHO PERFORMED THE INSPECTION.
 - 3. A DETAILED DESCRIPTION OF THE CONDITION OF THE EROSION AND SEDIMENT CONTROLS.
 - 4. A SUMMARY OF THE RESULTS OF THE INSPECTION AND THE ACTIONS TO BE TAKEN TO CORRECT DEFICIENCIES.
 - 5. A SUMMARY OF THE RESULTS OF THE PRESENT PHASE OF LAND DISTURBING CONSTRUCTION ACTIVITY AT THE CONSTRUCTION SITE.
 - 6. A SUMMARY OF THE RESULTS OF THE FINAL PHASE OF LAND DISTURBING CONSTRUCTION ACTIVITY AT THE CONSTRUCTION SITE.
 - 7. A SUMMARY OF THE RESULTS OF THE FINAL PHASE OF LAND DISTURBING CONSTRUCTION ACTIVITY AT THE CONSTRUCTION SITE.
6. THE CONTRACTOR SHALL PROVIDE AN APPROPRIATE CONCRETE TRUCK WASHOUT AREA ON SITE. THE CONTRACTOR TO ENSURE THAT CONCRETE WASHOUT WATER IS NOT DISCHARGED INTO ANY ADJACENT WATER BODIES OR RUNOFF INTO STORM DRAINAGE OR INTO OVERLAND DRAINAGE SYSTEM. WASHOUT AREA SHALL BE REMOVED UPON COMPLETION OF CONSTRUCTION.
7. THE CONTRACTOR SHALL MAINTAIN A RECORD OF THE CONSTRUCTION SITE OR AVAILABLE VIA AN INTERNET WEBSITE, WEEKLY WRITTEN REPORTS OF EROSION AND SEDIMENT CONTROL MEASURES AND PROCEDURES. THE EROSION AND SEDIMENT CONTROL MEASURES AND PROCEDURES SHALL INCLUDE ALL OF THE FOLLOWING:
- 1. THE DATE, TIME, AND LOCATION OF EACH EROSION AND SEDIMENT CONTROL INSPECTION.
 - 2. THE NAME OF THE PERSON WHO PERFORMED THE INSPECTION.
 - 3. A DETAILED DESCRIPTION OF THE CONDITION OF THE EROSION AND SEDIMENT CONTROLS.
 - 4. A SUMMARY OF THE RESULTS OF THE INSPECTION AND THE ACTIONS TO BE TAKEN TO CORRECT DEFICIENCIES.
 - 5. A SUMMARY OF THE RESULTS OF THE PRESENT PHASE OF LAND DISTURBING CONSTRUCTION ACTIVITY AT THE CONSTRUCTION SITE.
 - 6. A SUMMARY OF THE RESULTS OF THE FINAL PHASE OF LAND DISTURBING CONSTRUCTION ACTIVITY AT THE CONSTRUCTION SITE.
 - 7. A SUMMARY OF THE RESULTS OF THE FINAL PHASE OF LAND DISTURBING CONSTRUCTION ACTIVITY AT THE CONSTRUCTION SITE.
8. THE CONTRACTOR SHALL PROVIDE AN APPROPRIATE CONCRETE TRUCK WASHOUT AREA ON SITE. THE CONTRACTOR TO ENSURE THAT CONCRETE WASHOUT WATER IS NOT DISCHARGED INTO ANY ADJACENT WATER BODIES OR RUNOFF INTO STORM DRAINAGE OR INTO OVERLAND DRAINAGE SYSTEM. WASHOUT AREA SHALL BE REMOVED UPON COMPLETION OF CONSTRUCTION.
9. THE CONTRACTOR SHALL MAINTAIN A RECORD OF THE CONSTRUCTION SITE OR AVAILABLE VIA AN INTERNET WEBSITE, WEEKLY WRITTEN REPORTS OF EROSION AND SEDIMENT CONTROL MEASURES AND PROCEDURES. THE EROSION AND SEDIMENT CONTROL MEASURES AND PROCEDURES SHALL INCLUDE ALL OF THE FOLLOWING:
- 1. THE DATE, TIME, AND LOCATION OF EACH EROSION AND SEDIMENT CONTROL INSPECTION.
 - 2. THE NAME OF THE PERSON WHO PERFORMED THE INSPECTION.
 - 3. A DETAILED DESCRIPTION OF THE CONDITION OF THE EROSION AND SEDIMENT CONTROLS.
 - 4. A SUMMARY OF THE RESULTS OF THE INSPECTION AND THE ACTIONS TO BE TAKEN TO CORRECT DEFICIENCIES.
 - 5. A SUMMARY OF THE RESULTS OF THE PRESENT PHASE OF LAND DISTURBING CONSTRUCTION ACTIVITY AT THE CONSTRUCTION SITE.
 - 6. A SUMMARY OF THE RESULTS OF THE FINAL PHASE OF LAND DISTURBING CONSTRUCTION ACTIVITY AT THE CONSTRUCTION SITE.
 - 7. A SUMMARY OF THE RESULTS OF THE FINAL PHASE OF LAND DISTURBING CONSTRUCTION ACTIVITY AT THE CONSTRUCTION SITE.
10. THE CONTRACTOR SHALL PROVIDE AN APPROPRIATE CONCRETE TRUCK WASHOUT AREA ON SITE. THE CONTRACTOR TO ENSURE THAT CONCRETE WASHOUT WATER IS NOT DISCHARGED INTO ANY ADJACENT WATER BODIES OR RUNOFF INTO STORM DRAINAGE OR INTO OVERLAND DRAINAGE SYSTEM. WASHOUT AREA SHALL BE REMOVED UPON COMPLETION OF CONSTRUCTION.
11. THE CONTRACTOR SHALL MAINTAIN A RECORD OF THE CONSTRUCTION SITE OR AVAILABLE VIA AN INTERNET WEBSITE, WEEKLY WRITTEN REPORTS OF EROSION AND SEDIMENT CONTROL MEASURES AND PROCEDURES. THE EROSION AND SEDIMENT CONTROL MEASURES AND PROCEDURES SHALL INCLUDE ALL OF THE FOLLOWING:
- 1. THE DATE, TIME, AND LOCATION OF EACH EROSION AND SEDIMENT CONTROL INSPECTION.
 - 2. THE NAME OF THE PERSON WHO PERFORMED THE INSPECTION.
 - 3. A DETAILED DESCRIPTION OF THE CONDITION OF THE EROSION AND SEDIMENT CONTROLS.
 - 4. A SUMMARY OF THE RESULTS OF THE INSPECTION AND THE ACTIONS TO BE TAKEN TO CORRECT DEFICIENCIES.
 - 5. A SUMMARY OF THE RESULTS OF THE PRESENT PHASE OF LAND DISTURBING CONSTRUCTION ACTIVITY AT THE CONSTRUCTION SITE.
 - 6. A SUMMARY OF THE RESULTS OF THE FINAL PHASE OF LAND DISTURBING CONSTRUCTION ACTIVITY AT THE CONSTRUCTION SITE.
 - 7. A SUMMARY OF THE RESULTS OF THE FINAL PHASE OF LAND DISTURBING CONSTRUCTION ACTIVITY AT THE CONSTRUCTION SITE.
12. THE CONTRACTOR SHALL PROVIDE AN APPROPRIATE CONCRETE TRUCK WASHOUT AREA ON SITE. THE CONTRACTOR TO ENSURE THAT CONCRETE WASHOUT WATER IS NOT DISCHARGED INTO ANY ADJACENT WATER BODIES OR RUNOFF INTO STORM DRAINAGE OR INTO OVERLAND DRAINAGE SYSTEM. WASHOUT AREA SHALL BE REMOVED UPON COMPLETION OF CONSTRUCTION.
13. THE CONTRACTOR SHALL MAINTAIN A RECORD OF THE CONSTRUCTION SITE OR AVAILABLE VIA AN INTERNET WEBSITE, WEEKLY WRITTEN REPORTS OF EROSION AND SEDIMENT CONTROL MEASURES AND PROCEDURES. THE EROSION AND SEDIMENT CONTROL MEASURES AND PROCEDURES SHALL INCLUDE ALL OF THE FOLLOWING:
- 1. THE DATE, TIME, AND LOCATION OF EACH EROSION AND SEDIMENT CONTROL INSPECTION.
 - 2. THE NAME OF THE PERSON WHO PERFORMED THE INSPECTION.
 - 3. A DETAILED DESCRIPTION OF THE CONDITION OF THE EROSION AND SEDIMENT CONTROLS.
 - 4. A SUMMARY OF THE RESULTS OF THE INSPECTION AND THE ACTIONS TO BE TAKEN TO CORRECT DEFICIENCIES.
 - 5. A SUMMARY OF THE RESULTS OF THE PRESENT PHASE OF LAND DISTURBING CONSTRUCTION ACTIVITY AT THE CONSTRUCTION SITE.
 - 6. A SUMMARY OF THE RESULTS OF THE FINAL PHASE OF LAND DISTURBING CONSTRUCTION ACTIVITY AT THE CONSTRUCTION SITE.
 - 7. A SUMMARY OF THE RESULTS OF THE FINAL PHASE OF LAND DISTURBING CONSTRUCTION ACTIVITY AT THE CONSTRUCTION SITE.
14. THE CONTRACTOR SHALL PROVIDE AN APPROPRIATE CONCRETE TRUCK WASHOUT AREA ON SITE. THE CONTRACTOR TO ENSURE THAT CONCRETE WASHOUT WATER IS NOT DISCHARGED INTO ANY ADJACENT WATER BODIES OR RUNOFF INTO STORM DRAINAGE OR INTO OVERLAND DRAINAGE SYSTEM. WASHOUT AREA SHALL BE REMOVED UPON COMPLETION OF CONSTRUCTION.
15. THE CONTRACTOR SHALL MAINTAIN A RECORD OF THE CONSTRUCTION SITE OR AVAILABLE VIA AN INTERNET WEBSITE, WEEKLY WRITTEN REPORTS OF EROSION AND SEDIMENT CONTROL MEASURES AND PROCEDURES. THE EROSION AND SEDIMENT CONTROL MEASURES AND PROCEDURES SHALL INCLUDE ALL OF THE FOLLOWING:
- 1. THE DATE, TIME, AND LOCATION OF EACH EROSION AND SEDIMENT CONTROL INSPECTION.
 - 2. THE NAME OF THE PERSON WHO PERFORMED THE INSPECTION.
 - 3. A DETAILED DESCRIPTION OF THE CONDITION OF THE EROSION AND SEDIMENT CONTROLS.
 - 4. A SUMMARY OF THE RESULTS OF THE INSPECTION AND THE ACTIONS TO BE TAKEN TO CORRECT DEFICIENCIES.
 - 5. A SUMMARY OF THE RESULTS OF THE PRESENT PHASE OF LAND DISTURBING CONSTRUCTION ACTIVITY AT THE CONSTRUCTION SITE.
 - 6. A SUMMARY OF THE RESULTS OF THE FINAL PHASE OF LAND DISTURBING CONSTRUCTION ACTIVITY AT THE CONSTRUCTION SITE.
 - 7. A SUMMARY OF THE RESULTS OF THE FINAL PHASE OF LAND DISTURBING CONSTRUCTION ACTIVITY AT THE CONSTRUCTION SITE.
16. THE CONTRACTOR SHALL PROVIDE AN APPROPRIATE CONCRETE TRUCK WASHOUT AREA ON SITE. THE CONTRACTOR TO ENSURE THAT CONCRETE WASHOUT WATER IS NOT DISCHARGED INTO ANY ADJACENT WATER BODIES OR RUNOFF INTO STORM DRAINAGE OR INTO OVERLAND DRAINAGE SYSTEM. WASHOUT AREA SHALL BE REMOVED UPON COMPLETION OF CONSTRUCTION.
17. THE CONTRACTOR SHALL MAINTAIN A RECORD OF THE CONSTRUCTION SITE OR AVAILABLE VIA AN INTERNET WEBSITE, WEEKLY WRITTEN REPORTS OF EROSION AND SEDIMENT CONTROL MEASURES AND PROCEDURES. THE EROSION AND SEDIMENT CONTROL MEASURES AND PROCEDURES SHALL INCLUDE ALL OF THE FOLLOWING:
- 1. THE DATE, TIME, AND LOCATION OF EACH EROSION AND SEDIMENT CONTROL INSPECTION.
 - 2. THE NAME OF THE PERSON WHO PERFORMED THE INSPECTION.
 - 3. A DETAILED DESCRIPTION OF THE CONDITION OF THE EROSION AND SEDIMENT CONTROLS.
 - 4. A SUMMARY OF THE RESULTS OF THE INSPECTION AND THE ACTIONS TO BE TAKEN TO CORRECT DEFICIENCIES.
 - 5. A SUMMARY OF THE RESULTS OF THE PRESENT PHASE OF LAND DISTURBING CONSTRUCTION ACTIVITY AT THE CONSTRUCTION SITE.
 - 6. A SUMMARY OF THE RESULTS OF THE FINAL PHASE OF LAND DISTURBING CONSTRUCTION ACTIVITY AT THE CONSTRUCTION SITE.
 - 7. A SUMMARY OF THE RESULTS OF THE FINAL PHASE OF LAND DISTURBING CONSTRUCTION ACTIVITY AT THE CONSTRUCTION SITE.
18. THE CONTRACTOR SHALL PROVIDE AN APPROPRIATE CONCRETE TRUCK WASHOUT AREA ON SITE. THE CONTRACTOR TO ENSURE THAT CONCRETE WASHOUT WATER IS NOT DISCHARGED INTO ANY ADJACENT WATER BODIES OR RUNOFF INTO STORM DRAINAGE OR INTO OVERLAND DRAINAGE SYSTEM. WASHOUT AREA SHALL BE REMOVED UPON COMPLETION OF CONSTRUCTION.
19. THE CONTRACTOR SHALL MAINTAIN A RECORD OF THE CONSTRUCTION SITE OR AVAILABLE VIA AN INTERNET WEBSITE, WEEKLY WRITTEN REPORTS OF

Table A: Allowable Pipe Material Schedule				
Utility	Material	Pipe Code	Fitting Code	Joint Code
Water Lateral	C901/906 PE	AWWA C901/C906	ASTM D2609, ASTM D2683, ASTM D3261	Heat fusion: ASTM D2657
Fire Hydrant Lateral	C900 PVC	AWWA C900, ASTM D1785, ASTM D3041	AWWA C110, AWWA C153, ASTM D2464, ASTM D2466, ASTM D2467, ASTM D3311, ASTM F409, ASTM F1336, ASTM F1866	Joint: ASTM D3139 Integral Bell & Spigot Elastomeric Seal: ASTM F477
Sanitary Sewer	SDR 35 PVC	ASTM D1785, ASTM D2665, ASTM D3034, ASTM F891	ASTM F1336	Push On: ASTM D3212 for Tightness Elastomeric Gasket: ASTM F477
Storm Sewer	HDPE	ASTM F2648	ASTM F2306 Saddle Gasket	Joint: ASTM F2648 Bell & Spigot Elastomeric Seal: ASTM F477
Storm Sewer	SDR 35 PVC	ASTM D1785, ASTM D2665, ASTM D3034, ASTM F891	ASTM F1336	Push On: ASTM D3212 for Tightness Elastomeric Seal: ASTM F477

GENERAL PROJECT NOTES

1. ALL DRIVEWAYS AND CURB CUTS TO BE CONSTRUCTED ACCORDING TO LOCAL ORDINANCES. CONTRACTOR TO OBTAIN ALL NECESSARY PERMITS.

2. THE CONTRACTOR IS RESPONSIBLE FOR OBTAINING ALL WORK IN ROW PERMITS.

APPROVED BY THE MASSILLON CITY ENGINEER THIS DAY OF _____, 2023

CITY ENGINEER

ONLY APPROVED SIGNED PLANS BY THE CITY ENGINEER ARE TO BE USED FOR CONSTRUCTION.

CONSTRUCTION SEQUENCE	
PHASE	TYPE OF ACTION
1. PRE-CONSTRUCTION ACTION	1. CONTRACTOR TO CALL OUPS AT A MINIMUM OF 2 DAYS PRIOR TO CONSTRUCTION.
	2. CONTRACTOR TO FIELD VERIFY LOCATION AND DEPTH OF ALL UTILITIES WITHIN THE PROJECT AREA PRIOR TO CONSTRUCTION. NOTIFY ENGINEER OF DISCREPANCIES.
	3. PLACE ALL TEMPORARY SILT FENCE AND INLET PROTECTION.
	4. CONSTRUCT TRACKING STONE ENTRANCES AND ANY TEMPORARY CONSTRUCTION ROADWAYS AS NEEDED.
	5. CONSTRUCT PERMANENT STORMWATER DETENTION SYSTEMS AND PERMANENT STORMWATER CONVEYANCE SYSTEMS.
	6. CONSTRUCT ANY TEMPORARY STORMWATER CONVEYANCE SYSTEMS AS NEEDED.
	7. STABILIZE ALL TEMPORARY AND PERMANENT EROSION CONTROL AND STORMWATER CONVEYANCE SYSTEMS BEFORE TOPSOIL CAN BE STRIPPED.
2. CONSTRUCTION ACTION	1. SITE DEMOLITION AS REQUIRED.
	2. STRIP AND RELOCATE TOPSOIL TO THE DESIGNATED TOPSOIL STOCKPILE. FINAL LOCATION BY OWNER/CONTRACTOR. PROVIDE PERIMETER SILT FENCE UNTIL STABILIZED.
	3. BEGIN MASS EARTH WORK FOR THE BUILDING PAD AND PAVEMENT AREAS.
	4. CONSTRUCT ANY REMAINING STORMWATER CONVEYANCE SYSTEMS, AND INSTALL ALL OTHER UTILITIES ON SITE.
	5. DIG AND POUR ALL BUILDING FOOTINGS.
	6. PLACE GRAVEL FOR ALL PROPOSED PAVEMENT AREAS.
	7. TOPSOIL, SEED, AND MULCH ALL DISTURBED AREAS OUTSIDE THE BUILDING AND PROPOSED PAVEMENT AREAS.
	8. CONSTRUCT BUILDING.
	9. PAVE DRIVEWAYS AND PARKING AREAS.
	10. TOPSOIL, SEED, AND MULCH ALL OTHER DISTURBED AREAS. PLACE EROSION MATTING AS NEEDED.
3. POST CONSTRUCTION ACTION	1. CONTRACTOR TO REMOVE TEMPORARY EROSION CONTROL MEASURES UPON SITE STABILIZATION.
	2. SEE THE POST CONSTRUCTION MAINTENANCE PLAN FOR PERMANENT STORMWATER MANAGEMENT SYSTEMS.

DIVISION 32 EXTERIOR IMPROVEMENTS

32 10 00 AGGREGATE BASE & ASPHALT PAVEMENT

- A. CONTRACTOR TO PROVIDE COMPACT GRANULAR AGGREGATE BASE AND HOT MIX ASPHALT PAVEMENT WHERE INDICATED ON THE PLANS. ALL AGGREGATE PROVIDED MUST COMPLY WITH COTD CONSTRUCTION AND MATERIAL SPECIFICATIONS (CURRENT EDITION). PROVIDE HOT MIX ASPHALT STRUCTURE TYPES AND GRADES AS SHOWN ON CONSTRUCTION AND MATERIAL SPECIFICATIONS (CURRENT EDITION). CONTRACTOR SHALL OBTAIN AND REVIEW SOILS REPORT FOR RECOMMENDATIONS FOR GEO-GRID / GEOTEXTILE BELOW CRUSHED AGGREGATE (IF APPLICABLE). CONTRACTOR TO PROVIDE AGGREGATE BASE AND HOT MIX ASPHALT PAVEMENT TYPES AND DEPTHS AS INDICATED BELOW OR PER GEOTECHNICAL RECOMMENDATIONS.
- HEAVY ASPHALT PAVING SECTION:
1-1/2" SURFACE COURSE
TACK COAT
2-1/2" BINDER COURSE
12" OF 1-1/4" CRUSHED AGGREGATE
- B. CONTRACTOR TO COMPACT THE AGGREGATE BASE, ASPHALT BINDER COURSE AND ASPHALT SURFACE COURSE TO AN AVERAGE DENSITY PER COTD CONSTRUCTION AND MATERIAL SPECIFICATIONS (CURRENT EDITION). ALL ASPHALT PAVEMENT AREAS SHALL BE PAVED TO WITHIN 0.5% OF DESIGN SURFACE GRADES WITH POSITIVE DRAINAGE BEING MAINTAINED IN ACCORDANCE WITH DESIGN PLANS. A MINIMUM OF 1.5% SLOPE SHALL BE MAINTAINED IN ALL ASPHALT PAVEMENT AREA.
- C. HOT MIX ASPHALT CONSTRUCTION TO BE PROVIDED PER MOST STRINGENT REQUIREMENTS OF GEOTECHNICAL REPORT OR CONSTRUCTION DOCUMENTS.
- D. CONTRACTOR TO PROVIDE 4" WHITE PAINT STRIPES FOR PARKING STALLS, TRAFFIC LANES, AND NO PARKING AREAS. PAINT MARKINGS SHALL ALSO BE PROVIDED FOR A.C. ACCESSIBLE SYMBOLS, TRAFFIC ARROWS, AND TRAFFIC MESSAGES.

32 20 00 CONCRETE AND AGGREGATE BASE

- [illegible]

32 30 00 LANDSCAPING AND SITE STABILIZATION

- A. TOPSOIL.** CONTRACTOR TO PROVIDE A MINIMUM OF 6" OF TOPSOIL FOR ALL DISTURBED OPEN AREAS, OTHER THAN A LANDSCAPE GRASS AREA WHICH SHALL BE PROVIDED WITH A MINIMUM OF 0" OF TOPSOIL. REUSE SURFACE SOIL STOCKPILED ON SITE AND SUPPLEMENT WITH TOPSOIL TO MEET THE MINIMUM REQUIREMENTS. TOPSOIL SHALL BE FREE OF STONES, LIMESTONE, AND OTHER FOREIGN MATERIALS. TOPSOIL TO BE PLACED TO A MINIMUM DEPTH OF 6" TO 12" TO A MINIMUM 1% GRADE TO LANDSCAPE FINAL GRADING. LANDSCAPE TO BE PREPARED FOR PULVERIZING AND FINAL GRADING OF TOPSOIL. PROVIDE SOIL ANALYSIS BY A QUALIFIED SOIL TESTING LABORATORY AS REQUIRED TO VERIFY THE QUALITY OF SOIL TO BE USED. TOPSOIL ANALYSIS TO DETERMINE THE NECESSARY SOIL AMENDMENTS. TEST SOIL FOR PHOSPHORUS, AZIRINE AND INFROM EXCEL ENGINEERING, INC. IF PRESENT PRIOR TO BIDDING PROJECT. TOPSOIL SHALL HAVE A P H RANGE OF 5.5 TO 8. CONTAIN A MINIMUM OF 5 PERCENT ORGANIC MATERIAL CONTENT, AND SHALL BE FREE OF STONES 1 INCH OR LARGER IN DIAMETER. TOPSOIL SHALL BE USEFUL TO PLANT AND GROW PLANTS.
- B. TOPSOIL INSTALLATION:** LOOSEN SUBGRADE TO A MINIMUM DEPTH OF 6 INCHES AND REMOVE STONES LARGER THAN 1" IN DIAMETER. ALSO REMOVE ANY STICKS, ROCKS, RUBBER, AND OTHER EXTRANEOUS MATERIAL AND DISPOSE OF THEM OFF THE PROPERTY. SPREAD TOPSOIL TO A MINIMUM DEPTH OF 6" TO 12" TO A MINIMUM 1% GRADE TO LANDSCAPE FINAL GRADING. LANDSCAPE TO BE PREPARED FOR PULVERIZING AND FINAL GRADING OF TOPSOIL. PROVIDE SOIL ANALYSIS BY A QUALIFIED SOIL TESTING LABORATORY AS REQUIRED TO VERIFY THE QUALITY OF SOIL TO BE USED. TOPSOIL ANALYSIS TO DETERMINE THE NECESSARY SOIL AMENDMENTS. TEST SOIL FOR PHOSPHORUS, AZIRINE AND INFROM EXCEL ENGINEERING, INC. IF PRESENT PRIOR TO BIDDING PROJECT. TOPSOIL SHALL HAVE A P H RANGE OF 5.5 TO 8. CONTAIN A MINIMUM OF 5 PERCENT ORGANIC MATERIAL CONTENT, AND SHALL BE FREE OF STONES 1 INCH OR LARGER IN DIAMETER. TOPSOIL SHALL BE USEFUL TO PLANT AND GROW PLANTS.
- SEEDED LAWNS:**
- 1. PERMANENT LAWN AREAS** SHALL BE SEEDDED WITH A BLEND THAT IS CONSISTENT WITH CLIMATE AND TYPICAL OF THE GENERAL AREA. THE FOLLOWING MIXTURE IS PROVIDED AS A GENERAL RECOMMENDATION: 60% KENTUCKY BLUEGRASS BLEND (2.0-2.6 LBS/1,000 S.F.) AND 40% PERENNIAL RYEGRASS (0.80 LBS/1,000 S.F.). FERTILIZE AS PER SOIL TEST OR APPLY 5-10-10 OR EQUIVALENT AT 5.0 LBS/1,000 S.F. SEE EROSION MATTING SPECIFICATIONS AS REQUIRED. FOLLOW PROCEDURES FOUND IN THE OHIO EPA RAINWATER AND LAND DEVELOPMENT MANUAL.
- 2. TRANSITION AREAS** AND AREAS OF CONCERN SHALL BE SEEDDED ON SLOPES AND SHALLOW BOTTOMS AND SIDE SLOPES SHALL BE SEEDDED WITH THE FOLLOWING MIXTURE: 45% KENTUCKY BLUEGRASS (0.80 LBS/1,000 S.F.), 40% CREeping REEDGRASS (0.50 LBS/1,000 S.F.) AND 15% PERENNIAL RYEGRASS (0.20 LBS/1,000 S.F.). FERTILIZE AS PER SOIL TEST OR APPLY 5-10-10 OR EQUIVALENT AT 5.0 LBS/1,000 S.F. SEE EROSION MATTING SPECIFICATIONS AS REQUIRED. FOLLOW PROCEDURES FOUND IN THE OHIO EPA RAINWATER AND LAND DEVELOPMENT MANUAL.
- 3. ALL TEMPORARY SEEDING** SHALL CONSIST OF THE FOLLOWING MIXTURE: 100% RYEGRASS AT 19 LBS/1,000 S.F., STRAW AND MULCH TO BE APPLIED AT 100 LBS/1,000 S.F. FERTILIZE AS PER SOIL TEST OR APPLY 5-10-10 OR EQUIVALENT AT 5.0 LBS/1,000 S.F. SEE EROSION MATTING SPECIFICATIONS AS REQUIRED. FOLLOW PROCEDURES FOUND IN THE OHIO EPA RAINWATER AND LAND DEVELOPMENT MANUAL.
- D. SEEDED LAWN MAINTENANCE:** CONTRACTOR TO PROVIDE MAINTENANCE OF ALL LANDSCAPING FOR A PERIOD OF 90 DAYS FROM THE DATE OF INSTALLATION. AT THE END OF THE MAINTENANCE PERIOD, A HEALTHY, UNIFORM COVERAGE STAND OF GRASS SHOULD BE ESTABLISHED WITH NO WEEDS OR UNDESIRABLE PLANTS. CONTRACTOR SHALL BE RESPONSIBLE FOR THE MAINTENANCE OF THE SEEDING THROUGHOUT THE MAINTENANCE PERIOD. CONTRACTOR SHOULD RE-EVALUATE LAWS THAT DO NOT COMPLY WITH THESE REQUIREMENTS AND CONTACT MAINTENANCE PERSONNEL LAWS ARE SATISFACTORY.
- E. EROSION CONTROL:**
- 1. CONTRACTOR** TO PROVIDE EROSION CONTROL MATTING (NORTH AMERICAN GREEN S750) OR EQUIVALENT ON ALL SLOPES THAT ARE 4:1 AND GREATER. LAWN SEED SHALL BE PLACED BELOW MATTING IN ACCORDANCE WITH SEEDING REQUIREMENTS AND MANUFACTURER'S INSTRUCTIONS.
- F. TREES AND SHRUBS:** FURNISH NURSERY-GROWN TREES AND SHRUBS WITH HEALTHY ROOT SYSTEMS DEVELOPED BY TRANSPORTING OR ROOT PRUNING. PROUDLY WELL-SHAPED, FULLY BRANCHED, AND HEALTHY LOOKING STOCK. STOCK SHOULD ALSO BE FREE OF DISEASE, INJURY, OR UNDESIRABLE ROOTS, SUN SCALD, INJURIES, ABRASSIONS, AND DISFIGUREMENT. SEE THE LANDSCAPE SPECIFICATIONS FOR SPECIFIC SPECY SPECY, SIZE, AND LOCATION.
- G. TREE AND SHRUB INSTALLATION:** EXCAVATE CIRCULAR PITS WITH SIDES SLOPED INWARD. TRIM BASE LEAVING CENTER AREA BASED ON TREE OR SHRUB PORT. PLANT TREE OR SHRUB IN CENTER OF PIT WITH TOP OF BALL 1" ABOVE ADJACENT FINISHED GRADE. PLANT PLANTING SOIL MIX RATIO LAWN IN PLAYS AND TAMP TO SETTLE MIX. WATER ALL TREES THOROUGHLY. PROVIDE TEMPORARY STAKING FOR TREES AS REQUIRED. PROVIDE TEMPORARY MAINTENANCE TO ALL TREES AND SHRUBS THROUGHOUT THE MAINTENANCE PERIOD. CONTRACTOR SHALL BE RESPONSIBLE FOR THE DATE OF INSTALLATION. MAINTENANCE TO INCLUDE REGULAR WATERING AS REQUIRED FOR SUCCESSFUL PLANT ESTABLISHMENT THROUGHOUT THE MAINTENANCE PERIOD. CONTRACTOR SHALL BE RESPONSIBLE FOR THE MAINTENANCE OF THE SEEDING THROUGHOUT THE MAINTENANCE PERIOD. CONTRACTOR SHOULD RE-EVALUATE LAWS THAT DO NOT COMPLY WITH THESE REQUIREMENTS AND CONTACT MAINTENANCE PERSONNEL LAWS ARE SATISFACTORY.
- H. TREES AND SHRUBS:** FURNISH NURSERY-GROWN TREES AND SHRUBS WITH HEALTHY ROOT SYSTEMS DEVELOPED BY TRANSPORTING OR ROOT PRUNING. PROUDLY WELL-SHAPED, FULLY BRANCHED, AND HEALTHY LOOKING STOCK. STOCK SHOULD ALSO BE FREE OF DISEASE, INJURY, OR UNDESIRABLE ROOTS, SUN SCALD, INJURIES, ABRASSIONS, AND DISFIGUREMENT. SEE THE LANDSCAPE SPECIFICATIONS FOR SPECIFIC SPECY SPECY, SIZE, AND LOCATION.
- I. TREE AND SHRUB INSTALLATION:** EXCAVATE CIRCULAR PITS WITH SIDES SLOPED INWARD. TRIM BASE LEAVING CENTER AREA BASED ON TREE OR SHRUB PORT. PLANT TREE OR SHRUB IN CENTER OF PIT WITH TOP OF BALL 1" ABOVE ADJACENT FINISHED GRADE. PLANT PLANTING SOIL MIX RATIO LAWN IN PLAYS AND TAMP TO SETTLE MIX. WATER ALL TREES THOROUGHLY. PROVIDE TEMPORARY STAKING FOR TREES AS REQUIRED. PROVIDE TEMPORARY MAINTENANCE TO ALL TREES AND SHRUBS THROUGHOUT THE MAINTENANCE PERIOD. CONTRACTOR SHALL BE RESPONSIBLE FOR THE DATE OF INSTALLATION. MAINTENANCE TO INCLUDE REGULAR WATERING AS REQUIRED FOR SUCCESSFUL PLANT ESTABLISHMENT THROUGHOUT THE MAINTENANCE PERIOD. CONTRACTOR SHALL BE RESPONSIBLE FOR THE MAINTENANCE OF THE SEEDING THROUGHOUT THE MAINTENANCE PERIOD. CONTRACTOR SHOULD RE-EVALUATE LAWS THAT DO NOT COMPLY WITH THESE REQUIREMENTS AND CONTACT MAINTENANCE PERSONNEL LAWS ARE SATISFACTORY.
- J. TREES AND SHRUBS:** FURNISH NURSERY-GROWN TREES AND SHRUBS WITH HEALTHY ROOT SYSTEMS DEVELOPED BY TRANSPORTING OR ROOT PRUNING. PROUDLY WELL-SHAPED, FULLY BRANCHED, AND HEALTHY LOOKING STOCK. STOCK SHOULD ALSO BE FREE OF DISEASE, INJURY, OR UNDESIRABLE ROOTS, SUN SCALD, INJURIES, ABRASSIONS, AND DISFIGUREMENT. SEE THE LANDSCAPE SPECIFICATIONS FOR SPECIFIC SPECY SPECY, SIZE, AND LOCATION.
- K. TREE AND SHRUB INSTALLATION:** EXCAVATE CIRCULAR PITS WITH SIDES SLOPED INWARD. TRIM BASE LEAVING CENTER AREA BASED ON TREE OR SHRUB PORT. PLANT TREE OR SHRUB IN CENTER OF PIT WITH TOP OF BALL 1" ABOVE ADJACENT FINISHED GRADE. PLANT PLANTING SOIL MIX RATIO LAWN IN PLAYS AND TAMP TO SETTLE MIX. WATER ALL TREES THOROUGHLY. PROVIDE TEMPORARY STAKING FOR TREES AS REQUIRED. PROVIDE TEMPORARY MAINTENANCE TO ALL TREES AND SHRUBS THROUGHOUT THE MAINTENANCE PERIOD. CONTRACTOR SHALL BE RESPONSIBLE FOR THE DATE OF INSTALLATION. MAINTENANCE TO INCLUDE REGULAR WATERING AS REQUIRED FOR SUCCESSFUL PLANT ESTABLISHMENT THROUGHOUT THE MAINTENANCE PERIOD. CONTRACTOR SHALL BE RESPONSIBLE FOR THE MAINTENANCE OF THE SEEDING THROUGHOUT THE MAINTENANCE PERIOD. CONTRACTOR SHOULD RE-EVALUATE LAWS THAT DO NOT COMPLY WITH THESE REQUIREMENTS AND CONTACT MAINTENANCE PERSONNEL LAWS ARE SATISFACTORY.
- L. TREES AND SHRUBS:** FURNISH NURSERY-GROWN TREES AND SHRUBS WITH HEALTHY ROOT SYSTEMS DEVELOPED BY TRANSPORTING OR ROOT PRUNING. PROUDLY WELL-SHAPED, FULLY BRANCHED, AND HEALTHY LOOKING STOCK. STOCK SHOULD ALSO BE FREE OF DISEASE, INJURY, OR UNDESIRABLE ROOTS, SUN SCALD, INJURIES, ABRASSIONS, AND DISFIGUREMENT. SEE THE LANDSCAPE SPECIFICATIONS FOR SPECIFIC SPECY SPECY, SIZE, AND LOCATION.
- M. TREE AND SHRUB INSTALLATION:** EXCAVATE CIRCULAR PITS WITH SIDES SLOPED INWARD. TRIM BASE LEAVING CENTER AREA BASED ON TREE OR SHRUB PORT. PLANT TREE OR SHRUB IN CENTER OF PIT WITH TOP OF BALL 1" ABOVE ADJACENT FINISHED GRADE. PLANT PLANTING SOIL MIX RATIO LAWN IN PLAYS AND TAMP TO SETTLE MIX. WATER ALL TREES THOROUGHLY. PROVIDE TEMPORARY STAKING FOR TREES AS REQUIRED. PROVIDE TEMPORARY MAINTENANCE TO ALL TREES AND SHRUBS THROUGHOUT THE MAINTENANCE PERIOD. CONTRACTOR SHALL BE RESPONSIBLE FOR THE DATE OF INSTALLATION. MAINTENANCE TO INCLUDE REGULAR WATERING AS REQUIRED FOR SUCCESSFUL PLANT ESTABLISHMENT THROUGHOUT THE MAINTENANCE PERIOD. CONTRACTOR SHALL BE RESPONSIBLE FOR THE MAINTENANCE OF THE SEEDING THROUGHOUT THE MAINTENANCE PERIOD. CONTRACTOR SHOULD RE-EVALUATE LAWS THAT DO NOT COMPLY WITH THESE REQUIREMENTS AND CONTACT MAINTENANCE PERSONNEL LAWS ARE SATISFACTORY.
- N. TREES AND SHRUBS:** FURNISH NURSERY-GROWN TREES AND SHRUBS WITH HEALTHY ROOT SYSTEMS DEVELOPED BY TRANSPORTING OR ROOT PRUNING. PROUDLY WELL-SHAPED, FULLY BRANCHED, AND HEALTHY LOOKING STOCK. STOCK SHOULD ALSO BE FREE OF DISEASE, INJURY, OR UNDESIRABLE ROOTS, SUN SCALD, INJURIES, ABRASSIONS, AND DISFIGUREMENT. SEE THE LANDSCAPE SPECIFICATIONS FOR SPECIFIC SPECY SPECY, SIZE, AND LOCATION.
- O. TREE AND SHRUB INSTALLATION:** EXCAVATE CIRCULAR PITS WITH SIDES SLOPED INWARD. TRIM BASE LEAVING CENTER AREA BASED ON TREE OR SHRUB PORT. PLANT TREE OR SHRUB IN CENTER OF PIT WITH TOP OF BALL 1" ABOVE ADJACENT FINISHED GRADE. PLANT PLANTING SOIL MIX RATIO LAWN IN PLAYS AND TAMP TO SETTLE MIX. WATER ALL TREES THOROUGHLY. PROVIDE TEMPORARY STAKING FOR TREES AS REQUIRED. PROVIDE TEMPORARY MAINTENANCE TO ALL TREES AND SHRUBS THROUGHOUT THE MAINTENANCE PERIOD. CONTRACTOR SHALL BE RESPONSIBLE FOR THE DATE OF INSTALLATION. MAINTENANCE TO INCLUDE REGULAR WATERING AS REQUIRED FOR SUCCESSFUL PLANT ESTABLISHMENT THROUGHOUT THE MAINTENANCE PERIOD. CONTRACTOR SHALL BE RESPONSIBLE FOR THE MAINTENANCE OF THE SEEDING THROUGHOUT THE MAINTENANCE PERIOD. CONTRACTOR SHOULD RE-EVALUATE LAWS THAT DO NOT COMPLY WITH THESE REQUIREMENTS AND CONTACT MAINTENANCE PERSONNEL LAWS ARE SATISFACTORY.
- P. TREES AND SHRUBS:** FURNISH NURSERY-GROWN TREES AND SHRUBS WITH HEALTHY ROOT SYSTEMS DEVELOPED BY TRANSPORTING OR ROOT PRUNING. PROUDLY WELL-SHAPED, FULLY BRANCHED, AND HEALTHY LOOKING STOCK. STOCK SHOULD ALSO BE FREE OF DISEASE, INJURY, OR UNDESIRABLE ROOTS, SUN SCALD, INJURIES, ABRASSIONS, AND DISFIGUREMENT. SEE THE LANDSCAPE SPECIFICATIONS FOR SPECIFIC SPECY SPECY, SIZE, AND LOCATION.
- Q. TREE AND SHRUB INSTALLATION:** EXCAVATE CIRCULAR PITS WITH SIDES SLOPED INWARD. TRIM BASE LEAVING CENTER AREA BASED ON TREE OR SHRUB PORT. PLANT TREE OR SHRUB IN CENTER OF PIT WITH TOP OF BALL 1" ABOVE ADJACENT FINISHED GRADE. PLANT PLANTING SOIL MIX RATIO LAWN IN PLAYS AND TAMP TO SETTLE MIX. WATER ALL TREES THOROUGHLY. PROVIDE TEMPORARY STAKING FOR TREES AS REQUIRED. PROVIDE TEMPORARY MAINTENANCE TO ALL TREES AND SHRUBS THROUGHOUT THE MAINTENANCE PERIOD. CONTRACTOR SHALL BE RESPONSIBLE FOR THE DATE OF INSTALLATION. MAINTENANCE TO INCLUDE REGULAR WATERING AS REQUIRED FOR SUCCESSFUL PLANT ESTABLISHMENT THROUGHOUT THE MAINTENANCE PERIOD. CONTRACTOR SHALL BE RESPONSIBLE FOR THE MAINTENANCE OF THE SEEDING THROUGHOUT THE MAINTENANCE PERIOD. CONTRACTOR SHOULD RE-EVALUATE LAWS THAT DO NOT COMPLY WITH THESE REQUIREMENTS AND CONTACT MAINTENANCE PERSONNEL LAWS ARE SATISFACTORY.
- R. TREES AND SHRUBS:** FURNISH NURSERY-GROWN TREES AND SHRUBS WITH HEALTHY ROOT SYSTEMS DEVELOPED BY TRANSPORTING OR ROOT PRUNING. PROUDLY WELL-SHAPED, FULLY BRANCHED, AND HEALTHY LOOKING STOCK. STOCK SHOULD ALSO BE FREE OF DISEASE, INJURY, OR UNDESIRABLE ROOTS, SUN SCALD, INJURIES, ABRASSIONS, AND DISFIGUREMENT. SEE THE LANDSCAPE SPECIFICATIONS FOR SPECIFIC SPECY SPECY, SIZE, AND LOCATION.
- S. TREE AND SHRUB INSTALLATION:** EXCAVATE CIRCULAR PITS WITH SIDES SLOPED INWARD. TRIM BASE LEAVING CENTER AREA BASED ON TREE OR SHRUB PORT. PLANT TREE OR SHRUB IN CENTER OF PIT WITH TOP OF BALL 1" ABOVE ADJACENT FINISHED GRADE. PLANT PLANTING SOIL MIX RATIO LAWN IN PLAYS AND TAMP TO SETTLE MIX. WATER ALL TREES THOROUGHLY. PROVIDE TEMPORARY STAKING FOR TREES AS REQUIRED. PROVIDE TEMPORARY MAINTENANCE TO ALL TREES AND SHRUBS THROUGHOUT THE MAINTENANCE PERIOD. CONTRACTOR SHALL BE RESPONSIBLE FOR THE DATE OF INSTALLATION. MAINTENANCE TO INCLUDE REGULAR WATERING AS REQUIRED FOR SUCCESSFUL PLANT ESTABLISHMENT THROUGHOUT THE MAINTENANCE PERIOD. CONTRACTOR SHALL BE RESPONSIBLE FOR THE MAINTENANCE OF THE SEEDING THROUGHOUT THE

DIVISION 33 UTILITIES

33 10 00 SITE UTILITIES

- [illegible]

CONSTRUCTION SEQUENCE

PHASE	TYPE OF ACTION
1. PRE-CONSTRUCTION ACTION	1. CONTRACTOR TO CALL OUPS AT A MINIMUM OF 2 DAYS PRIOR TO CONSTRUCTION.
	2. CONTRACTOR TO FIELD VERIFY LOCATION AND DEPTH OF ALL UTILITIES WITHIN THE PROJECT AREA PRIOR TO CONSTRUCTION. NOTIFY ENGINEER OF DISCREPANCIES.
	3. PLACE ALL TEMPORARY SILT FENCE AND INLET PROTECTION.
	4. CONSTRUCT TRACKING STONE ENTRANCES AND ANY TEMPORARY CONSTRUCTION ROADWAYS AS NEEDED.
	5. CONSTRUCT PERMANENT STORMWATER DETENTION SYSTEMS AND PERMANENT STORMWATER CONVEYANCE SYSTEMS.
	6. CONSTRUCT ANY TEMPORARY STORMWATER CONVEYANCE SYSTEMS AS NEEDED.
	7. STABILIZE ALL TEMPORARY AND PERMANENT EROSION CONTROL AND STORMWATER CONVEYANCE SYSTEMS BEFORE TOPSOIL CAN BE STRIPPED.
2. CONSTRUCTION ACTION	1. SITE DEMOLITION AS REQUIRED.
	2. STRIP AND RELOCATE TOPSOIL TO THE DESIGNATED TOPSOIL STOCKPILE. FINAL LOCATION BY OWNER/CONTRACTOR. PROVIDE PERIMETER SILT FENCE UNTIL STABILIZED.
	3. BEGIN MASS EARTH WORK FOR THE BUILDING PAD AND PAVEMENT AREAS.
	4. CONSTRUCT ANY REMAINING STORMWATER CONVEYANCE SYSTEMS, AND INSTALL ALL OTHER UTILITIES ON SITE.
	5. DIG AND POUR ALL BUILDING FOOTINGS.
	6. PLACE GRAVEL FOR ALL PROPOSED PAVEMENT AREAS.
	7. TOPSOIL, SEED, AND MULCH ALL DISTURBED AREAS OUTSIDE THE BUILDING AND PROPOSED PAVEMENT AREAS.
	8. CONSTRUCT BUILDING.
	9. PAVE DRIVEWAYS AND PARKING AREAS.
	10. TOPSOIL, SEED, AND MULCH ALL OTHER DISTURBED AREAS. PLACE EROSION MATTING AS NEEDED.
3. POST CONSTRUCTION ACTION	1. CONTRACTOR TO REMOVE TEMPORARY EROSION CONTROL MEASURES UPON SITE STABILIZATION.
	2. SEE THE POST CONSTRUCTION MAINTENANCE PLAN FOR PERMANENT STORMWATER MANAGEMENT SYSTEMS.

CONTRACTOR TO FOLLOW THE EROSION CONTROL SPECIFICATIONS FOR CONSTRUCTION EROSION CONTROL INSPECTION AND MAINTENANCE.

CIVIL COVER AND SPECIFICATION SHEET



Always a Better Plan

100 Camelot Drive
Fond du Lac, WI 54935
920-926-9800
excelengineer.com

PROJECT INFORMATION

PROPOSED DEVELOPMENT FOR:
STARBUCKS & PANDA EXPRESS
LINCOLN WAY E • MASSILLON, OH 44646

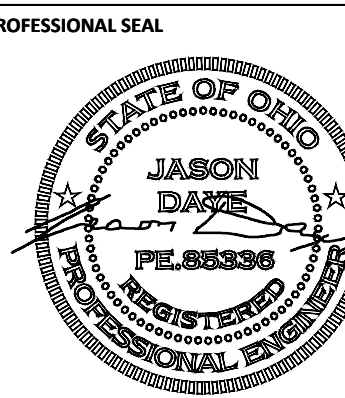

RELIMINARY DATES

AN. 20. 2023

NOT FOR CONSTRUCTION

DB NUMBER

178020

SHEET NUMBER

C0.1

24th. Street S.E. 60'

(A Public Right-of-Way)

SPECIFICATION NOTE:
SEE SHEET C0.1 FOR PLAN
SPECIFICATIONS AND REQUIREMENTS

EXISTING CONDITIONS NOTE:
EXISTING CONDITIONS SURVEY WAS PROVIDED TO EXCEL BY
ALBAN SURVEYING CO. DATED 04/20/2022. APPLICABLE SURVEY
NOTES & LEGEND ARE PROVIDED BELOW FOR REFERENCE.

SURVEY CONTACT:
JOHN ALBAN
ALBAN SURVEYING CO.
38052 EUCLID AVENUE, SUITE 200
WILLOUGHBY, OHIO 44094
216-702-7875

DEMOLITION NOTE:
DEMOLITION PLAN IS AN OVERVIEW OF DEMOLITION TO TAKE
PLACE ON SITE. CONTRACTOR TO FIELD VERIFY EXISTING SITE
CONDITIONS PRIOR TO BIDDING. CONTRACTOR SHALL REMOVE,
REPLACE, OR DEMOLISH ALL ITEMS AS NEEDED DURING
CONSTRUCTION.

UTILITY NOTES:
The size and location, both horizontal and vertical of the underground utilities
shown hereon, have been obtained by a search of available records. Verification by
field observation has been conducted where practical. This survey is subject to
change upon receipt of any additional obtainable underground utility information.
Therefore, Alban Surveying Company can not guarantee the completeness nor
accuracy thereof.
Before excavating in this area, call "OUPS" at 800-362-2764 for field locations
of any underground utility facilities.

BASIS OF BEARING:
Bearings are based on Ohio State Plane North
Zone (NAV88) by GPS observations.

NOTE:
All pins set are 5/8" x 30" rebar with yellow
cap marked "J. Alban 7651".

FLOOD ZONE INFORMATION:
The subject parcel is located in Flood Zone "X", areas determined to be
outside of the 0.2% annual chance floodplain, as shown on FEMA
#39151C0191F, with an effective date of September 14, 2018.

- Symbol Legend
- Catch Basin
 - Water Valve
 - Power Pole
 - Traffic Signal Pole
 - Storm Manhole
 - Sanitary Manhole



Always a Better Plan

100 Camelot Drive
Fond du Lac, WI 54935
920-926-9800
excelengineer.com

PROJECT INFORMATION

PROPOSED DEVELOPMENT FOR:
STARBUCKS & PANDA EXPRESS
LINCOLN WAY E • MASSILLON, OH 44646

PROFESSIONAL SEAL

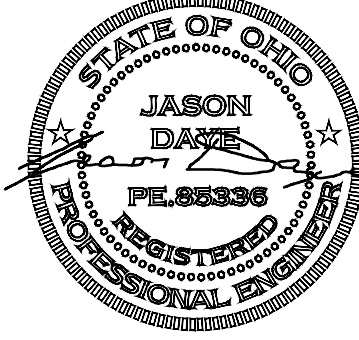

PRELIMINARY DATES

JAN. 17, 2023
JAN. 20, 2023

NOT FOR CONSTRUCTION

JOB NUMBER

2178020

SHEET NUMBER

C1.0

2021 © EXCEL ENGINEERING, INC.

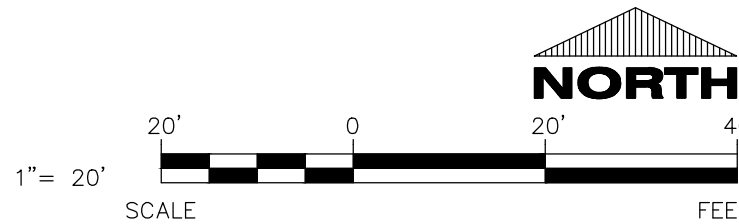

CIVIL EXISTING SITE AND DEMOLITION PLAN

24th. Street S.E. 60'
(A Public Right-of-Way)

SPECIFICATION NOTE:
SEE SHEET C0.1 FOR PLAN
SPECIFICATIONS AND REQUIREMENTS

EXCEL

Always a Better Plan

100 Camelot Drive
Fond du Lac, WI 54935
920-926-9800
excelengineer.com

PROJECT INFORMATION

PROPOSED DEVELOPMENT FOR:
STARBUCKS & PANDA EXPRESS
LINCOLN WAY E • MASSILLON, OH 44646

SITE INFORMATION:

EXISTING SITE PARCEL NUMBERS: 600764, 607402, 612594, 601670

PROPERTY AREA (TOTAL): 98,935 S.F. (2.27 ACRES)
PROPOSED PANDA SITE = 52,720 S.F. (1.21 AC)
PROPOSED STARBUCKS SITE = 46,215 S.F. (1.06 AC)

EXISTING ZONING: RM-1

PROPOSED ZONING: B-3 (REZONE COMPLETED)

PROPOSED USE: QUICK SERVE RESTAURANTS WITH DRIVE-THRU SERVICE

AREA OF SITE DISTURBANCE: 103,181 SF (2.37 AC)

SETBACKS: BUILDING: FRONT = 60'
SIDE = 10'
REAR = 20'

PAVEMENT: OFF-STREET PARKING PERMITTED IN REQUIRED YARDS

MAX. BLDG HEIGHT ALLOWED: 30'

PARKING REQUIRED: 1 SPACE PER 150 S.F. GFA

STARBUCKS: 2230 SF = 15 SPACES REQUIRED
PANDA EXPRESS: 2664 SF = 18 SPACES REQUIRED

PARKING PROVIDED:

STARBUCKS: 34 TOTAL SPACES PROVIDED; 2 HC STALLS
PANDA EXPRESS: 36 TOTAL SPACES PROVIDED; 2 HC STALLS

EXISTING SITE DATA (OVERALL DEVELOPMENT)

	AREA (AC)	AREA (SF)	RATIO
PROJECT SITE	2.27	98,935	
BUILDING FLOOR AREA	0.00	0	0.0%
PAVEMENT (ASP. & CONC.)	0.00	0	0.0%
TOTAL IMPERVIOUS	0.00	0	0.0%
LANDSCAPE/ OPEN SPACE	2.27	98,935	100.0%

PROPOSED SITE DATA (OVERALL DEVELOPMENT)

	AREA (AC)	AREA (SF)	RATIO
PROJECT SITE	2.27	98,935	
BUILDING FLOOR AREA	0.11	4,965	5.0%
PAVEMENT (ASP. & CONC.)	1.34	58,287	58.9%
TOTAL IMPERVIOUS	1.45	63,252	63.9%
LANDSCAPE/ OPEN SPACE	0.82	35,683	36.1%

CURB & GUTTER MARKING KEY:

- INVERTED CURB & GUTTER
- SHEDDING CURB & GUTTER

PAVEMENT HATCH KEY:

- STANDARD ASPHALT
- CONCRETE; SEE PLAN & C0.1 FOR DETAILS/SPECIFIED THICKNESS

SITE PLAN NOTES:

- A KNOX BOX (MODEL 3200) SHALL BE PROVIDED AT THE PRIMARY ENTRANCE TO ALL NEW BUILDINGS AT A HEIGHT OF 4'-6" FROM FINAL GRADE. COORDINATE ADDITIONAL REQUIREMENTS WITH LOCAL BUILDING INSPECTOR/FIRE DEPARTMENT AS NEEDED.
- GC TO COORDINATE WITH SITE SPECIFIC OWNER/TENANT PRIOR TO CONSTRUCTION TO REVIEW ANY ADDITIONAL SITE SPECIFIC REQUIREMENTS/SCOPES OF WORK AS NEEDED.

SITE PLAN KEYNOTES

- HEAVY DUTY ASPHALT SECTION (TYP.)
- CONCRETE SIDEWALK/PATIO (TYP.)
- LIGHT DUTY CONCRETE - PARKING AREAS ONLY (TYP.)
- HEAVY DUTY/DRIVE-THRU/DUMPSTER PAD CONCRETE (TYP.)
- CONCRETE STOOP (TYP.) SEE ARCH/STRUCT PLANS FOR FINAL LOCATIONS & DETAILS.
- RAISED WALK (TYP.)
- FLUSH WALK (TYP.)
- CURB RAMP (TYP.)
- ADA SIDEWALK RAMP (TYP.)
- 18" STANDARD CURB & GUTTER (6" CURB HEIGHT) (TYP.)
- 18" MOUNTABLE CURB & GUTTER (3" CURB HEIGHT) (TYP.)
- CURB TAPER (TYP.)
- CONCRETE TRANSFORMER PAD BY UTILITY SUPPLIER (CONTRACTOR TO VERIFY FINAL LOCATION & DESIGN PRIOR TO CONSTRUCTION)
- HANDICAP SIGN (TYP.)
- HANDICAP STALL & STRIPING PER STATE CODES.
- PRECAST CONCRETE WHEEL STOP ANCHORED TO PAVEMENT (TYP.)
- PROPOSED PYLON SIGN LOCATION (DETAILS, FINAL LOCATION, & APPROVAL BY SIGN VENDOR)
- DUMPSTER ENCLOSURE (SEE ARCH PLANS FOR DETAILS)
- 6" CONCRETE BOLLARDS (SEE DETAIL ON ARCH PLANS)
- STOP SIGN (TYP.)
- RIGHT TURN ONLY SIGN (R3-5R) (TYP.)
- DO NOT ENTER SIGN (TYP.)
- DOUBLE SIDED SIGN - STOP/DO NOT ENTER
- USER-SPECIFIC DIRECTIONAL SIGNAGE. COORDINATE WITH OWNER/TENANT
- WAVE STYLE BIKE RACK (FINAL TYPE/COLOR BY OWNER/TENANT)

- DETECTABLE WARNING PLATE
- TRAFFIC FLOW ARROWS. COLOR TO MATCH PARKING STALL STRIPING.
- PAINT STRIPING (TYP.). COLOR TO MATCH PARKING STALL STRIPING.
- REPLACE ASPHALT PAVEMENT PER CITY OF MASSILLON/OH DOT STANDARDS AS NEEDED FOR PROPOSED SITE IMPROVEMENTS. (TYP.)
- CONCRETE SIDEWALK PER LOCAL STANDARDS. (TYP.)
- VERS-A-LOK OR EQUIVALENT MODULAR BLOCK RETAINING WALL SYSTEM. COLOR/STYLE TO BE COORDINATED WITH OWNER/TENANT. REFERENCE SHEET C1.2 FOR PROPOSED WALL HEIGHTS AND C2.0 FOR GENERAL RETAINING WALL DETAIL. FINAL DESIGN DETAILS & SPECIFICATIONS BY WALL SUPPLIER. WALL DESIGNER TO ACCOUNT FOR SITE FEATURES SUCH AS LIGHT POLES, FENCES, UTILITIES, ETC NEAR OR ADJACENT TO RETAINING WALL.
- 6" TALL MINIMUM OPAQUE FENCE. FINAL COLOR/STYLE BY OWNER/TENANT. CONTRACTOR TO COORDINATE FENCING REQUIREMENTS WITH RETAINING WALL SUPPLIER AS NEEDED.
- DEDICATED MOBILE ORDER PICK-UP PARKING SPACE. COORDINATE WITH OWNER/TENANT FOR SPECIFIC SIGNAGE AND/OR PAVEMENT MARKINGS. (TYP.)
- COLUMN. (TYP.) (SEE ARCH/STRUCT PLANS FOR DETAILS)
- CANOPY. (TYP.) (SEE ARCH PLANS)
- CLEARANCE BAR. COORDINATE WITH OWNER/TENANT FOR SITE SPECIFIC DRIVE-THRU EQUIPMENT REQUIREMENTS.
- MENU BOARD & SPEAKER POST SYSTEM. COORDINATE WITH OWNER/TENANT FOR FINAL LOCATIONS, FOUNDATION DETAILS, CONDUIT REQUIREMENTS, ETC.
- CONTRACTOR TO COORDINATE WITH OWNER/TENANT FOR FINAL PATIO LAYOUT. SEE SHEET C1.2 FOR PROPOSED PATIO GRADING/DRAINAGE.
- 6" DRIVE-THRU VERTICAL CURB. (TYP.)
- 6" CURB. SEE SHEET C1.2 FOR PROPOSED GRADES.
- CONCRETE WALL. SEE ARCH/STRUCT PLANS. PROVIDE THRU-WALL DRAINAGE OPENINGS AS NEEDED TO DRAIN PATIO AREA.
- APPROXIMATE EXTENT OF UNDERGROUND DETENTION AREA. SEE SHEET C1.3.

PROFESSIONAL SEAL



PRELIMINARY DATES

DEC. 8, 2022
JAN. 10, 2023
JAN. 17, 2023
JAN. 20, 2023

JOB NUMBER

2178020

SHEET NUMBER

C1.1

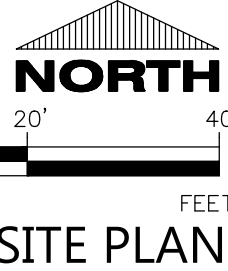

CIVIL SITE PLAN

SPECIFICATION NOTE:
SEE SHEET C0.1 FOR PLAN
SPECIFICATIONS AND REQUIREMENTS

- NOTES:
- HANDICAP STALL AND ACCESS AISLES SHALL NOT EXCEED A SLOPE OF 1.50% IN ANY DIRECTION. HANDICAP STALL & ACCESS AISLES SHALL CONFORM TO ADA REQUIREMENTS (CURRENT EDITION).
 - ALL SIDEWALKS SHALL NOT EXCEED A MAXIMUM CROSS SLOPE OF 1.50% AND RUNNING SLOPE OF 4.50% UNLESS OTHERWISE SPECIFIED.

INLET PROTECTION NOTE:

CONTRACTOR SHALL PROVIDE TEMPORARY INLET PROTECTION FOR ALL CURB INLETS & CATCH BASINS ONSITE & OFFSITE IMMEDIATELY DOWNSTREAM OF THE PROJECT SITE PER LOCAL CODE.

STABILIZED CONSTRUCTION ENTRANCE NOTE:

CONTRACTOR SHALL PROVIDE STABILIZED CONSTRUCTION ENTRANCE AT CONSTRUCTION ENTRANCE FOR PROPOSED IMPROVEMENTS AS REQUIRED PER CODE.

CONCRETE WASHOUT NOTE:

CONTRACTOR SHALL PROVIDE CONCRETE WASHOUT AS REQUIRED PER CODE. FINAL LOCATION TBD BY CONTRACTOR.

OVERALL SITE STORMWATER DISCHARGE:

PROJECT SITE WILL DISCHARGE TO CITY STORM SEWER IN 25TH STREET ROW. SITE IS WITHIN OVERALL WATERSHED OF TUSCARAWAS RIVER

EROSION/SEDIMENT CONTROL NOTE:

THE CONTRACTOR SHALL PREVENT AND/OR REDUCE AND CONTROL SOIL EROSION RESULTING FROM THE PROPOSED IMPROVEMENTS. THE USE OF SILT FENCING, JUTE MATTING, TEMPORARY SEEDING, SILT CHECKS, INLET PROTECTION AROUND ALL CATCH BASINS, STABILIZED CONSTRUCTION ENTRANCES, ETC. WILL BE REQUIRED. SEDIMENT CONTROL STRUCTURES/DEVICES SHALL BE INSTALLED IN ACCORDANCE WITH THE LATEST EDITION OF THE MANUAL RAINWATER AND LAND DEVELOPMENT - OHIO'S STANDARDS FOR STORMWATER MANAGEMENT, LAND DEVELOPMENT, AND URBAN STREAM PROTECTION. SEDIMENT CONTROL DEVICES MUST BE INSTALLED PRIOR TO BEGINNING ANY CONSTRUCTION ACTIVITY. THE CONTRACTOR SHALL BE RESPONSIBLE FOR CONTINUED INSPECTION AND MAINTENANCE OF ALL SEDIMENT CONTROL DEVICES. THE CONTRACTOR SHALL FOLLOW THE REQUIREMENTS SET FORTH ON THE APPROVED STORM WATER POLLUTION PREVENTION PLAN IF APPLICABLE, OR AS DETAILED ON THE CONSTRUCTION PLANS, AS SPECIFIED BY THE CITY OF MASSILLON.

SURVEY NOTES

BASIS OF BEARING:

Bearings are based on Ohio State Plane North Zone (NAV88) by GPS observations.

NOTE:

All pins set are 5/8" x 30" rebar with yellow cap marked "J. Alban 7651".

FLOOD ZONE INFORMATION:

The subject parcel is located in Flood Zone "X", 'areas determined to be outside of the 0.2% annual chance floodplain', as shown on FEMA #39151C0191F, with an effective date of September 14, 2018.

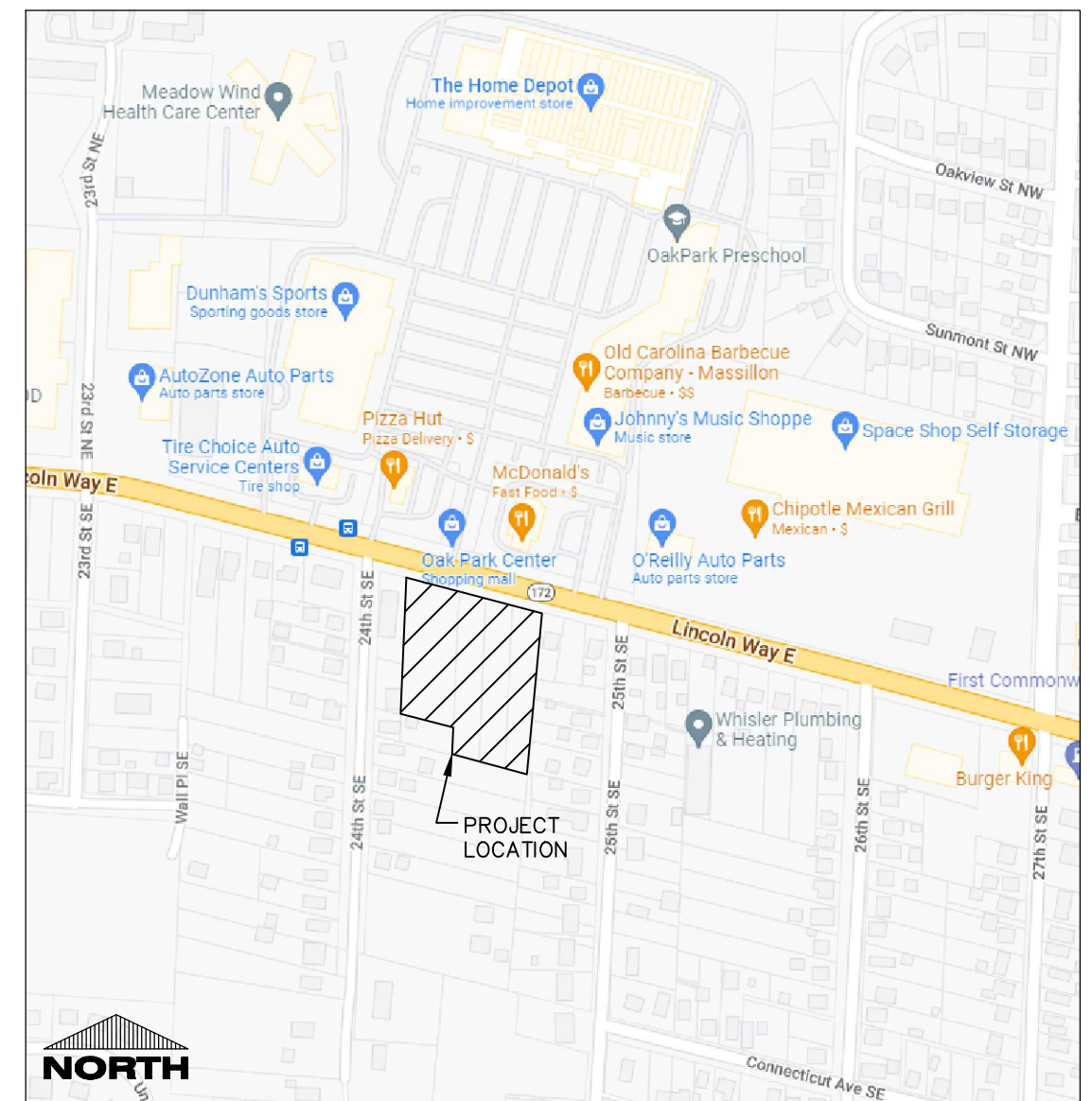

PROJECT LOCATION MAP

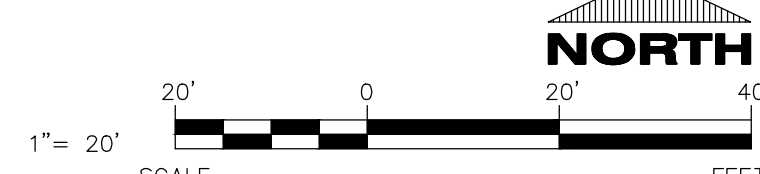

CIVIL GRADING AND EROSION CONTROL PLAN



Always a Better Plan

100 Camelot Drive
Fond du Lac, WI 54935
920-926-9800
excelengineer.com

PROJECT INFORMATION

PROPOSED DEVELOPMENT FOR:
STARBUCKS & PANDA EXPRESS
LINCOLN WAY E • MASSILLON, OH 44646



PRELIMINARY DATES

DEC. 19, 2022
JAN. 10, 2023
JAN. 17, 2023
JAN. 20, 2023

JOB NUMBER

2178020

SHEET NUMBER

C1.2

24th. Street S.E. 60'

(A Public Right-of-Way)

SPECIFICATION NOTE:
SEE SHEET C0.1 FOR PLAN
SPECIFICATIONS AND REQUIREMENTS

DOWNSPOUT NOTE:

DS = DENOTES DOWNSPOUT
LOCATIONS. MAKE CONNECTION TO DS WITH 6"
PVC ABOVE GRADE. ALL DOWNSPOUTS SHALL BE
CONNECTED TO STORM SEWER. SEE ARCH PLANS
FOR FINAL LOCATIONS.

CLEANOUT NOTE:

CO = DENOTES LOCATIONS WHERE
CONTRACTOR SHALL INSTALL CLEANOUTS, SEE
C0.1 FOR SPECIFICATION.

NOTE: EXISTING SANITARY AND WATER LATERALS
FROM PREVIOUS RESIDENTIAL HOMES MAY EXIST
ON THE SUBJECT SITE. IF THESE SERVICES ARE
ENCOUNTERED, CAP/ABANDON SERVICES PER
LOCAL STANDARDS.

UTILITY NOTE:

SITE UTILITY CONTRACTOR SHALL COORDINATE FINAL
UTILITY REQUIREMENTS, LOCATIONS, AND DEPTHS WITH
EACH SPECIFIC OWNER/TENANT'S INTERNAL PLUMBING
PLANS PRIOR TO CONSTRUCTION.

NOTE: CONTRACTOR SHALL COORDINATE WITH LANDLORD
WORK LETTER AND/OR TENANT'S FINAL CONSTRUCTION
DOCUMENT PLAN SET FOR SPECIFIC SITE REQUIREMENTS
RELATING TO THE EACH OWNER/TENANT'S SCOPES OF WORK.

NOTE: PRIOR TO COMMENCING ANY WORK WITHIN CITY ROW
OR PRIOR TO MAKING ANY UTILITY TAPS/CONNECTIONS,
CONTRACTOR SHALL CONTACT APPROPRIATE PUBLIC UTILITY
DEPARTMENTS TO FACILITATE ANY NECESSARY INSPECTIONS,
WORK IN ROW PERMITS, ETC.

NOTE: CONTRACTOR SHALL COORDINATE A PRIVATE LOCATE
TO BE COMPLETED TO LOCATE UNDERGROUND UTILITIES AS
NEEDED. EXISTING UTILITIES SHALL BE FIELD VERIFIED AND
INFORMATION PROVIDED TO THE DESIGN ENGINEER AS
NEEDED. DOWNSTREAM UTILITY CONNECTIONS MUST BE
VERIFIED PRIOR TO CONSTRUCTION. NOTIFY DESIGN ENGINEER
WITH ANY DISCREPANCIES.



Always a Better Plan

100 Camelot Drive
Fond du Lac, WI 54935
920-926-9800
excelengineer.com

PROJECT INFORMATION

PROPOSED DEVELOPMENT FOR:
STARBUCKS & PANDA EXPRESS
LINCOLN WAY E • MASSILLON, OH 44646

PROFESSIONAL SEAL



PRELIMINARY DATES

JAN. 10, 2023
JAN. 17, 2023
JAN. 20, 2023

JOB NUMBER

2178020

SHEET NUMBER

C1.3

2021 © EXCEL ENGINEERING, INC.

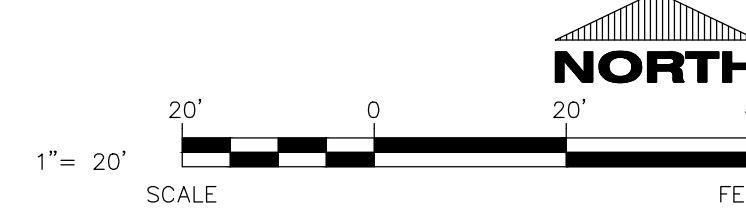

CIVIL UTILITY PLAN



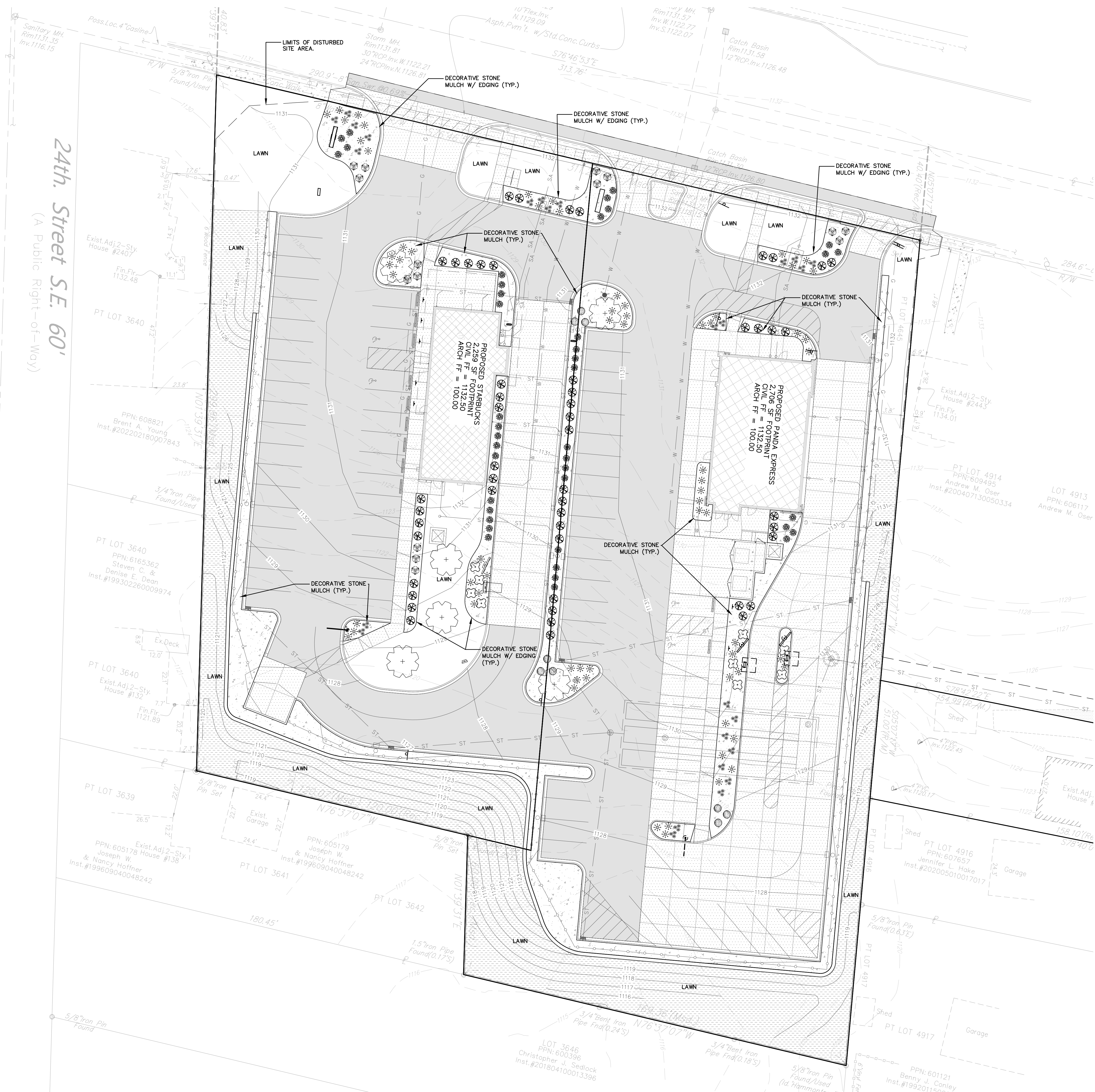

SPECIFICATION NOTE:
SEE SHEET C0.1 FOR PLAN
SPECIFICATIONS AND REQUIREMENTS

EROSION MATTING LOCATION

LANDSCAPING PLANTING SCHEDULE				
SYMBOL	COMMON NAME	BOTANICAL NAME	PLANTED SIZE	QUANTITY
DECIDUOUS TREES				
	Jack Flowering Pear	Pyrus calleryana 'Jazzam'	2" CAL	6
DECIDUOUS SHRUBS				
	Gro-Low Fragrant Sumac	Rhus aromatica 'Gro-Low'	12"-24"	9
	Knockout Rose Bush	Rosa 'Radtko'	12"-24"	15
	Little Lime Hydrangea	Hydrangea paniculata 'Jone'	12"-24"	9
	Show Off Sugar Baby	Forsythia 'Nimbus'	12"-24"	41
EVERGREEN SHRUBS				
	Taunton Yew	Tauntonii	24"	51
PERENNIALS				
	Karl Foerster Feather Reedgrass	Calamagrostis x acutiflora 'Karl Foerster'	24"	26
Landscaper to provide a variety of Grass species for diversity and disease resistance				
	Daylilies 'Stella de Oro'	Hemerocallis 'Stella de Oro'	1 gal pot	67
Landscaper to provide a variety of Daylily species for diversity and disease resistance				

NOTE: LANDSCAPE CONTRACTOR SHALL REVIEW
PROPOSED PLANTINGS WITH OWNER/TENANT PRIOR
TO INSTALLATION. PROVIDE ALTERNATE PLANTINGS OR
SUBSTITUTIONS AS DIRECTED BY THE OWNER/TENANT.

IRRIGATION NOTE: IRRIGATION SYSTEM SHALL BE
PROVIDED ONSITE IN ACCORDANCE WITH
OWNER/TENANT'S SPECIFIC IRRIGATION REQUIREMENTS.
DESIGN-BUILD LANDSCAPE IRRIGATION CONTRACTOR
SHALL BE RESPONSIBLE FOR FINAL DESIGN AND
LAYOUT OF THE IRRIGATION SYSTEM.

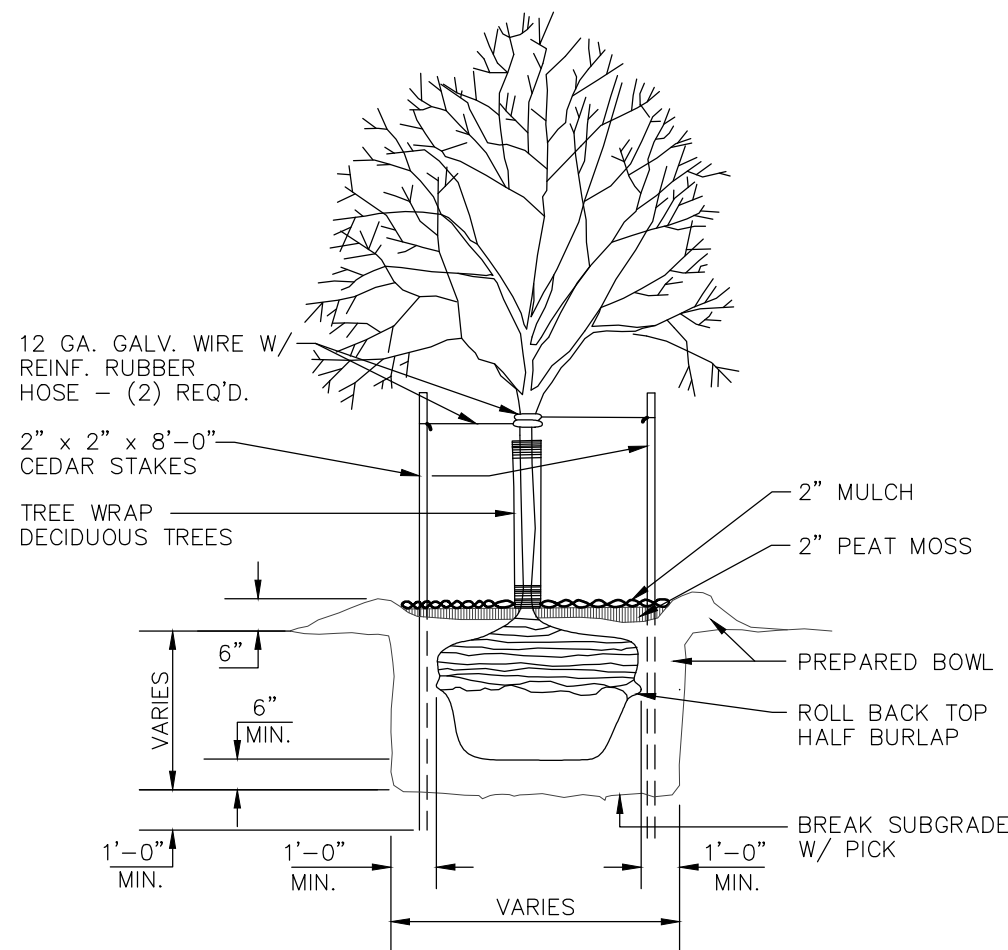

TREE PLANTING DETAIL

NO SCALE

NOTE:
FOR MASS PLANTINGS
EXCAVATE ENTIRE
BED & BACKFILL
W/ PREPARED SOIL.

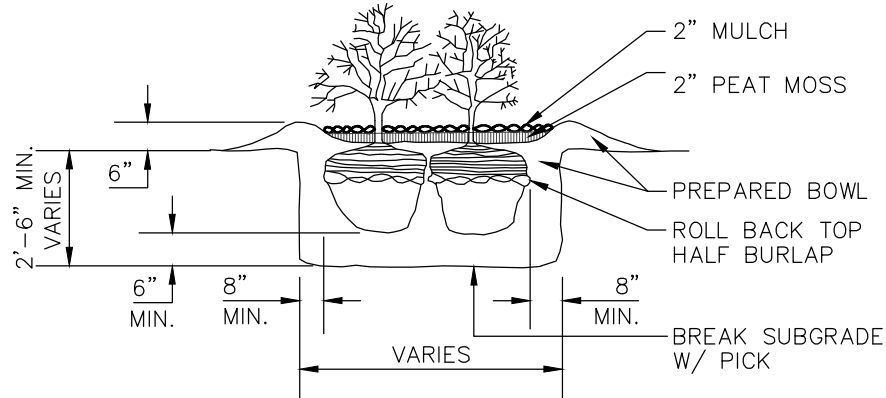

SHRUB PLANTING DETAIL

NO SCALE

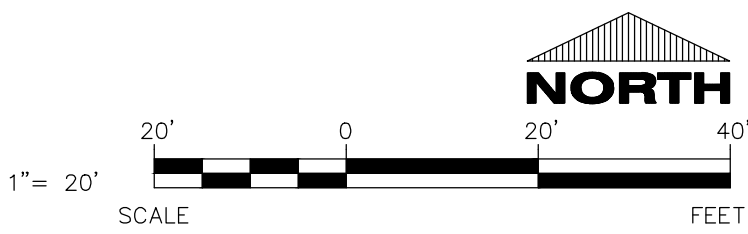

CIVIL LANDSCAPE AND RESTORATION PLAN



Always a Better Plan

100 Camelot Drive
Fond du Lac, WI 54935
920-926-9800
excelengineer.com

PROJECT INFORMATION

PROPOSED DEVELOPMENT FOR:
STARBUCKS & PANDA EXPRESS
LINCOLN WAY E • MASSILLON, OH 44646

PROFESSIONAL SEAL

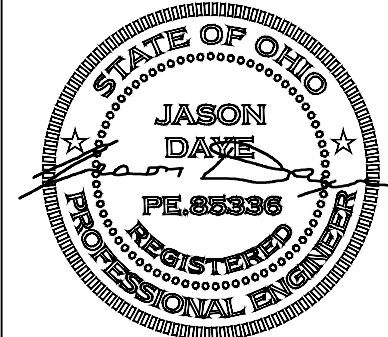

PRELIMINARY DATES

JAN. 20, 2023

NOT FOR CONSTRUCTION

JOB NUMBER

2178020

SHEET NUMBER

C1.4

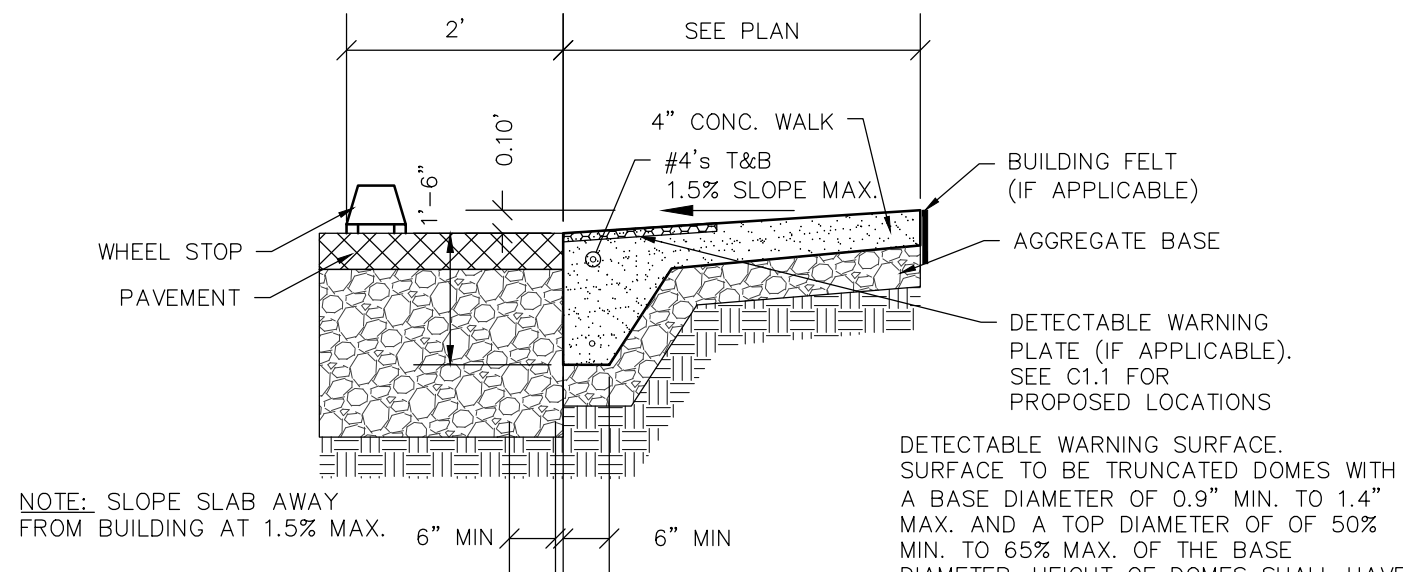

FLUSH WALK DETAIL
NO SCALE

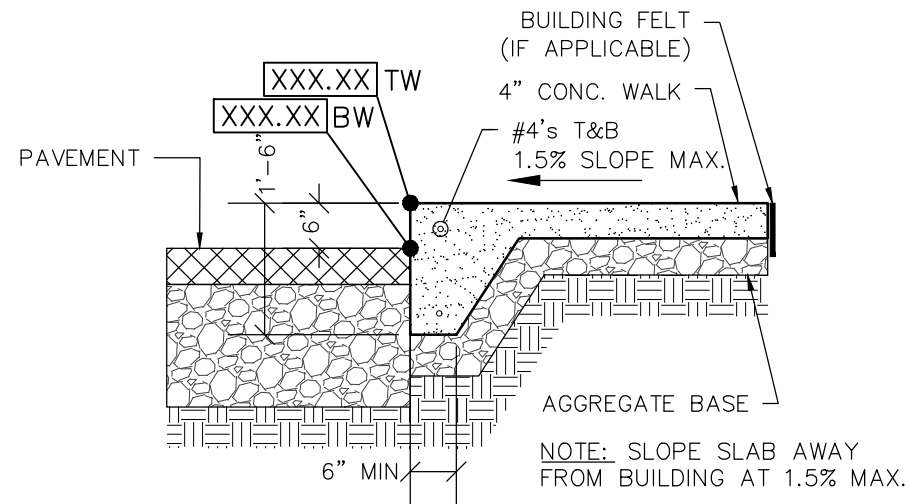

RAISED WALK DETAIL
NO SCALE

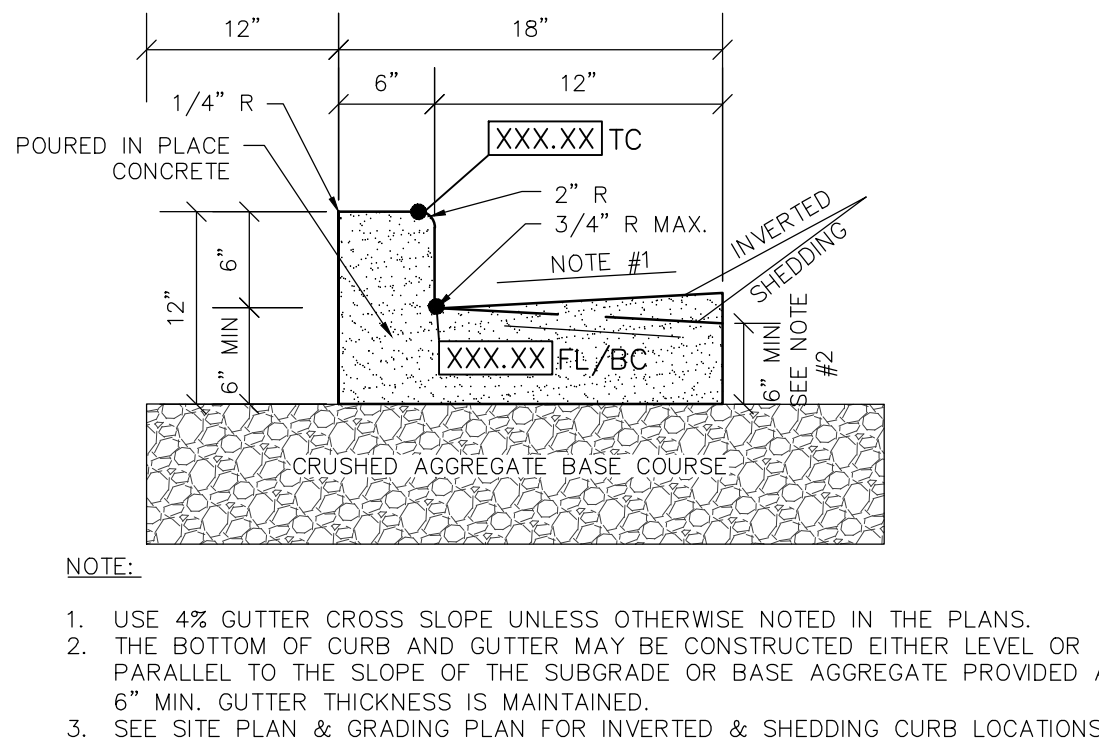

18" CONCRETE CURB & GUTTER DETAIL
NO SCALE

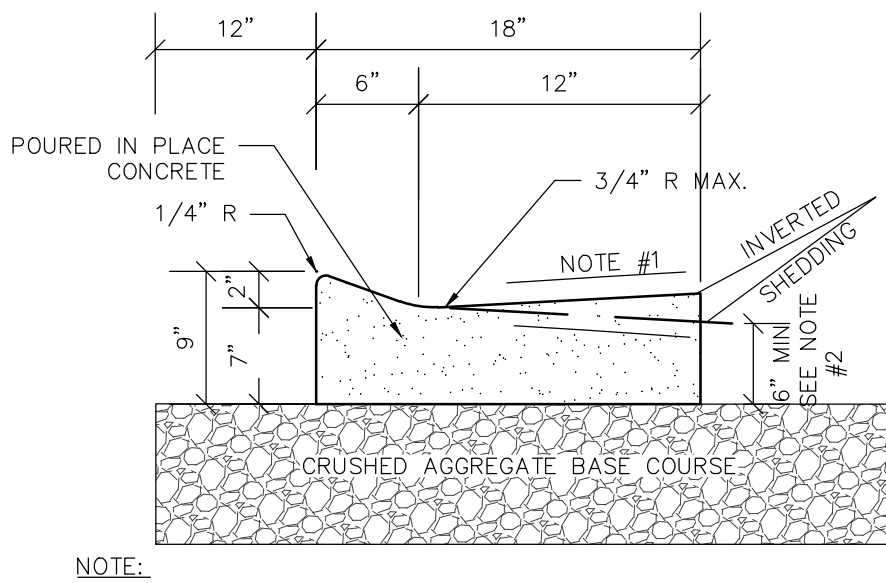

18" MOUNTABLE CURB & GUTTER DETAIL
NO SCALE

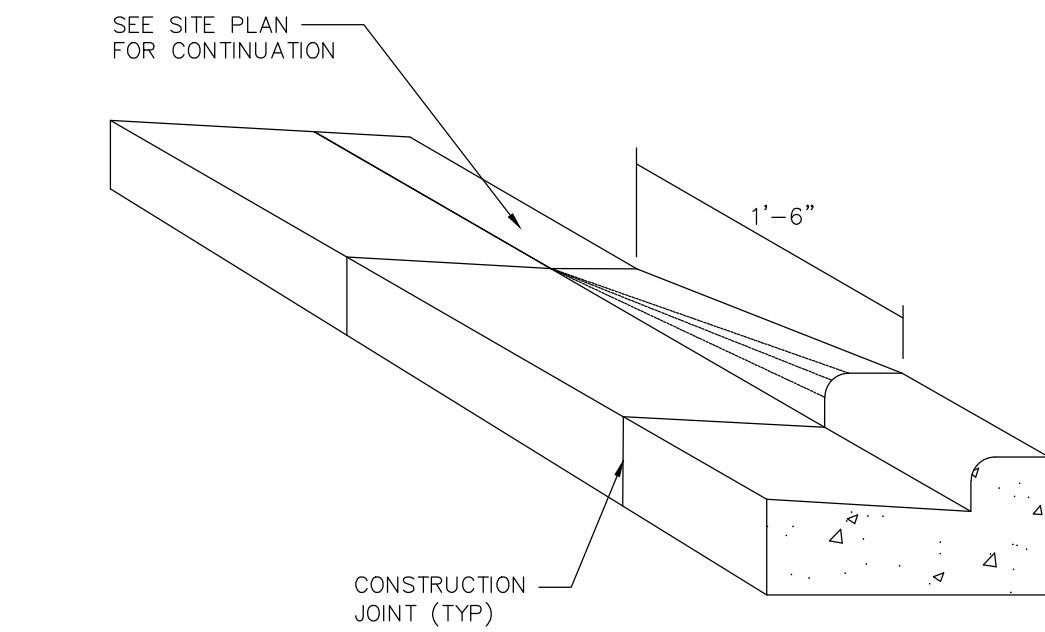

CURB TAPER DETAIL
NO SCALE

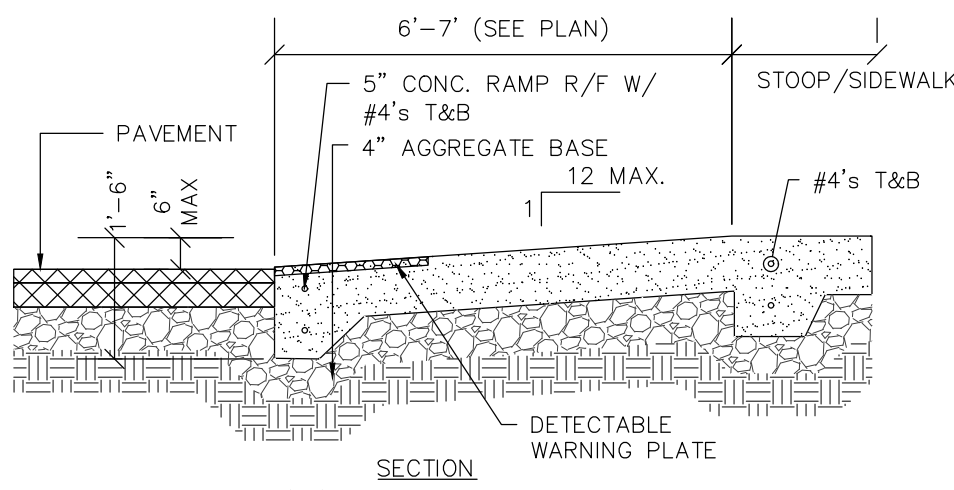

CURB RAMP DETAIL
NO SCALE

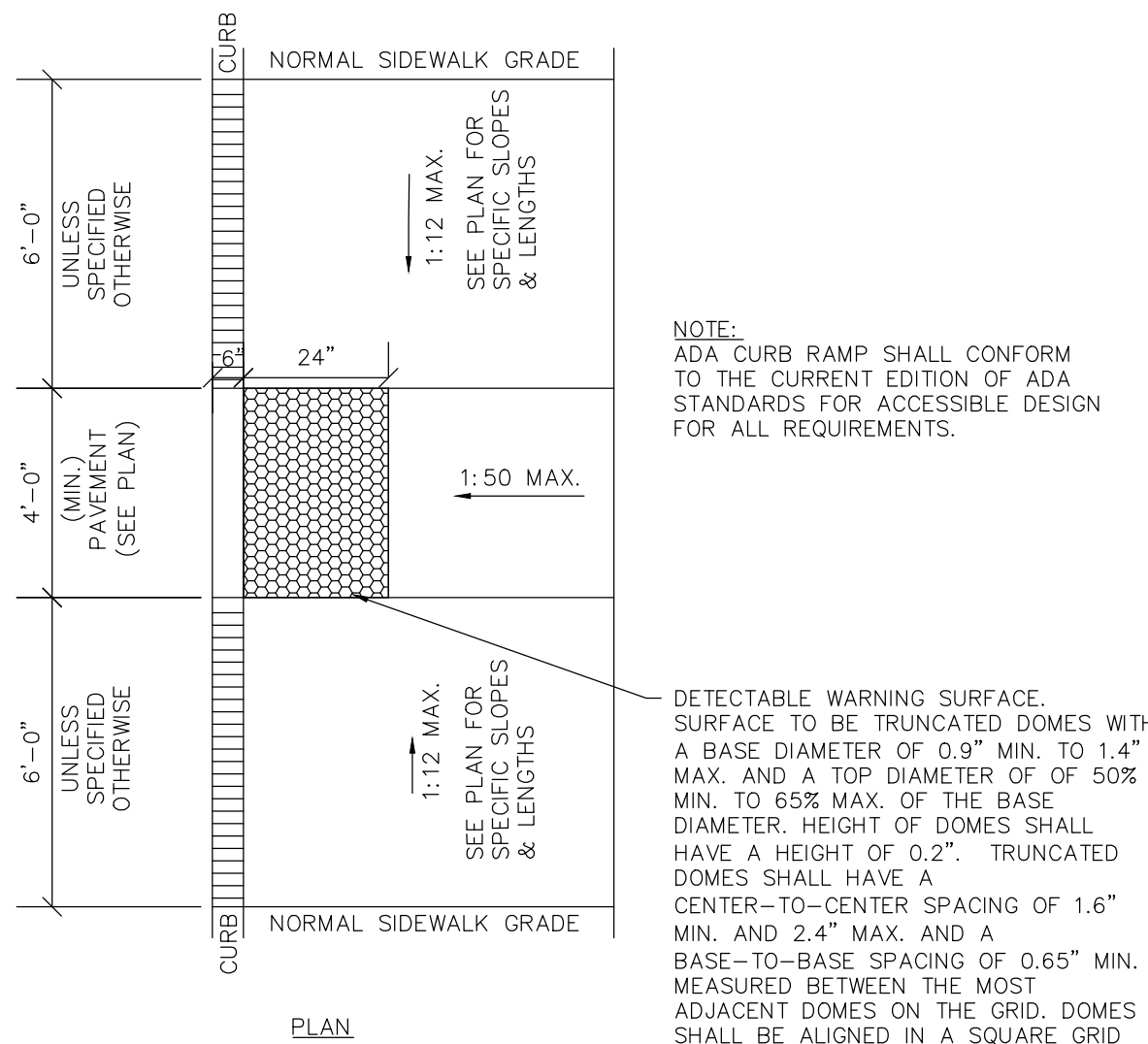

ADA SIDEWALK RAMP DETAIL
NO SCALE

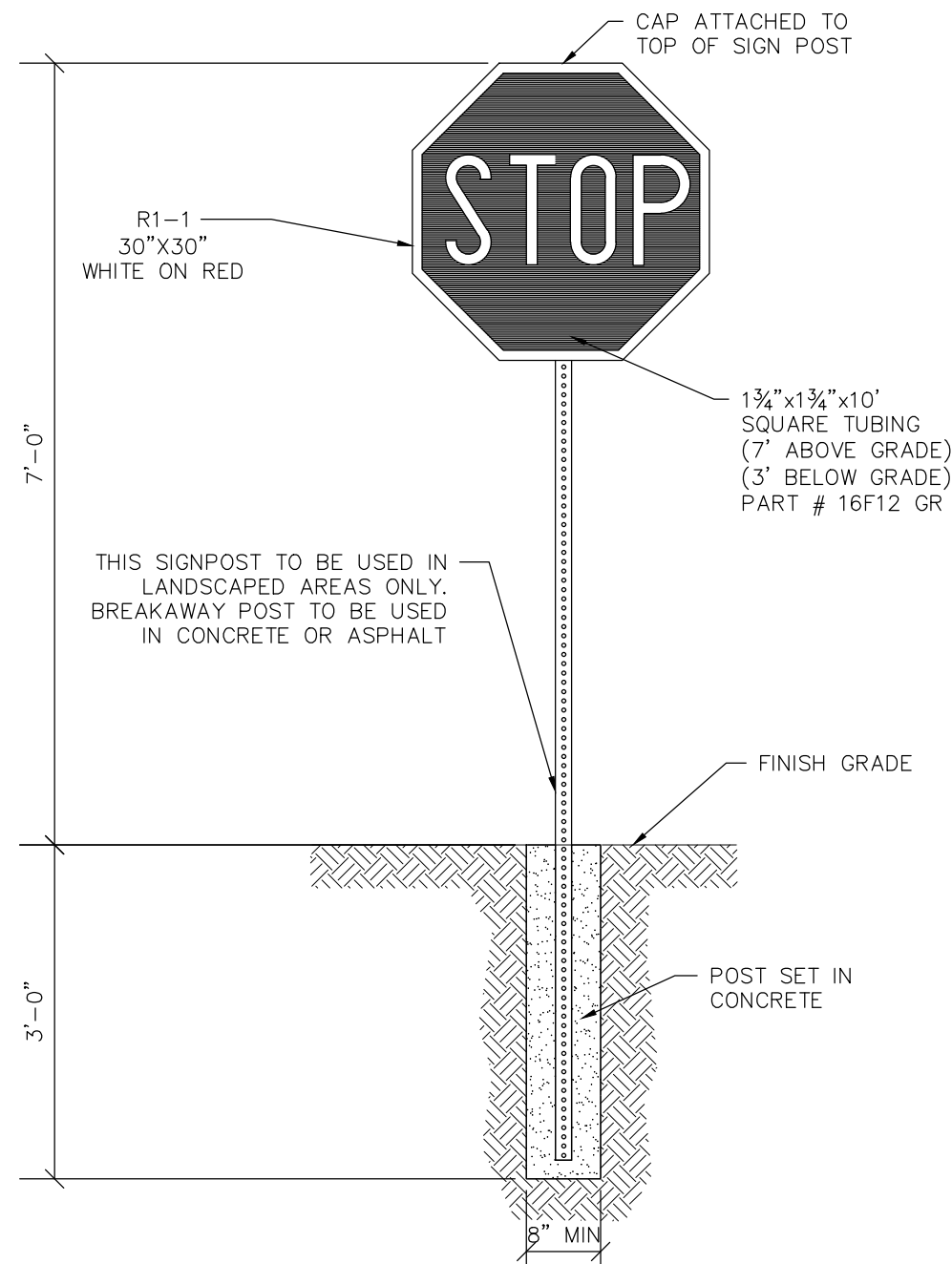

STOP SIGN WITH CONCRETE BASE DETAIL
NO SCALE

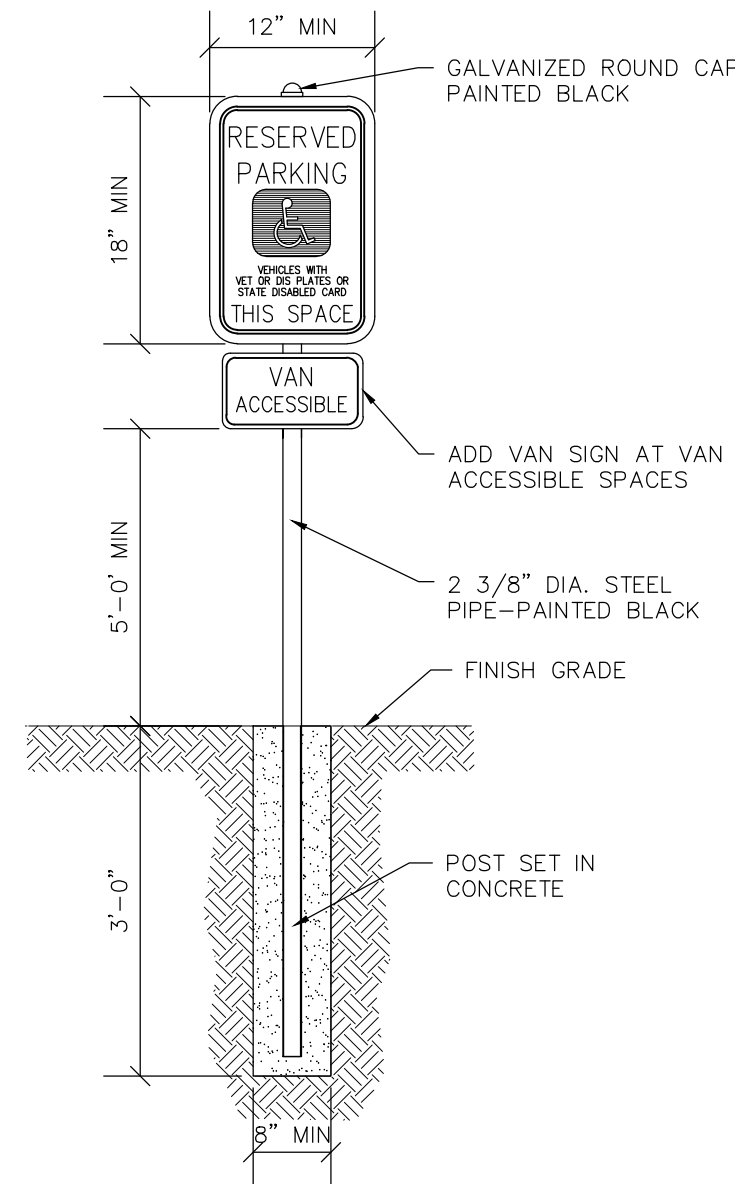

HANDICAP SIGNAGE WITH CONCRETE BASE DETAIL
NO SCALE

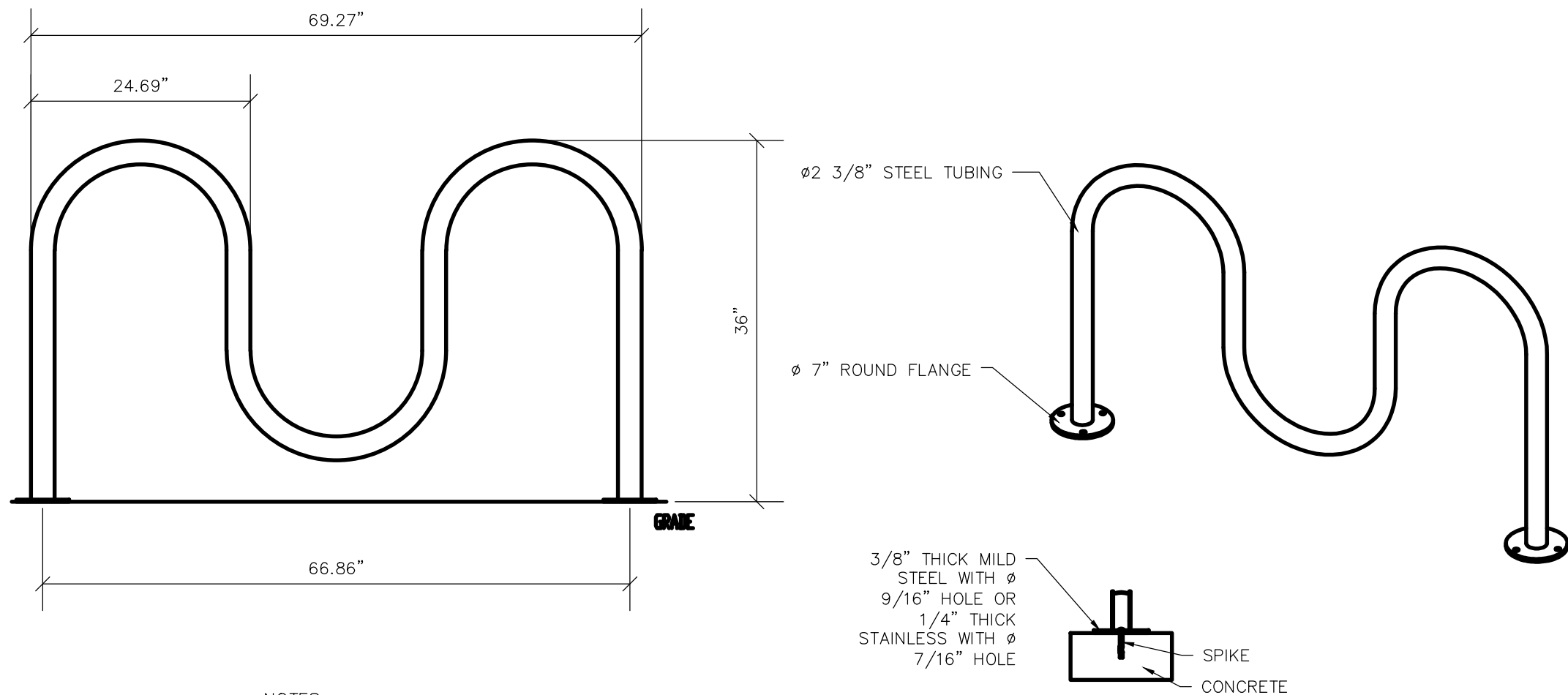

- NOTES:
1. INSTALL BIKE RACKS ACCORDING TO MANUFACTURER'S SPECIFICATIONS.
 2. OWNER SHALL SELECT COLOR & FINISH
 3. SEE SITE PLAN FOR APPROX. LOCATION. COORDINATE W/ OWNER PRIOR TO CONSTRUCTION.
 4. MANUFACTURED BY MADRAX; PRODUCT: CS200-5-10(SF); DESCRIPTION: CAPITAL SQUARE BIKE RAKE 5 BIKE

5 BIKE RACK DETAIL-WAVE TYPE
NO SCALE

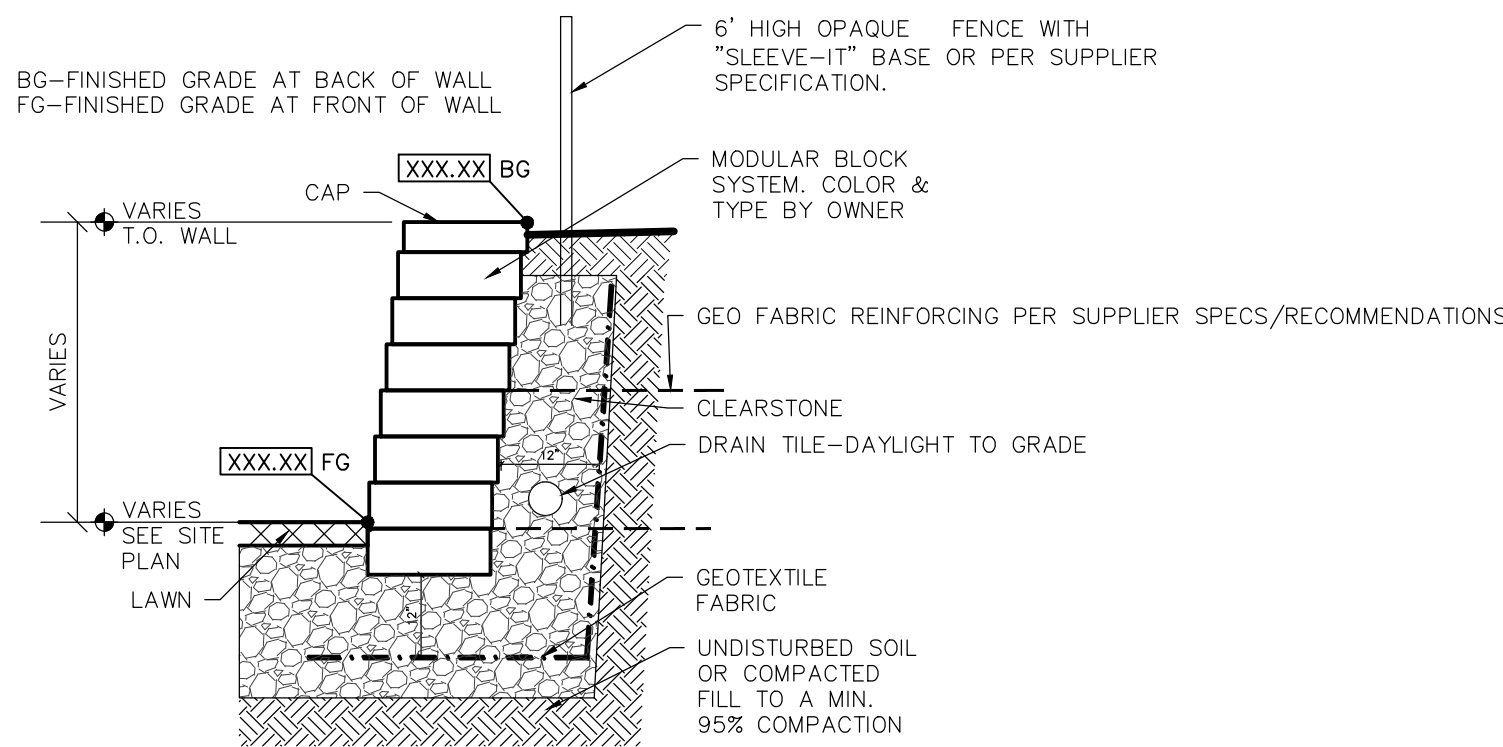

NOTE:
THIS DETAIL IS INFORMATIONAL ONLY AND IS NOT FOR CONSTRUCTION PURPOSES. THE WALL MANUFACTURER/SUPPLIER IS RESPONSIBLE FOR FINAL DESIGN AND CONSTRUCTION DETAILS. WALL DESIGNER SHALL ACCOUNT FOR SITE IMPROVEMENTS LOCATED NEAR/ADJACENT TO WALL INCLUDING FENCE, LIGHT POLES, UTILITIES, ETC (SEE PLAN FOR LOCATIONS). CONTRACTOR TO COORDINATE PROVIDING STAMPED PLANS TO AHJ AS REQUIRED.

RETAINING WALL DETAIL
NO SCALE

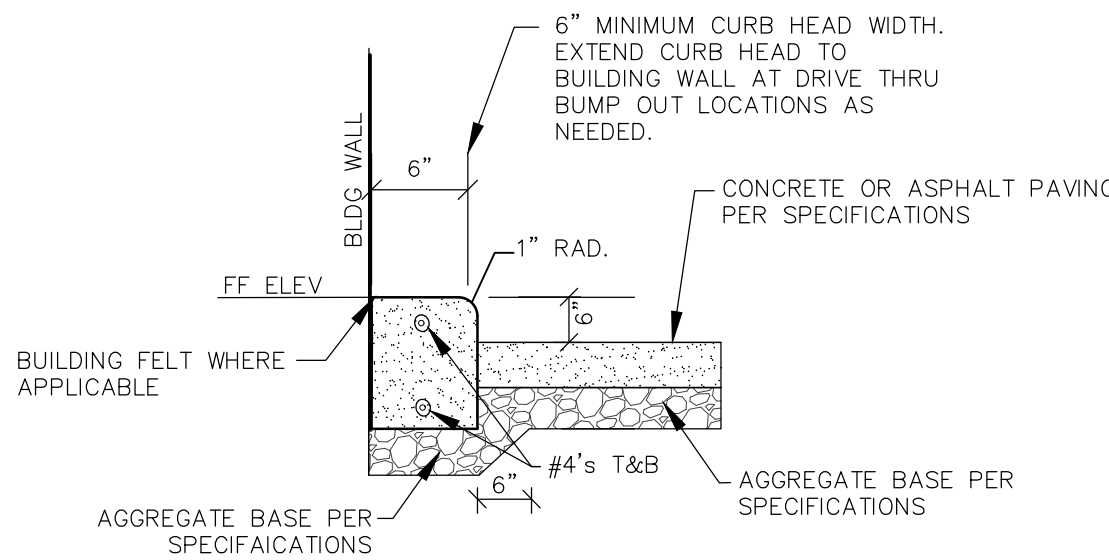

DRIVE THRU VERTICAL CURB DETAIL
NO SCALE

SPECIFICATION NOTE:
SEE SHEET C0.1 FOR PLAN SPECIFICATIONS AND REQUIREMENTS



Always a Better Plan

100 Camelot Drive
Fond du Lac, WI 54935
920-926-9800
excelengineer.com

PROJECT INFORMATION

PROPOSED DEVELOPMENT FOR:
STARBUCKS & PANDA EXPRESS
LINCOLN WAY E • MASSILLON, OH 44646

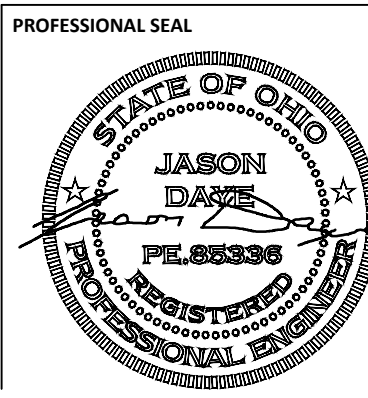

PRELIMINARY DATES

JAN. 20, 2023

NOT FOR CONSTRUCTION

JOB NUMBER

2178020

SHEET NUMBER

C2.0

SPECIFICATION NOTE:
SEE SHEET C0.1 FOR PLAN
SPECIFICATIONS AND REQUIREMENTS



Always a Better Plan

100 Camelot Drive
Fond du Lac, WI 54935
920-926-9800
excelengineer.com

PROJECT INFORMATION

PROPOSED DEVELOPMENT FOR:
STARBUCKS & PANDA EXPRESS
LINCOLN WAY E • MASSILLON, OH 44646

PROFESSIONAL SEAL



PRELIMINARY DATES

JAN. 20, 2023

NOT FOR CONSTRUCTION

JOB NUMBER

2178020

SHEET NUMBER

C2.1

CIVIL DETAILS

2021 © EXCEL ENGINEERING, INC.

