



Always a Better Plan

100 Camelot Drive
Fond du Lac, WI 54935
920-926-9800
excelengineer.com

PROJECT INFORMATION

PROPOSED SHELL BUILDING FOR:
AKG DEVELOPMENT
LINCOLN WAY E & 25TH ST SE • MASSILLON, OH 44646

PROFESSIONAL SEAL

PRELIMINARY DATES

JAN. 20, 2023

NOT FOR CONSTRUCTION

JOB NUMBER

2178020

SHEET NUMBER

A1.1

2022 © EXCEL ENGINEERING, INC.

SYMBOLS LEGEND

- EXIT SIGNAGE
- FIRE EXTINGUISHER
- COORDINATE NUMBER & LOCATION w/ FIRE MARSHALL / TENANT
- DS
- TYP. DOWNSPOUT
- SEE DETAIL 4/A1.3
- STUD WALL
- EIFS VANNER
- MASONRY VENEER
- C.M.U. WALL
- DOOR MARK
- SEE DOOR SCHEDULE
- NEW DOOR

GENERAL NOTES

- ALL ITEMS TO BE COMPLETED PER SPECIFICATIONS AND GENERAL NOTES, UNLESS NOTED OTHERWISE.
- ALL INTERIOR DIMS. ARE FROM FACE-OF-STUD TO FACE-OF-STUD.
- ALL PERIMETER WALLS TO BE 2x4 OR 2x6 WOOD STUDS @ 16" OC (SEE FLOOR PLAN FOR SIZE) W/ 5/8" GYP. BOARD (GYP. BOARD TO BE BY TENANT) - EXTEND TO BOTTOM CHORD OF TRUSSES.
- ALL FUTURE TENANT INTERIOR WALLS TO BE PART OF A SEPARATE SUBMITTAL AND DRAWING PACKAGE. BUILDING SHELL CONTRACTOR TO COORDINATE ANY BLOCKING, CONDUITS, PENETRATIONS, ETC. WITH FINAL TENANT BUILD-OUT DOCUMENTS PRIOR TO APPLYING EXTERIOR WALL FINISH GYP. BD.
- COORDINATE ALL UNDER-SLAB CONSTRUCTIONS WITH TENANTS PRIOR TO POURING FLOOR SLAB (3 WEEK NOTICE REQ'D.).
- ALL INTERIOR METALS TO HAVE (1) COAT INTERIOR METAL PRIMER AND (2) COAT FINISH PAINT (INTERIOR SEMI-GLOSS ALYKD ENAMEL).
- CONTRACTOR SHALL PROVIDE PRODUCTS COMPLETE WITH ACCESSORIES, TRIM, FINISH, FASTENERS AND OTHER ITEMS NEEDED FOR A COMPLETE INSTALLATION AND INDICATED USE AND EFFECT.
- REFERENCE TO MATERIALS OR SYSTEMS HEREIN BY NAME, MAKE, OR CATALOG NUMBER IS INTENDED TO ESTABLISH A STANDARD QUALITY, AND NOT TO LIMIT COMPETITION, AND THE WORDS "OR APPROVED EQUIVALENT" ARE IMPLIED FOLLOWING EACH BRAND NAME "OR APPROVED EQUAL". MATERIALS SHALL BE APPROVED BY ARCHITECT PRIOR TO ACCEPTANCE FOR USE.
- ALL EXPOSED CONCRETE FLOOR SLAB TO RECEIVE (1) COAT 'SYMMONS CORPORATION' CURE & SEAL.
- KNOX BOX, IF REQUIRED, CONTACT FIRE DEPT FOR PURCHASE INSTRUCTIONS AND PROPER MOUNTING LOCATION TO BUILDING.
- FLOOR FLATNESS TO MAINTAIN 1/8" PER 10'-0"
- ANY ATTIC COMPARTMENTALIZATION NEEDED WOULD BE COMPLETED AT TIME OF INTERIOR BUILD-OUT

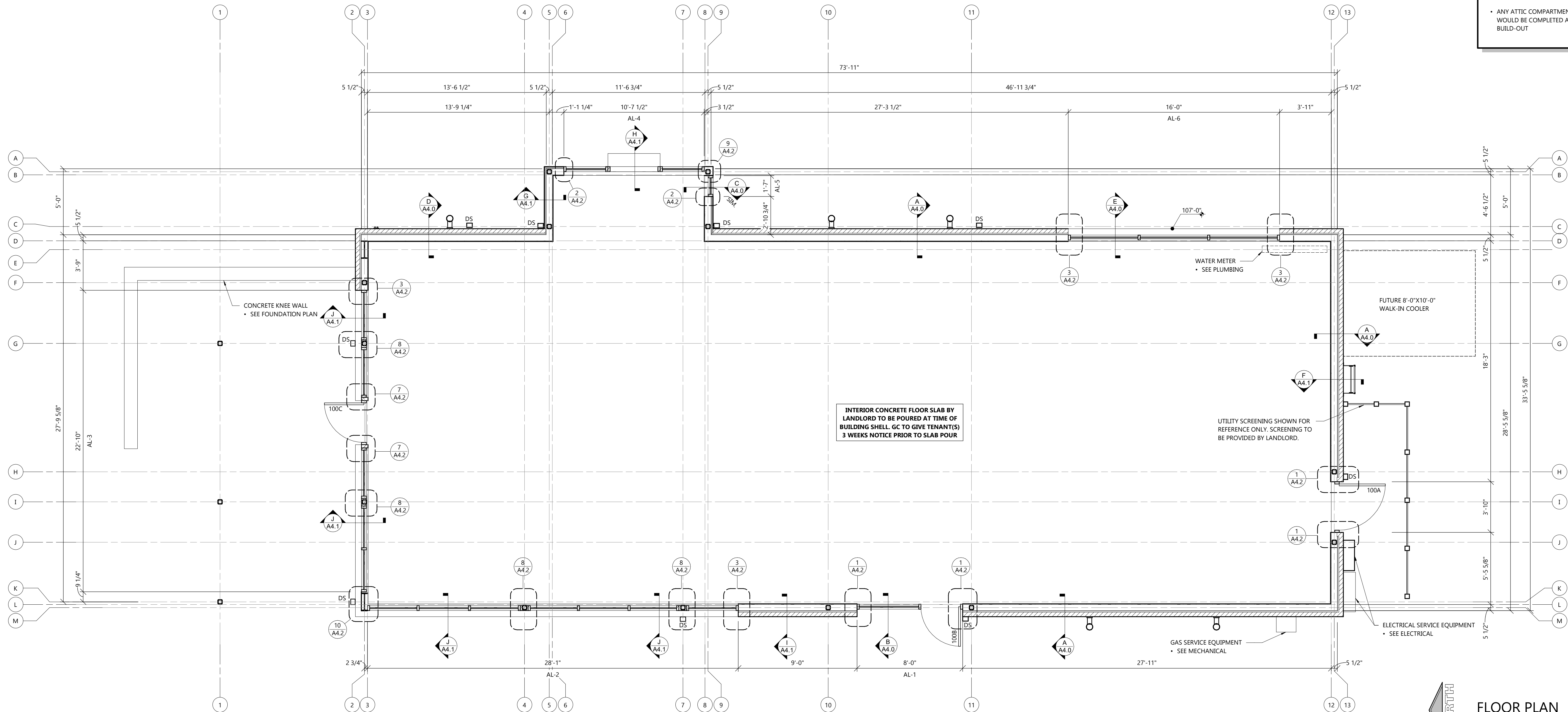

FLOOR PLAN

SCALE: 1/4" = 1'-0"

ARCHITECTURAL FLOOR PLAN