

4\"/>

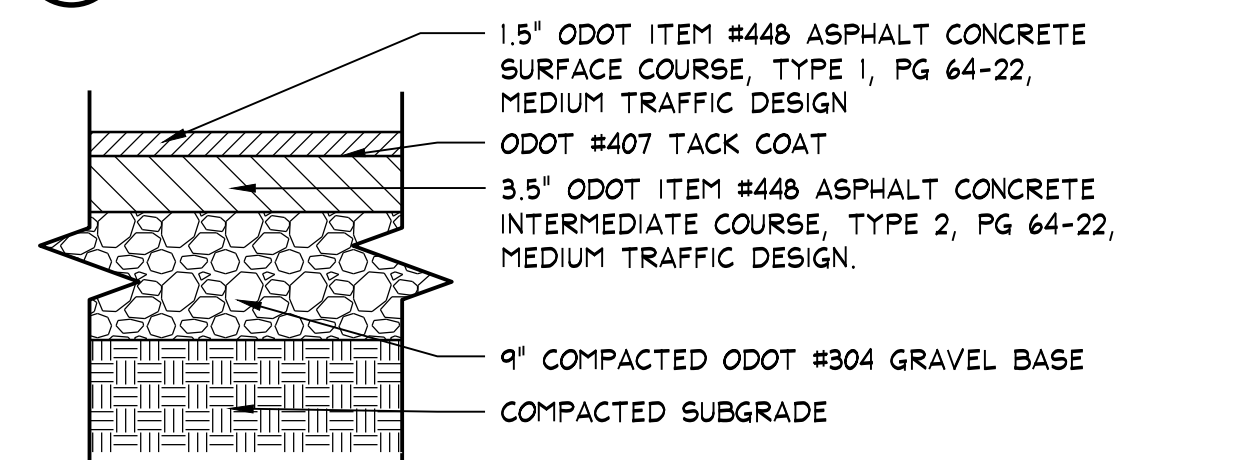

HEAVY DUTY ASPHALT PAVEMENT

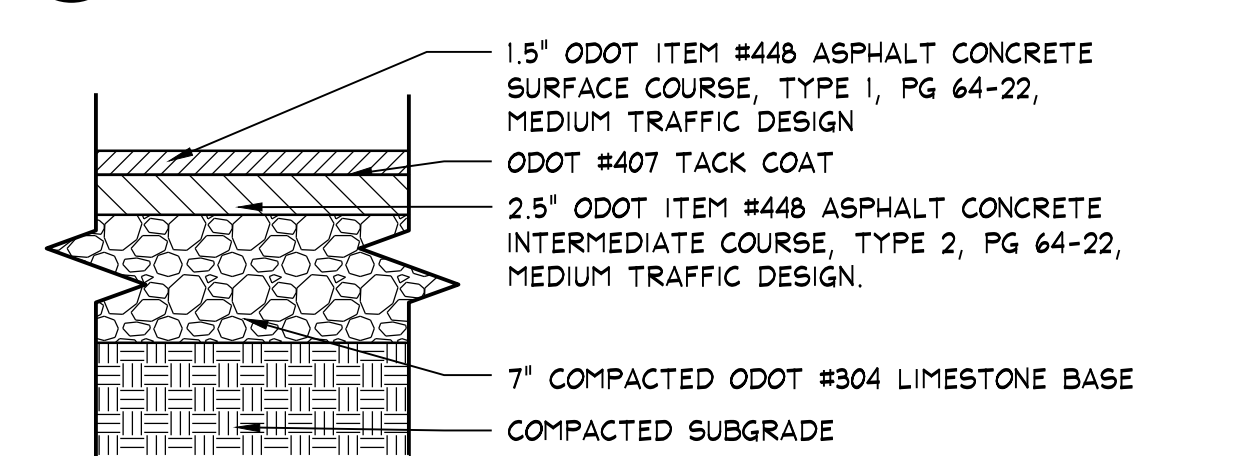

STANDARD DUTY ASPHALT PAVEMENT

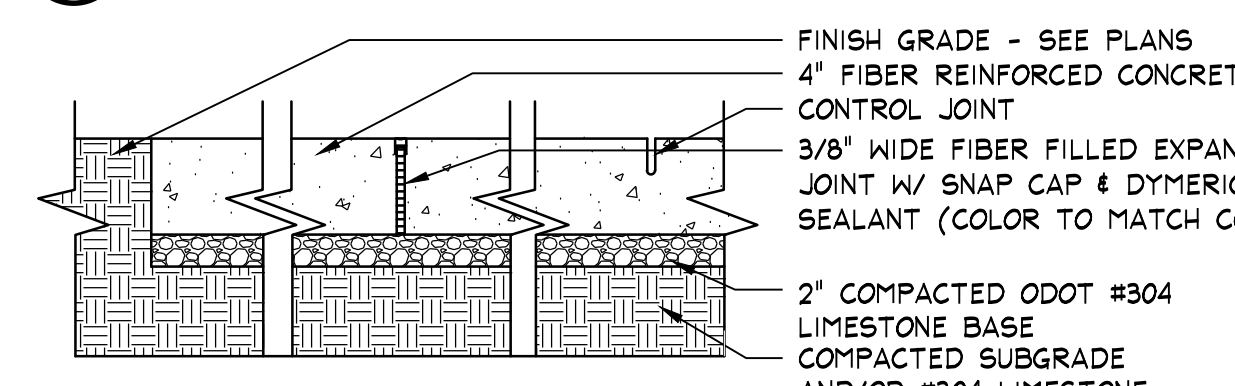

STANDARD DUTY CONC. PAVEMENT

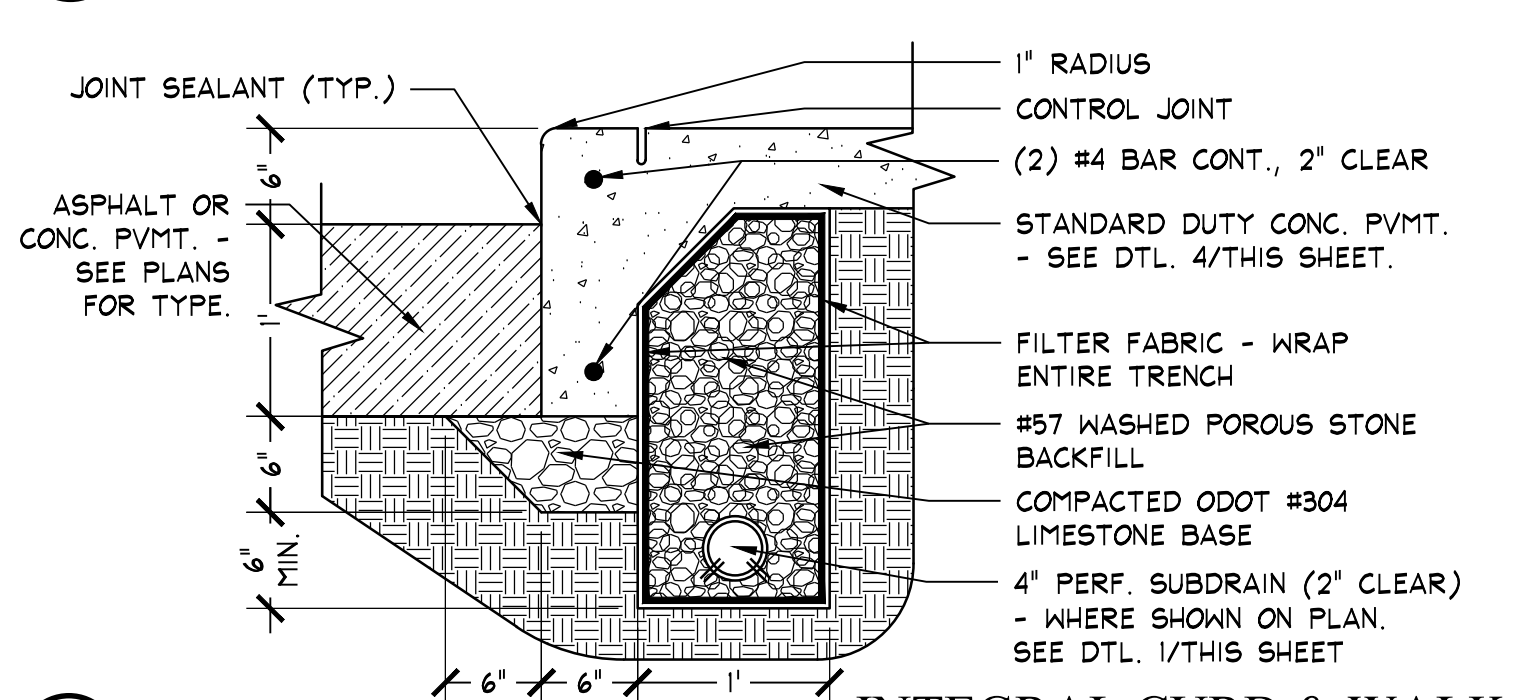

INTEGRAL CURB & WALK

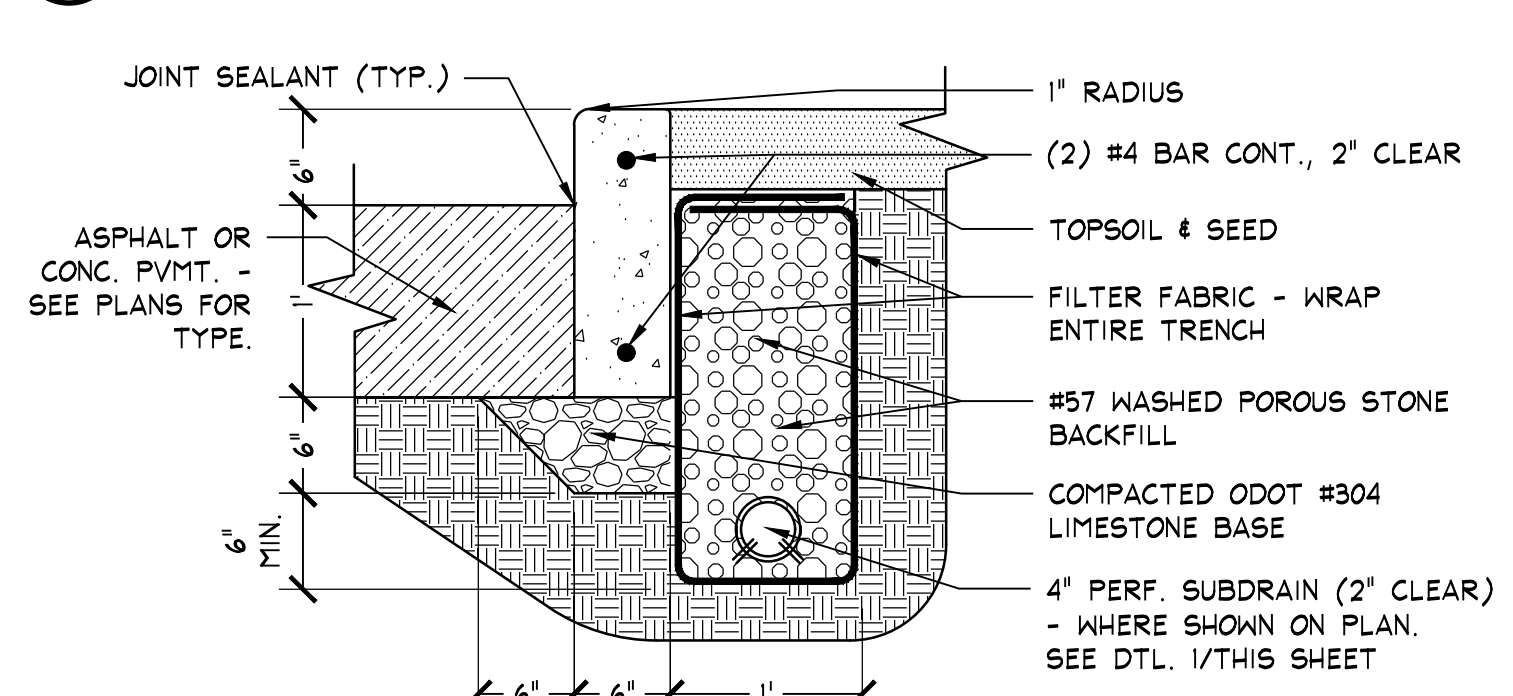

6\"/>

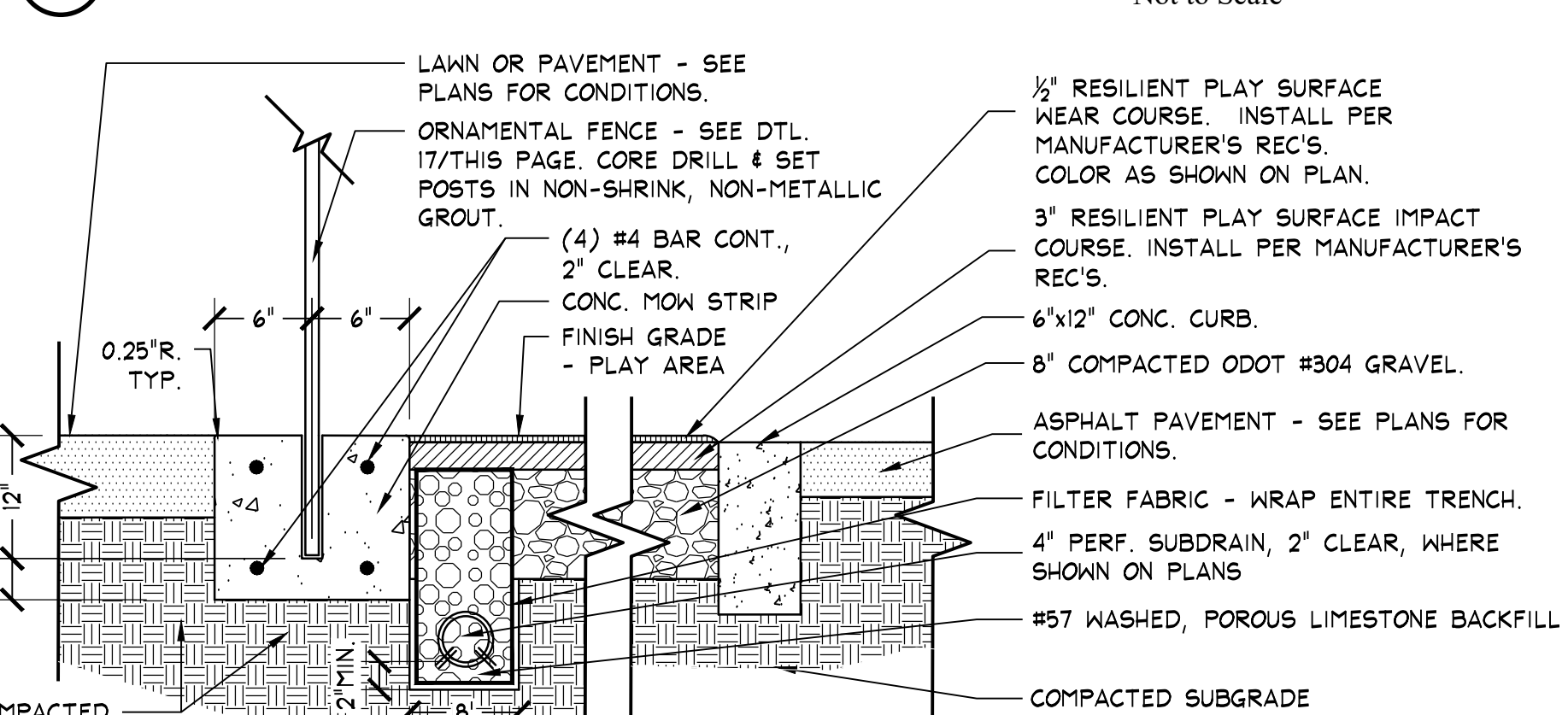

POURED IN PLACE RUBBER PLAY SURFACE

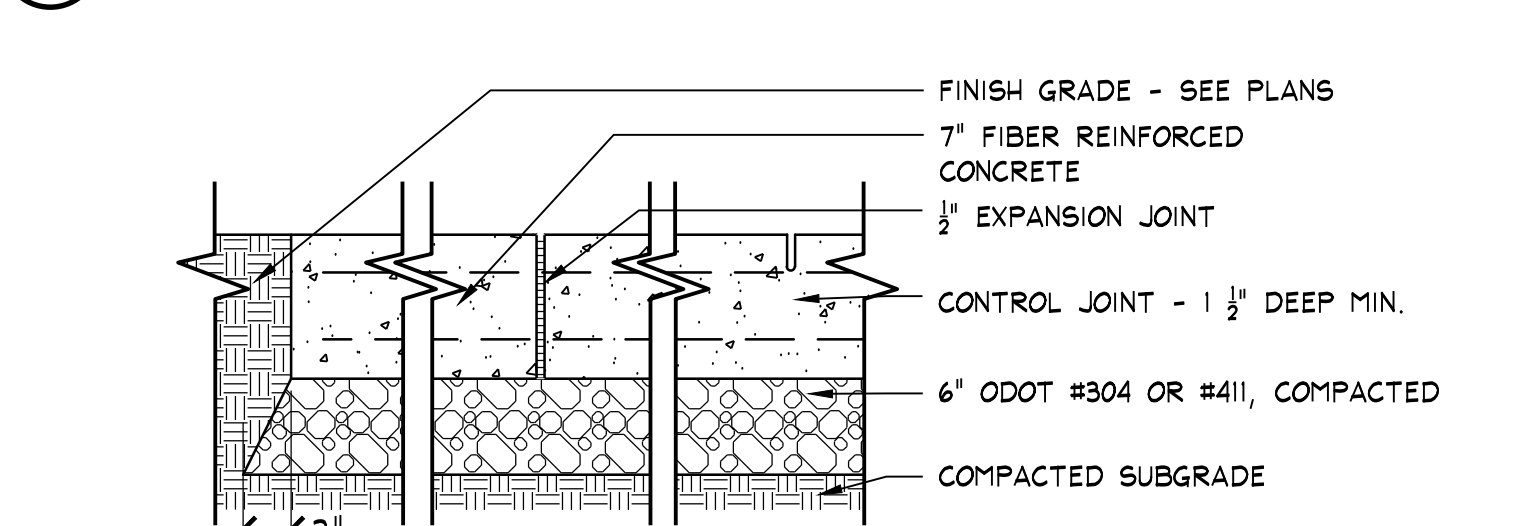

HEAVY DUTY CONCRETE PAVEMENT

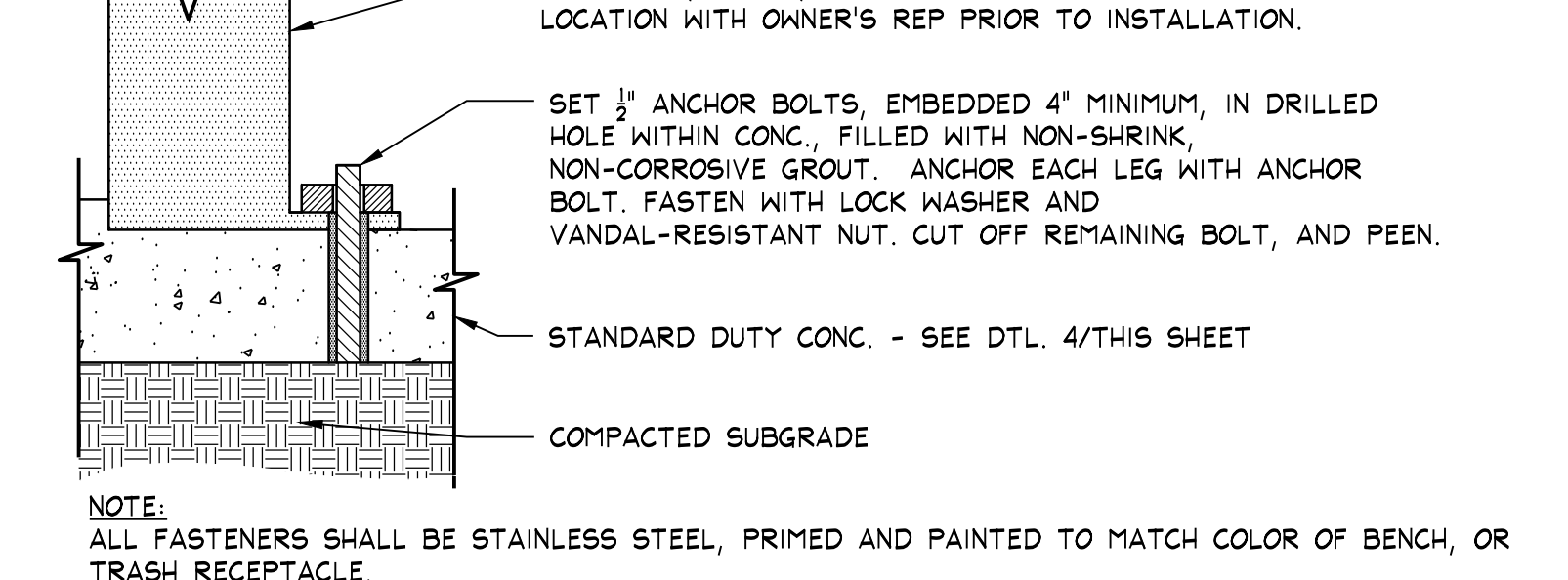

BIKE RACK, BENCH, TRASH RECEPTACLE

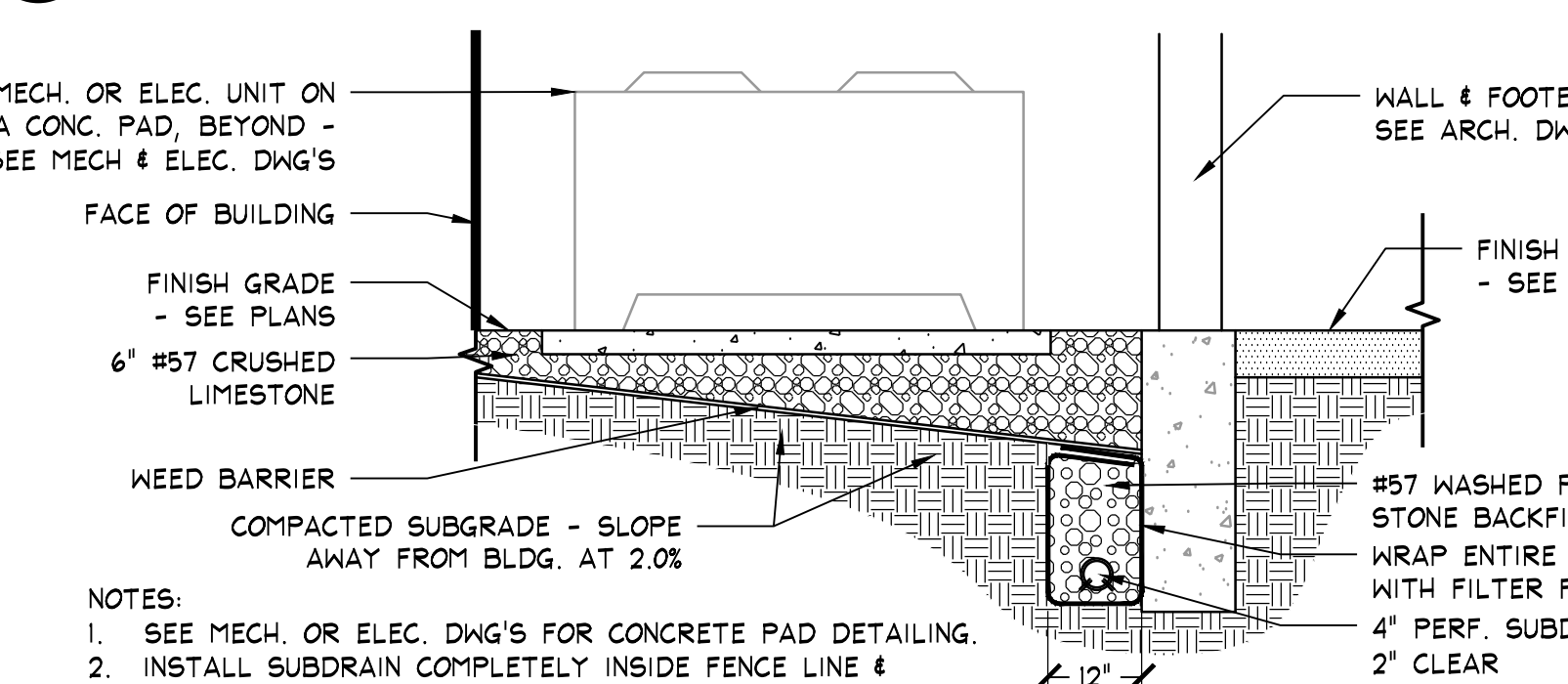

GRAVEL BED

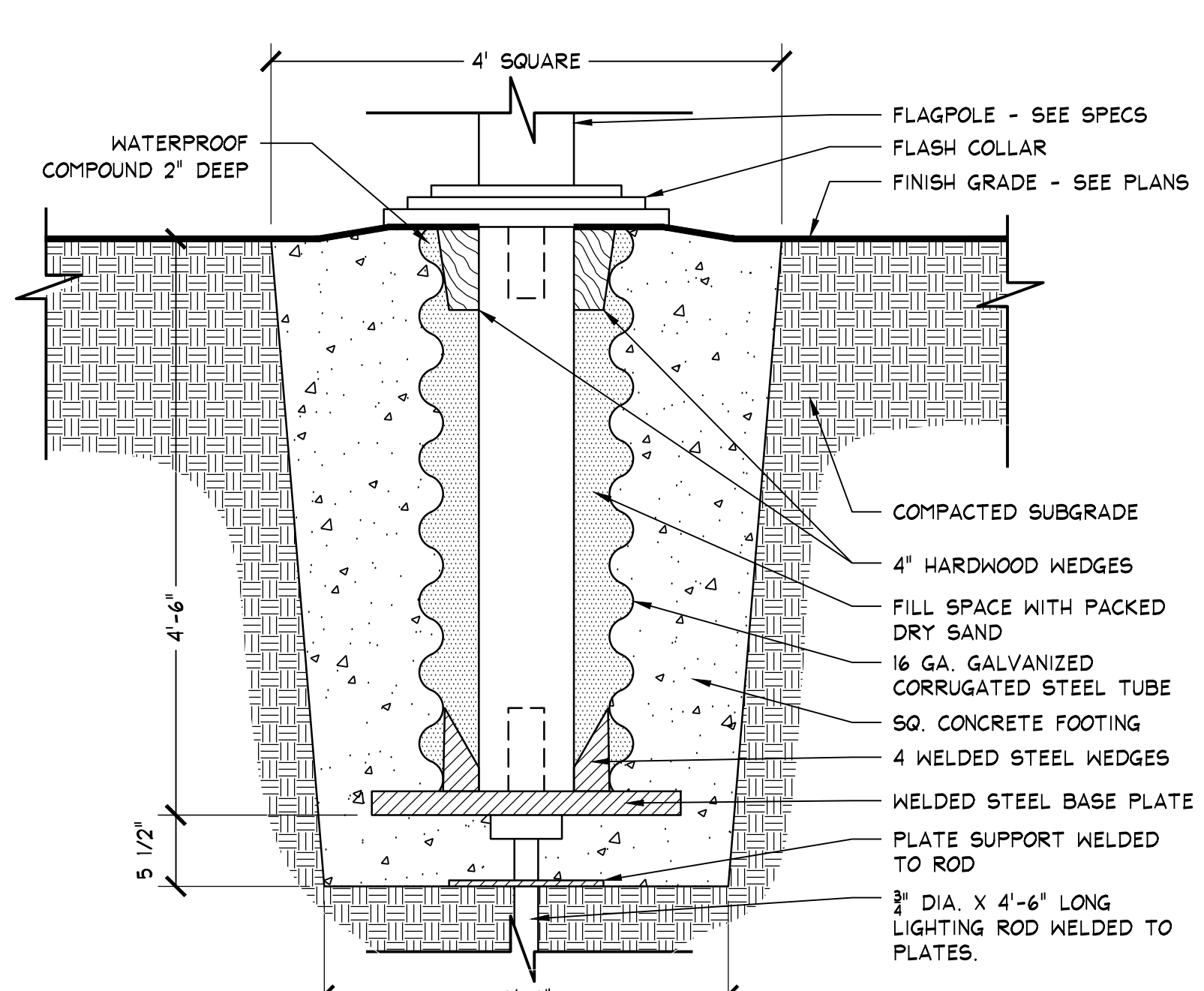

FLAG POLE

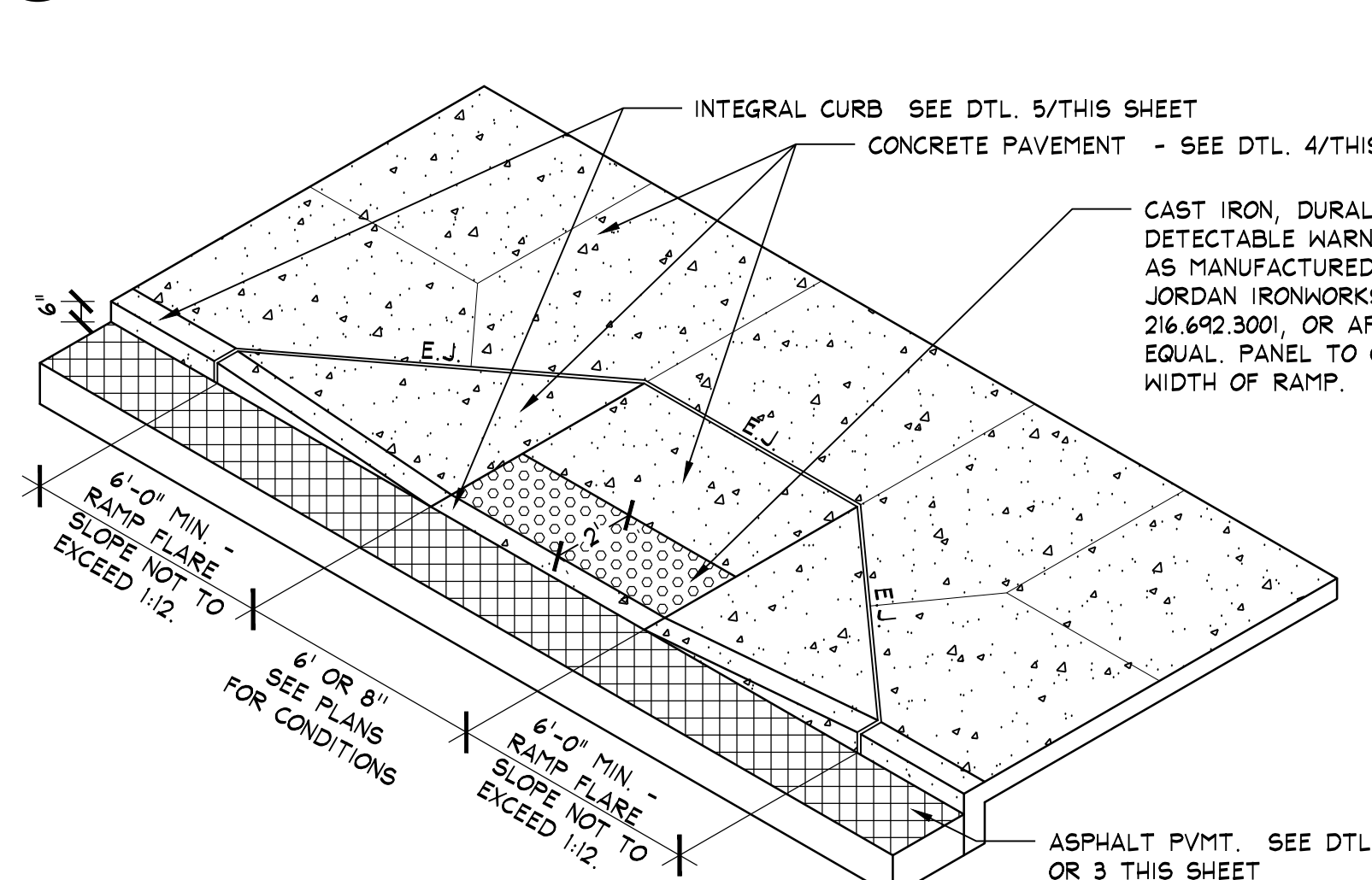

CURB RAMP TYPE 1

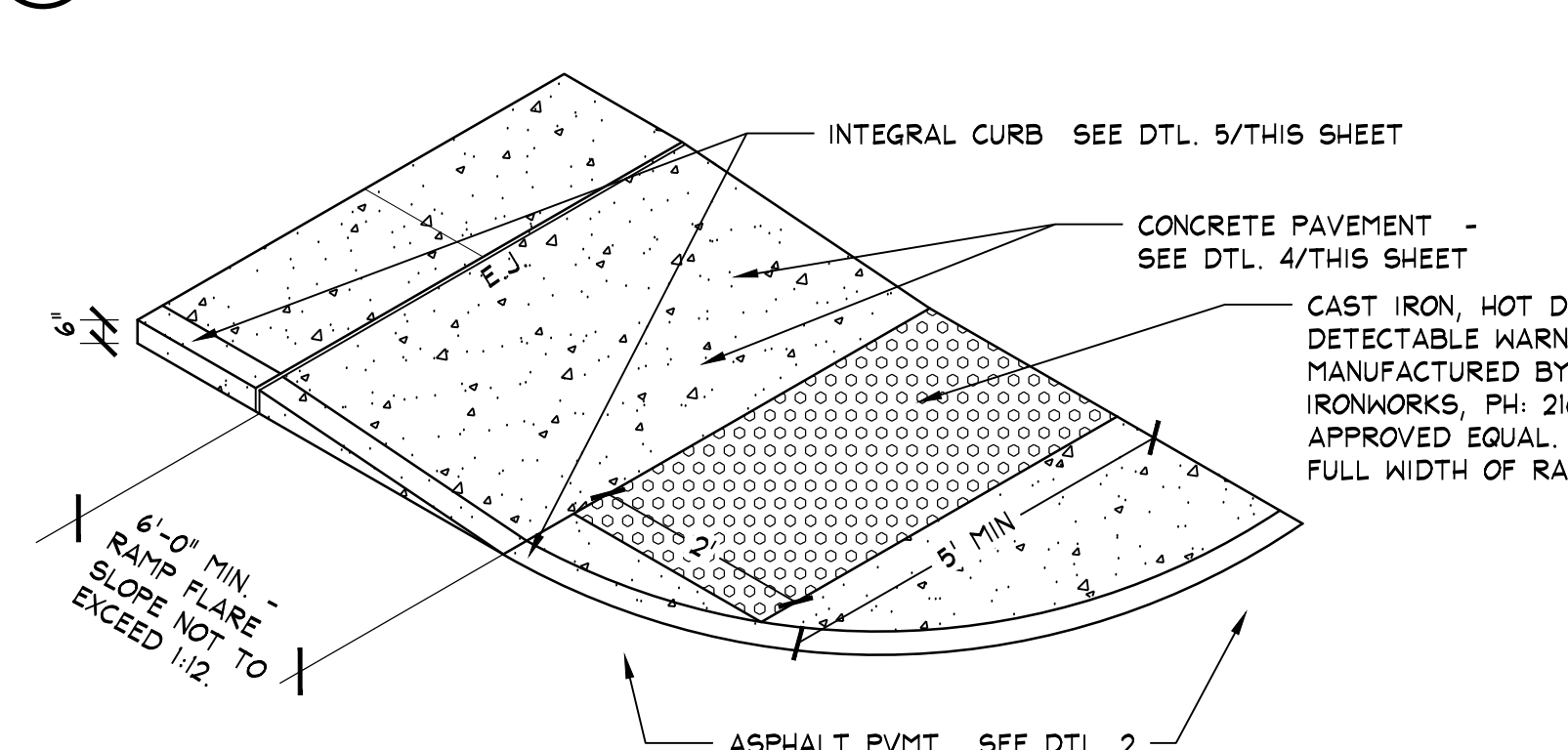

CURB RAMP, TYPE 2

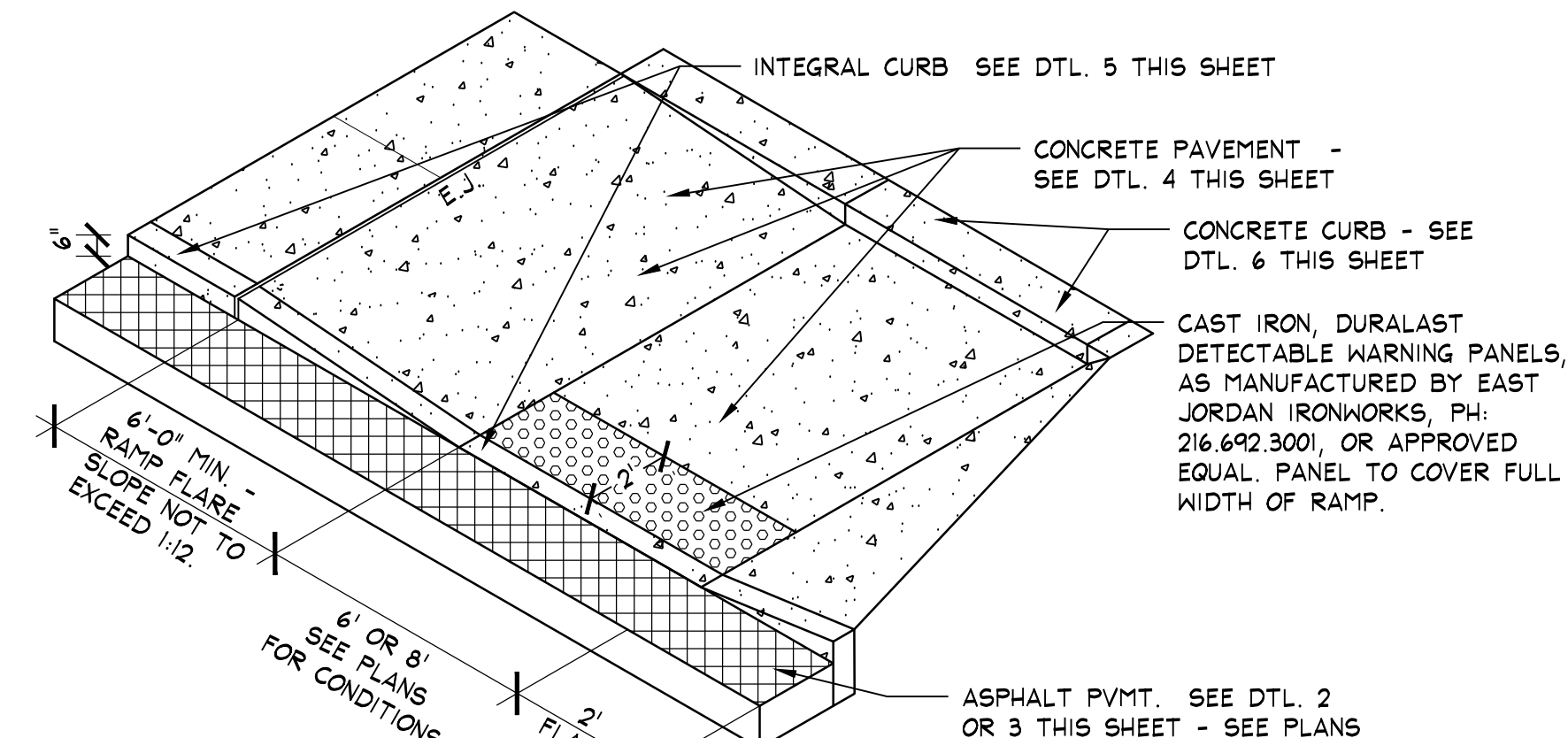

CURB RAMP TYPE 3

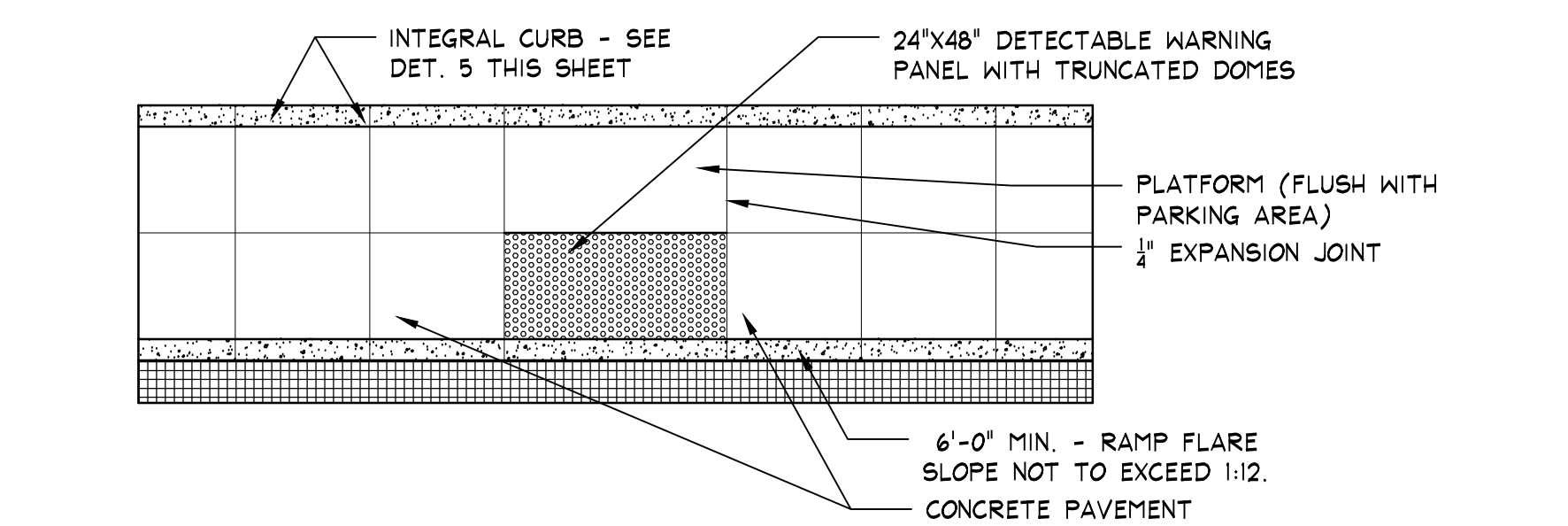

CURB RAMP, TYPE 4

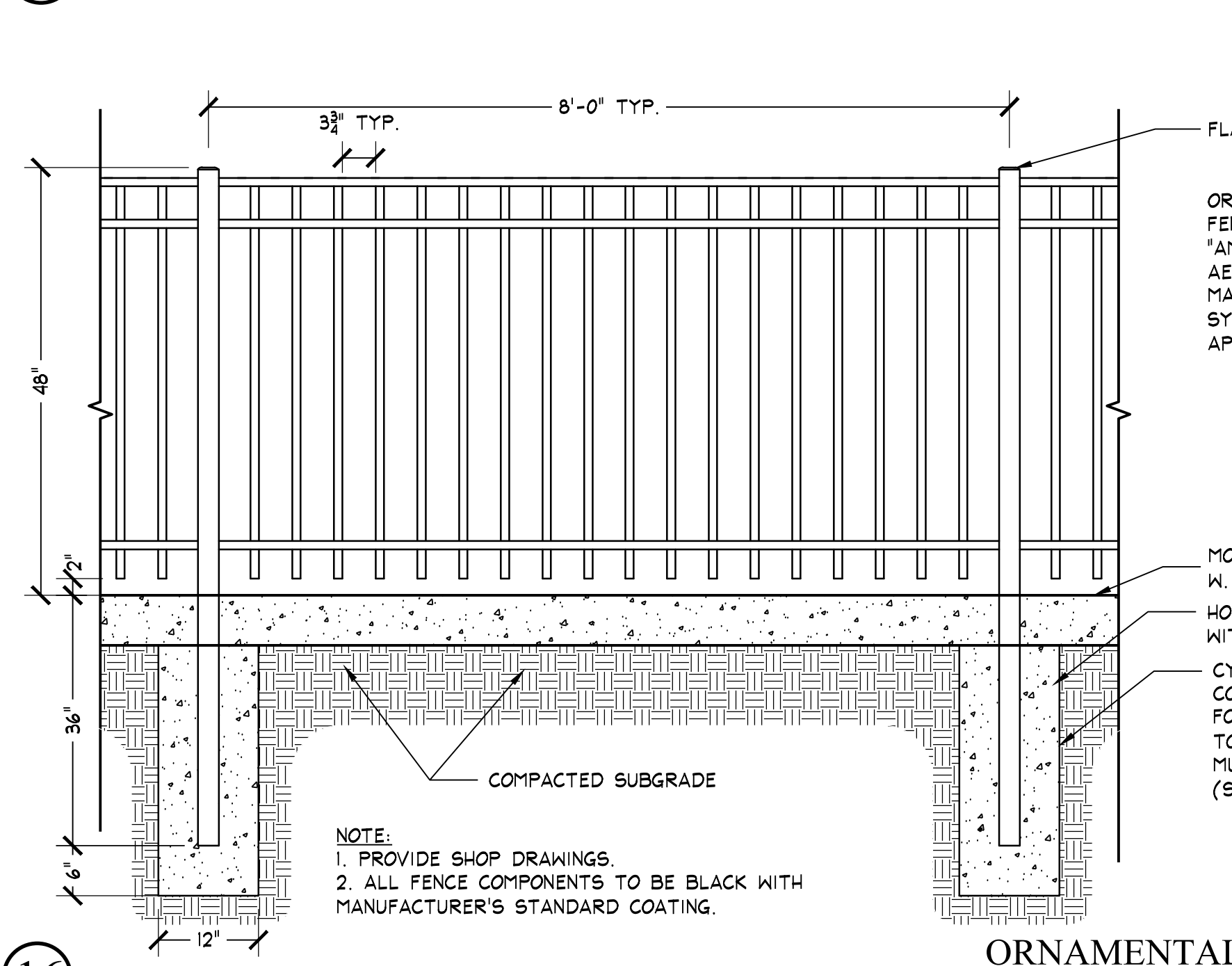

ORNAMENTAL FENCE

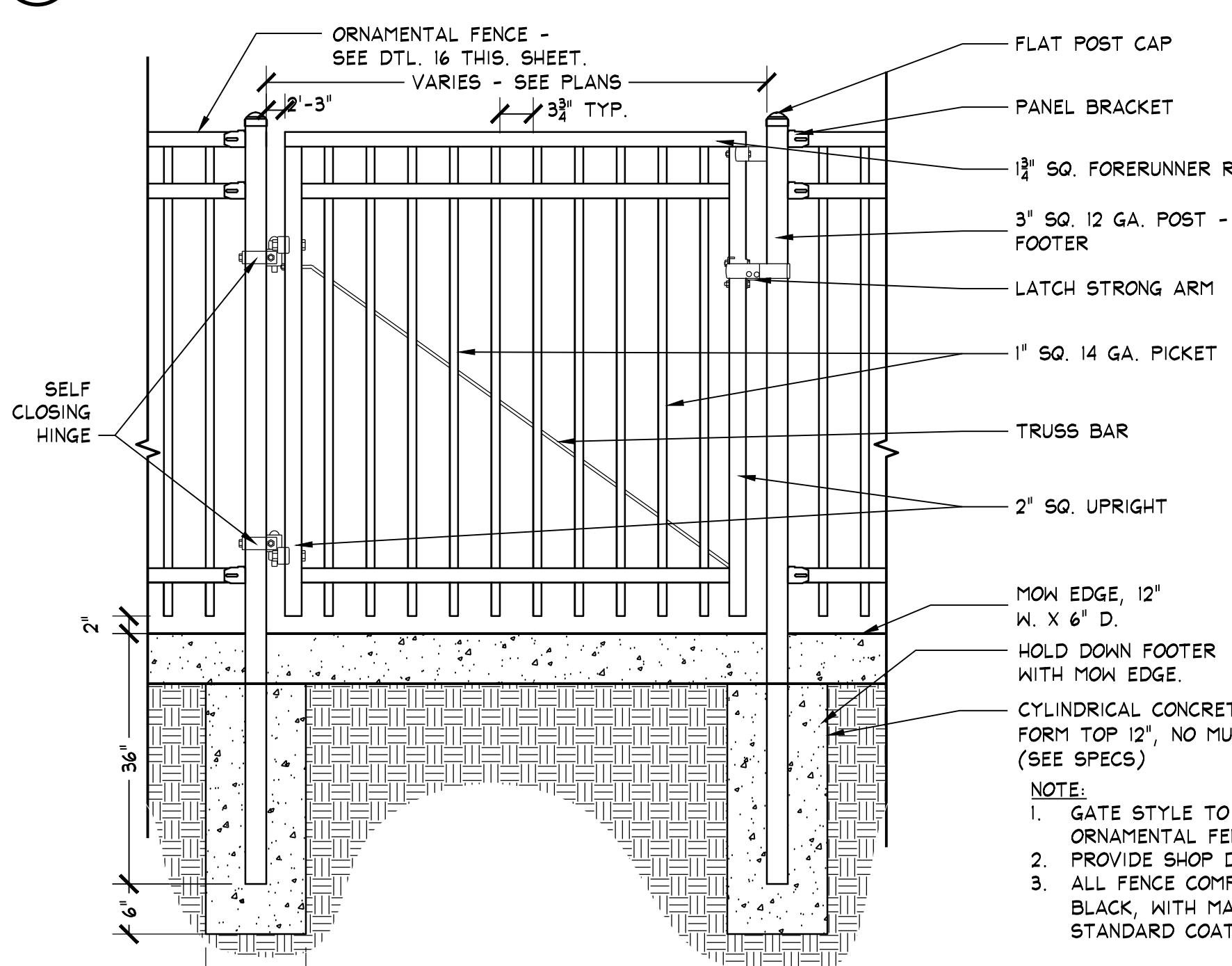

48\"/>

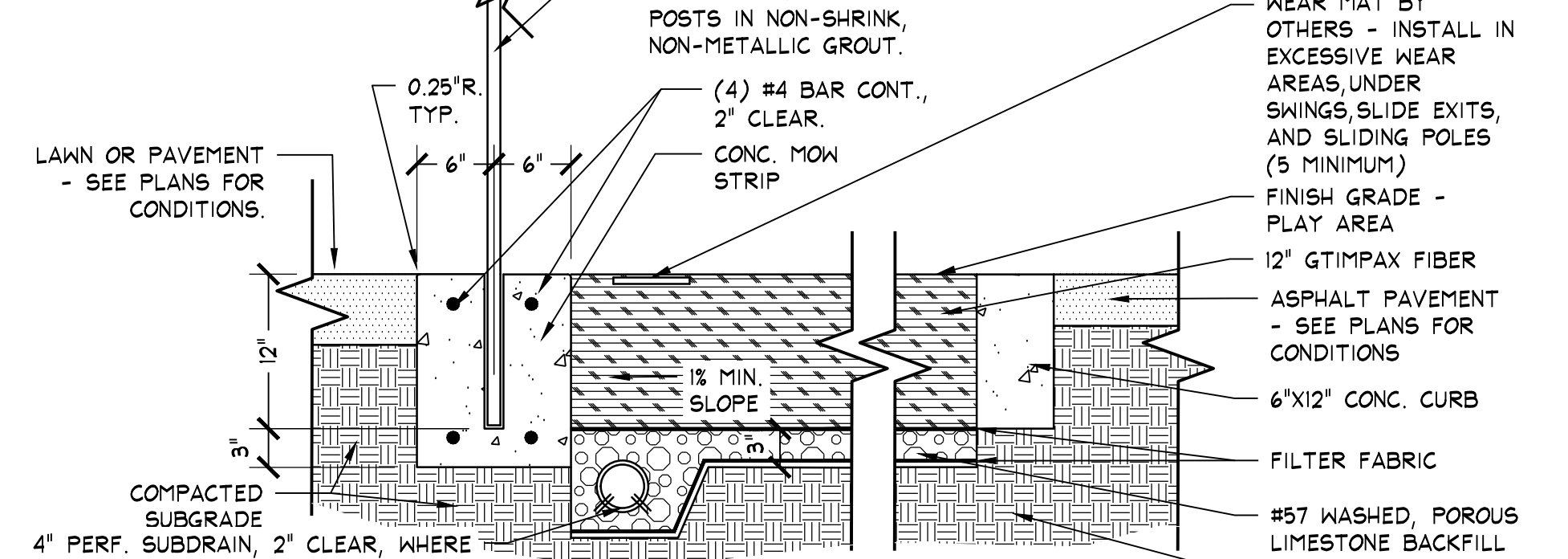

ENGINEERED WOOD FIBER PLAY SURFACE

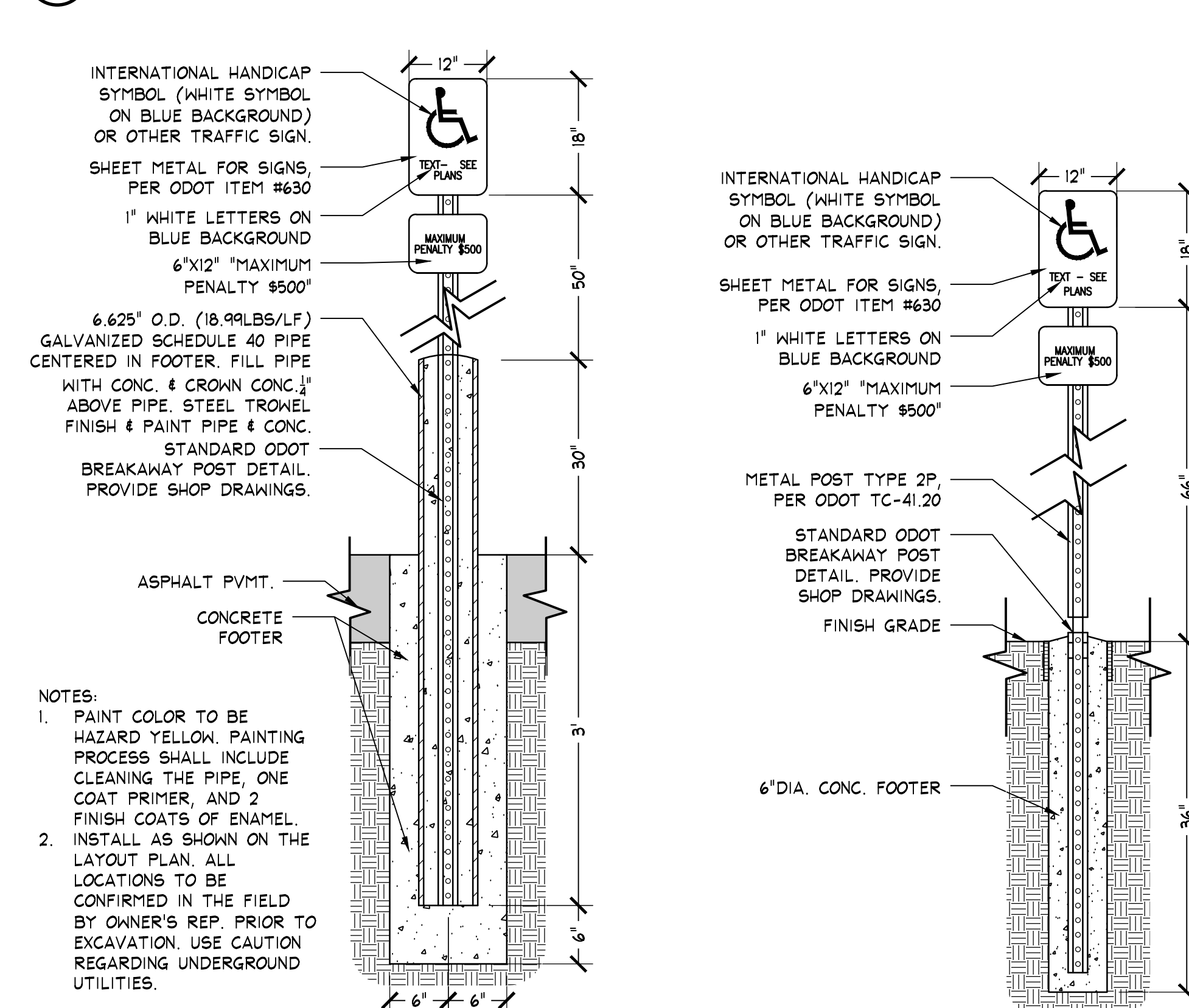

HANDICAP & TRAFFIC SIGNS IN PAVED AREAS

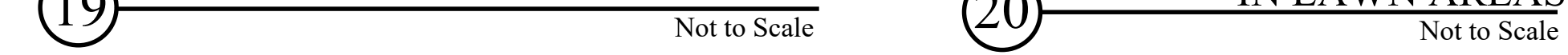

HANDICAP & TRAFFIC SIGNS IN LAWN AREAS

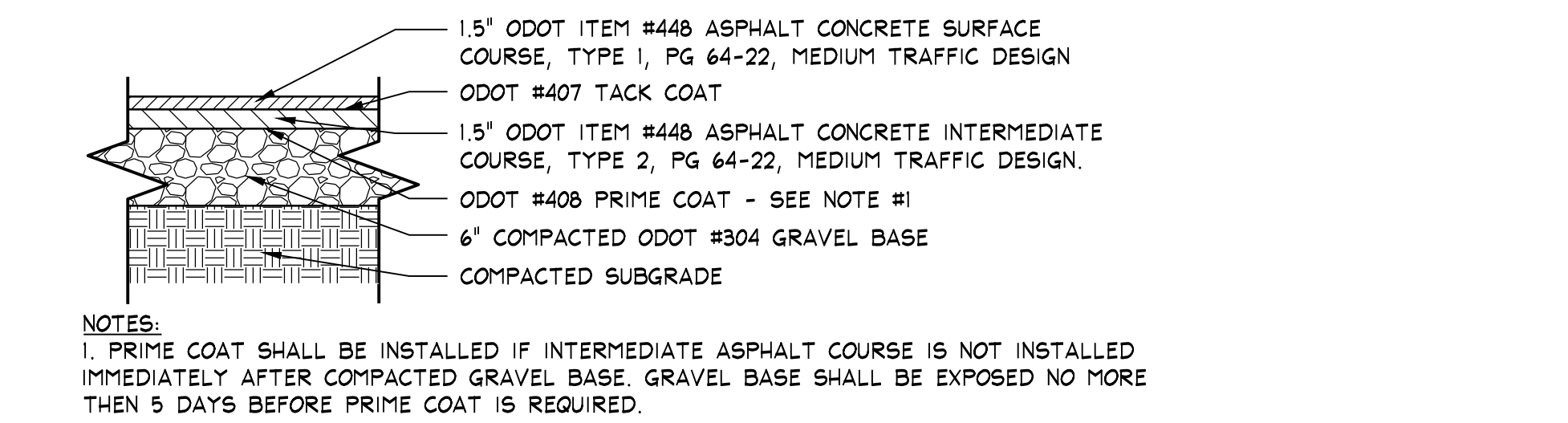

PLAY AREA ASPHALT PAVEMENT

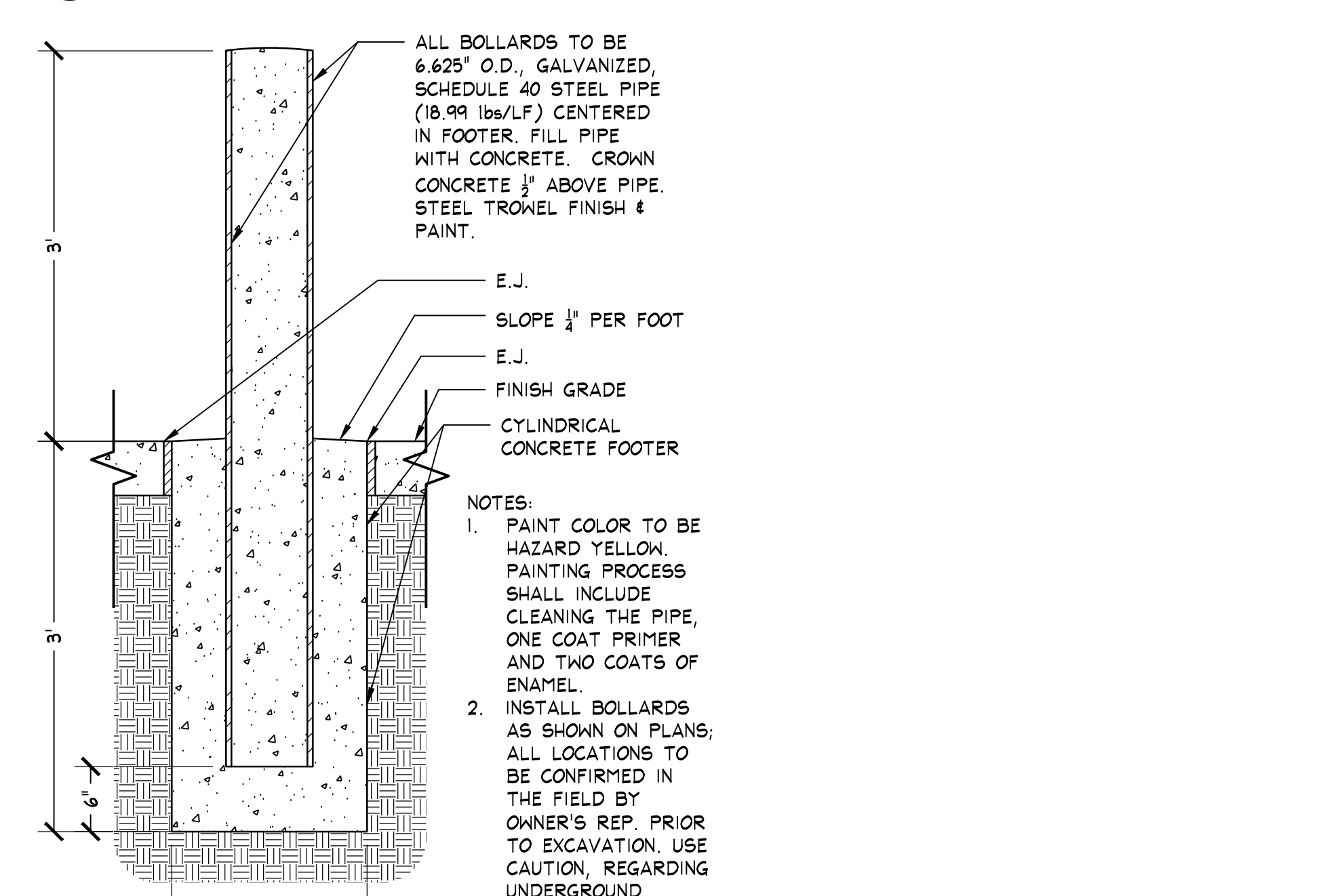

PIPE BOLLARD

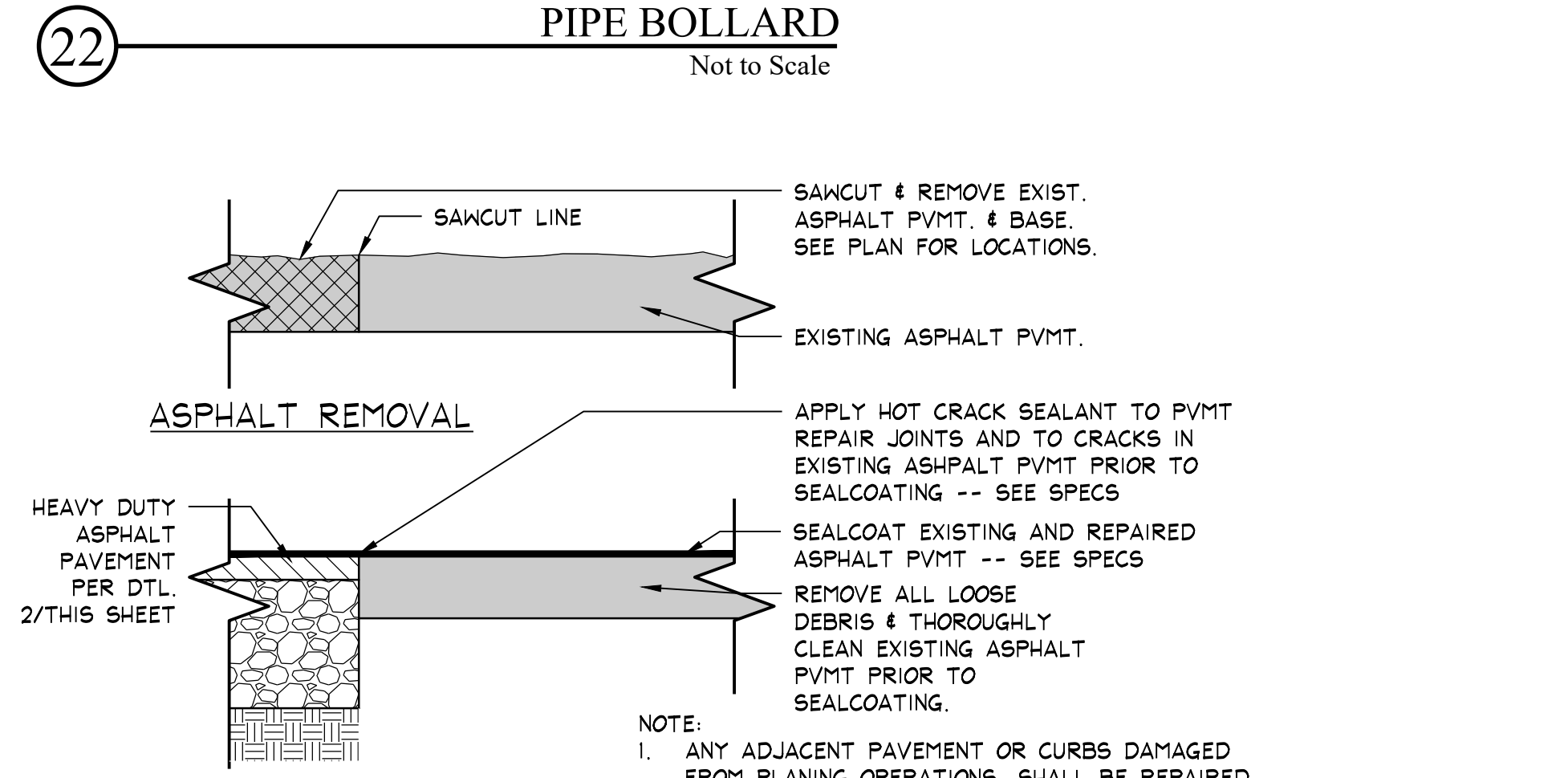

ASPHALT REMOVAL, REPAIR, AND SEALCOATING

PROJECT NO
2203-1

ARCHITECTURAL VISION GROUP, LTD
PLANNERS

ARCHITECTS

23850 SPERRY DRIVE
CLEVELAND, OHIO 44145

MASSILON CITY SCHOOL
WEST SIDE CAMPUS

250 29th St NW, Massillon, OH 44447

CONSULTANT:
behne
LANDSCAPE ARCHITECTURE
2688 Summit Road, Suite 2
P.O. Box 100, 712 489 8650
E: info@behne.com

PROFESSIONAL SEAL
STATE OF OHIO
MADE WITH
NON-TOXIC
INKS
RESISTANT TO
ARCHITECTS

MARK
DATE
ISSUED AS:

PROJECT NO
2203-1

DRAWN BY

CHECKED BY

DATE

SHEET NO
L-500