

COMPOSITE FIRST FLOOR PLAN
SCALE: 1/16" = 1'-0"
FF (62,139 SF)
SF (27,244 SF)
Total (89,383) SF

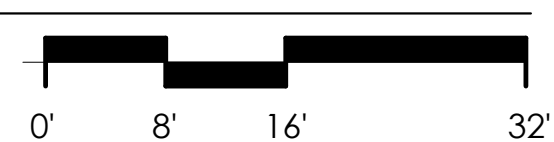

1. ALL DRAWINGS TO BE READ IN CONJUNCTION WITH SPECIFICATIONS.
2. THE CONTRACTOR IS RESPONSIBLE FOR COORDINATION OF STRUCTURAL, MECHANICAL, PLUMBING, FIRE SUPPRESSION, ELECTRICAL, AND TECHNOLOGY SYSTEMS.
3. FINISH FIRST FLOOR ELEVATION 0'-0" = 1089.0
4. ALL FIRE RATED WALLS SHALL EXTEND TO THE UNDERSIDE OF THE STRUCTURE ABOVE WITH FIRE STOP MATERIAL BETWEEN TOP OF WALL AND STRUCTURE. ALL PENETRATIONS THROUGH FIRE RATED WALL (I.E. PIPES, CONDUITS, ETC) SHALL RECEIVE FIRE SEALS. DUCTS PENETRATING FIRE RATED WALLS SHALL RECEIVE FIRE DAMPERS EQUAL TO THE RATING OF WALLS RECEIVING RECESSED EQUIPMENT AND/OR BUILDING ACCESSORIES.
5. ALL PENETRATIONS THROUGH SOUND ATTENUATED WALLS SHALL BE SEALED AND SOUNDPROOFED.
6. REFER TO STRUCTURAL DRAWINGS FOR LOCATIONS OF ALL REINFORCED MASONRY WALLS.
7. REFER TO STRUCTURAL DRAWINGS FOR UNTEL SCHEDULE AT MASONRY WALLS PRECAST LINTELS WILL BE ALLOWED AT LOCATIONS APPROVED BY THE ARCHITECT.
8. SIZES FOR ALL COLUMNS ARE NOTED ON THE STRUCTURAL DRAWINGS. ALL EXPOSED COLUMNS AND STEEL LINTELS SHALL BE FINISH PAINTED. SEE SPECIFICATIONS.
9. REFER TO STRUCTURAL DRAWINGS FOR TYPICAL CONCRETE FROST SLAB. SLOPE 1/4" PER FOOT (TYPICAL). FROST SLAB IS REQUIRED AT ALL EXTERIOR DOORS.
10. GENERAL TRADES CONTRACTOR(S) SHALL COORDINATE WITH PLUMBING CONTRACTOR FOR THE EXACT LOCATION OF ACCESS PANELS IN TOILET ROOMS.
11. PROVIDE BULLNOSE AT OUTSIDE CORNERS OF ALL MASONRY WALLS THAT ARE EXPOSED TO VIEW.
12. WALL MOUNTED FIRE EXTINGUISHERS SHALL BE MOUNTED WITH TOP OF EXTINGUISHERS AT 4'-3" A.F.F. TOP OF FIRE EXTINGUISHER CABINETS SHALL BE MOUNTED WITH TOP OF CABINET 5'-4" A.F.F.
13. ALL CMU WALLS SHALL RECEIVE HORIZONTAL TRUSS REIN. @ 16" O.C. VERTICAL. SEE STRUCTURAL DRAWINGS FOR ADDITIONAL REINFORCING. SEE STRUCTURAL DRAWINGS FOR ALL BOND BEAM LOCATIONS.
14. INTERIOR NON-BEARING AND NON-RATED PARTITIONS SHALL EXTEND TO THE UNDERSIDE OF STRUCTURE (I.E. C.O.).
15. ALL 3/8" x 4" & 6" METAL STUD AND GYP. BRD. WALLS SHALL BE BRACED (ABOVE CEILING) WITH 3/8" METAL STUD AT 4'-0" O.C. MIN. SEE DETAIL 12(A-555) FOR TYPICAL BRACING DETAIL.
16. GENERAL TRADES CONTRACTOR SHALL PROVIDE WOOD BLOCKING BEHIND DOOR STOP OR ANY OTHER ATTACHMENTS TO GYP. BRD. CONSTRUCTION (TYP).
17. IN EACH TELECOM AND TECH. ROOM, INSTALL AND PAINT 4"x6"x8" FIRE TREATED PLYWOOD BOARD. COORDINATE LOCATION WITH TECHNOLOGY CONTRACTOR.
18. PROVIDE TRANSITION STRIPS WHERE FLOORING MATERIAL TRANSITION IS EXPOSED. FLOORING TRANSITION BETWEEN FLOORING MATERIALS TO BE CENTERED UNDER DOOR.
19. THE CONTRACTOR SHALL PROVIDE EXTERIOR WALL CONTROL JOINTS PER TYPICAL DETAIL ON SHEET A-521/A-522, LOCATED PLUS OR MINUS 24'-0" O.C. AND/OR WHERE INDICATED ON UNIT FLOOR PLAN SHEETS AND ELEVATIONS.
20. THE CONTRACTOR SHALL PROVIDE INTERIOR WALL CONTROL JOINTS PER TYPICAL DETAIL ON SHEET A-521, LOCATED PLUS OR MINUS 24'-0" O.C. AND/OR WHERE INDICATED ON UNIT FLOOR PLAN SHEETS.
21. SEMI-RECESSED FIRE EXTINGUISHER CABINET SYMBOL ON PLAN IS (FE-X) SURFACE MOUNTED FIRE EXTINGUISHER SYMBOL ON PLAN IS (FE-X)
22. PROVIDE FIRE RATED CABINETS IN FIRE RATED WALLS. SEE DETAILS ON SHEET A-522.
23. ALL FLOOR, CEILING, WALL AND ROOF PENETRATIONS SHALL BE COORDINATED FOR SIZE AND LOCATION WITH DISCIPLINE REQUIRING THE PENETRATION. OPENINGS AROUND PENETRATIONS SHALL BE CLOSED OR SEALED BY THE CONTRACTOR REQUIRING THE PENETRATION.
24. INTERIOR PARTITIONS ARE DIMENSIONED TO CENTERLINE OF GYPSUM BOARD PARTITIONS OR FACE OF MASONRY EXCLUSIVE OF FINISH MATERIAL SUCH AS CERAMIC TILE. THE CONTRACTOR SHALL COORDINATE FINISH DIMENSIONS WITH FINISH SCHEDULE WHEN CRITICAL TO THE INSTALLATION OF MILLWORK, CASEWORK, OR EQUIPMENT.
25. CONTRACTORS SHALL VISIT THE SITE AND BE KNOWLEDGEABLE OF CONDITIONS THEREON. THEY SHALL INVESTIGATE, VERIFY, AND BE RESPONSIBLE FOR CONDITIONS OF THE PROJECT AND SHALL NOTIFY THE OWNER OF ANY CONDITIONS REQUIRING MODIFICATION BEFORE PROCEEDING WITH THE WORK.
26. CONTRACTORS SHALL FURNISH AND INSTALL WOOD BLOCKING, STIFFENERS, BRACING, BACKING PLATES, AND INSTALLATION OF CASEWORK, TOILET ROOM ACCESSORIES, AND TOILET PARTITIONS AS WELL AS WALL MOUNTED AND SUSPENDED MECHANICAL, ELECTRICAL AND/OR MISCELLANEOUS EQUIPMENT.
27. *NOT APPLICABLE
28. PROVIDE ROOF LADDER LOCATED IN VAULT ROOM. PROVIDE 2-2x6x16" STEEL TUBES IN STUD WALL ANCHOR TO FLOOR AND STRUCTURE ABOVE. FIELD VERIFY CONDITIONS PRIOR TO FABRICATION.
- SEE SHEET A-004 FOR WALL TYPES

KEY PLAN

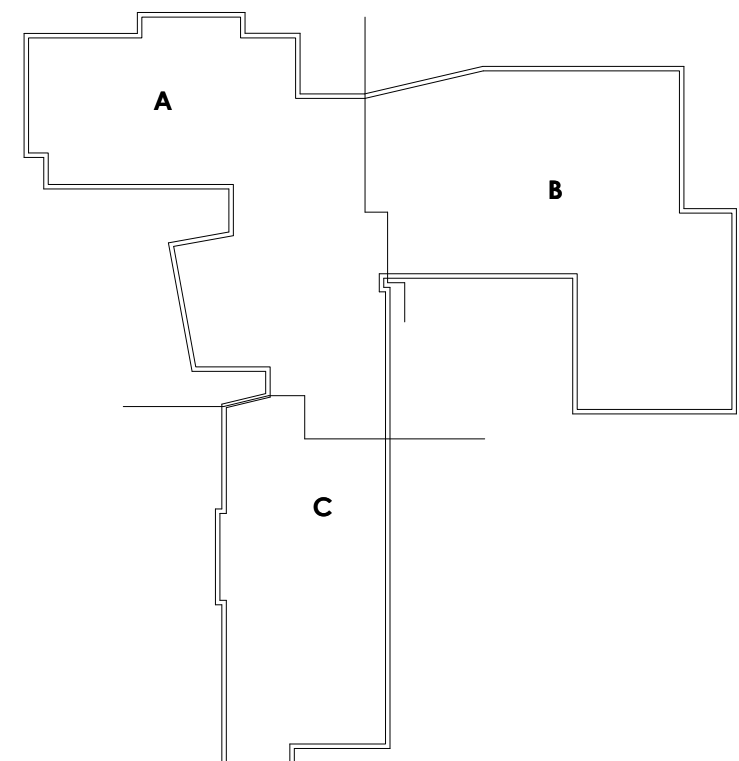

PROJECT NO
2203-1

ARCHITECTURAL VISION GROUP, LTD
PLANNERS
ARCHITECTS
23850 SPERRY DRIVE
CLEVELAND, OHIO 44145

PROFESSIONAL SEAL

SEAL OF THE STATE OF OHIO
SEAL NO. 10759
EXPIRATION DATE 12/31/2023

CONSULTANT:

MASSILLON CITY SCHOOL
MASSILLON WEST ELEMENTARY
PK-3
250 29TH STREET NW, MASSILLON, OHIO 44646
MASSILLON CITY SCHOOL DISTRICT MASSILLON, OHIO

| PROJECT NO | 2203-1 |
|------------|----------------------|
| DRAWN BY | |
| CHECKED BY | |
| DATE | |
| 7/1/23 | 100% BID PREPARE SET |
| 7/1/23 | DATE |
| ISSUED AS | DESCRIPTION |

COMPOSITE FIRST FLOOR PLAN

SCALE: As Indicated

SHEET NO
A-101