



ROOF PLAN CODED NOTES	
1	PROVIDE AND INSTALL PRE-FINISHED METAL COPING CAP. SEE TYPICAL DETAIL.
2	PROVIDE AND INSTALL 1/2\"/>
3	PROVIDE AND INSTALL PRE-FINISHED METAL GUTTERS AND DOWNSPOUTS AS INDICATED AND DETAILED PER MANUFACTURER INSTRUCTIONS AND SMACNA STANDARDS.
4	RUN BASE FLASHING, FULLY ADHERED, UP WALL TO TERMINATION BAR UNDER 2-PIECE, SNAP-IN COUNTERFLASHING AS DETAILED. SEE TYPICAL DETAIL 15/A-531.
5	PROVIDE AND INSTALL CONTINUOUS WALK-WAY PROTECTION MATERIAL AS INDICATED ON DRAWINGS.
6	PROVIDE AND INSTALL PRECAST CONCRETE SPLASH BLOCK UNDER DOWNSPOUT DISCHARGE AREAS.
7	ROOF MEMBRANE WRAPPED PARAPET. SEE TYPICAL DETAIL 02/A-533. MUST OCCUR WHERE DECK CHANGES DIRECTION.
8	SADDLE AT HIGH SIDE.

ROOF PLAN LEGEND	
SYMBOL	DESCRIPTION
ACCU	CONDENSING UNIT. SEE MECHANICAL DWGS.
E.F.	EXHAUST. SEE MECHANICAL DWGS.
ERD	EMERGENCY ROOF DRAIN - OPENING SHALL BE 4\"/>
GRV	GRAVITY ROOF VENT. SEE MECHANICAL DWGS.
GRI	GRAVITY ROOF INTAKE. SEE MECHANICAL DWGS.
HP	HIGH POINT OF FINISHED ROOF SURFACE
DS	DOWNSPOUT. SEE TYPICAL DOWNSPOUT SUPPORT DETAIL 03/A-531
RD	ROOF DRAIN FUTURE W/4 FT SQUARE SUMP. SEE MECHANICAL DWGS. SEE DETAIL 10/A-531. SEE STRUCTURAL DWGS FOR WELDED STEEL ANGLE DECK SUPPORT.
RD ERD	PRIMARY ROOF DRAIN AND EMERGENCY ROOF DRAIN IN 4 x 6\"/>
SC	THRU WALL OVERFLOW SCUPPER. SEE DETAIL 04/05/A-533
VTR	VENT THRU ROOF. FIELD COORDINATE EXACT LOCATIONS. SEE MECHANICAL DWGS. SEE TYPICAL DETAILS 08/09/A-531
RH-1	ROOF HATCH (RH-1 AS INDICATED ON SHEET A-302). SEE SPECIFICATIONS FOR ROOF HATCH SIZES AND MORE INFORMATION. SEE TYPICAL ROOF HATCH AND LADDER DETAIL 02/A-532
- - -	DASHED LINE DENOTES EXTERIOR WALL BELOW ROOF.
EJ - - -	ROOF EXPANSION JOINT. SEE DETAIL 04/05/A-531 AND 13/A-533
→	DIRECTION OF ROOF SLOPE
Continuous Line	CONTINUOUS 30\"/>
Ladder Symbol	ROOF ACCESS LADDER. SEE TYPICAL ROOF LADDER DETAIL 03/A-532. FIELD VERIFY LADDER HEIGHTS.

ROOF CONSTRUCTION GENERAL NOTES	
1.	ALL CONDITIONS SHOWN MUST BE VERIFIED IN THE FIELD BY ALL CONTRACTORS PRIOR TO STARTING ANY ROOF WORK.
2.	CONTRACTORS MUST NOTIFY THE CONSTRUCTION MANAGER IMMEDIATELY UPON DISCOVERY OF FIELD CONDITIONS CONTRADICTORY TO THE CONSTRUCTION DOCUMENTS.
3.	ROOFING CONTRACTOR SHALL MAINTAIN A PROTECTIVE WATERSHED COVER OVER UNFINISHED ROOF AREAS DURING PERIODS OF WEATHER PRECIPITATION DURING WORK DAYS, AT THE END OF WORK DAYS AND THROUGHOUT WEEKENDS. CONTRACTORS TO UNDERTAKE ONLY THAT AMOUNT OF WORK THAT CAN BE COMPLETELY INSTALLED OR BE MADE WATERTIGHT IN SAME WORK DAY.
4.	CONTRACTORS SHALL INSPECT ALL SURFACES TO RECEIVE ROOFING MATERIALS AND ACCESSORY ITEMS AND NOTIFY THE CONSTRUCTION MANAGER ALL CONDITIONS THAT COULD ADVERSELY AFFECT THE QUALITY OF ROOF INSTALLATION.
5.	CONTRACTOR TO UTILIZE ROOF STRUCTURE/DECK PITCH TO PRODUCE POSITIVE DRAINAGE OF FINISHED ROOF SURFACES TO REMOVE STANDING/PONDING WATER WITHIN 48 HOURS OF SUBSTANTIAL RAINFALL. PROVIDE 1/2\"/>
6.	REQUIRED INSULATING VALUE: STAGGER INSULATION JOINTS 6\"/>
7.	PROVIDE ROOFING COMPONENTS ATTACHMENTS AS REQUIRED BY THE CBC TO WITHSTAND AND 90 MPH WIND AND WRITTEN INTO MANUFACTURER'S WARRANTY. PROVIDE ENHANCED FASTENER FIELD DENSITY AT THE MEMBRANE ROOFING PERIMETER AND CORNER REGIONS AS REQUIRED. SEE SPECIFICATIONS.
8.	COORDINATE ROOF EQUIPMENT AND PENETRATION FLASH AND SEAL INSTALLATION WITH MECHANICAL, PLUMBING, ELECTRICAL, AND TECHNOLOGY DRAWINGS.
9.	ROLL-IN COVER BOARDS DIRECTLY AFTER ADHERING TO INSULATION USING GARDEN ROLLER TO PREVENT RAISED EDGES. ALL COVER BOARD EDGES MUST BE TRUE AND FLUSH.
10.	EXTEND ROOF MEMBRANE AND SELF ADHERING VAPOR BARRIER UP AND OVER ALL PARAPETS AND CURBS.
11.	ROOF CONSTRUCTION IS NON-COMBUSTIBLE MATERIALS. CLASS 8 ROOF. MIN.

ROOF PLAN CODED NOTES	
TYPE 01	SINGLE-PLY, FULLY ADHERED 60 MIL TPO MEMBRANE ROOFING SYSTEM ON 1/2\"/>
TYPICAL ROOF SYSTEM	
TYPE 02	FOR CANOPY AREAS SINGLE-PLY, FULLY ADHERED 60 MIL TPO MEMBRANE ROOFING SYSTEM ON 1/2\"/>
CANOPY AREA	

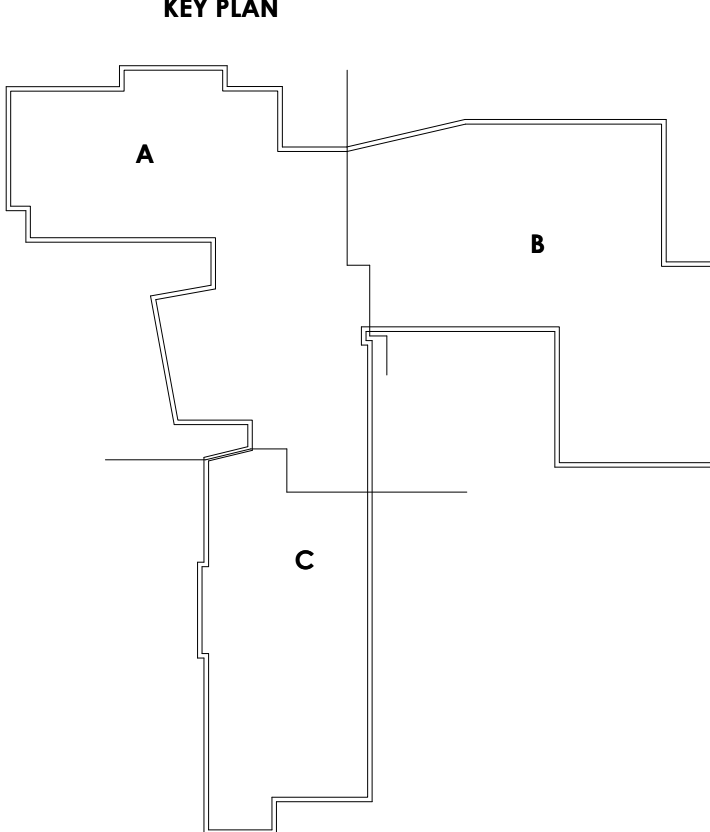

PROJECT NO
2203-1

ARCHITECTURAL VISION GROUP, LTD
PLANNERS
ARCHITECTS
23850 SPERRY DRIVE
CLEVELAND, OHIO 44145

CONSULTANT:
MASSILLON CITY SCHOOL DISTRICT
MASSILLON WEST ELEMENTARY
PK-3
250 29TH STREET NW, MASSILLON, OHIO 44646
MASSILLON CITY SCHOOL DISTRICT MASSILLON, OHIO

PROJECT NO	2203-1
DRAWN BY	
CHECKED BY	
DATE	

COMPOSITE ROOF PLAN

SCALE: As Indicated
SHEET NO
A-111

7/23/23	100% SIF PERMIT SET	DESCRIPTION
DATE	DATE	DESCRIPTION
ISSUED AS:		