



1. REFERENCE: GENERAL NOTES: S-001 - S-002, TYPICAL DETAILS: S-300 SERIES

2. VERIFY ALL ELEVATIONS AND DIMENSIONS SHOWN WITH ARCHITECTURAL DRAWINGS AND EQUIPMENT SUPPLIER'S SHOP DRAWINGS PRIOR TO FABRICATION AND INSTALLATION OF STRUCTURAL STEEL.

3. VERIFY FINAL ELEVATION = $9' 0"$ EQUALS SITE ELEVATION = $1099'-00"$.

4. VERIFY FINAL SITE ELEVATIONS AND GRADING WITH CIVIL.

5. SLAB CONSTRUCTION: 4" NORMAL WEIGHT CONCRETE SLAB ON GRADE SET ON 10 MIL VAPOR BARRIER OVER WELL COMPACTED STRIP FILL AND UNDER 12" MINIMUM THICKNESS OF MECHANICAL REPORT (AND GENERAL NOTES) AND REINFORCED WITH SYNTHETIC FIBER REINFORCEMENT. RECOMMENDED DOSAGE IS 3.0 LBS./CY. TO

A. PROVIDE ADDITIONAL REINFORCING BARS AT REINFORCEMENT AND CORNER LOCATIONS IN TYPICAL DETAILS.

B. COORDINATE FINISHED FLOOR ELEVATIONS, LOCATIONS OF DEPRESSIONS, RAMPS, ETC. WITH ARCHITECTURAL DRAWINGS.

6. TOP OF SLAB ELEVATION = $9' 0"$ EXCEPT AS NOTED.

A. EXISTING FILL SUPPORTING SLAB ON GRADE SHALL BE EITHER REMOVED OR THOROUGHLY PROBED AND FOUND TO BE COMPACTED TO THE SATISFACTION AND APPROVAL OF THE MECHANICAL ENGINEER.

B. ELEVATIONS NOTED THUS, (X-X'), ARE TO TOP OF FOOTING, SLAB OR PIER, UNO.

C. A TYPICAL TOP OF FOOTING ELEVATION = $1'-41.41$ UNO.

D. EXTERIOR FOOTINGS TO EXTEND A MINIMUM OF 42" BELOW FINISHED GRADE. COORDINATE FINAL GRADING WITH CIVIL.

7. COORDINATE THE LOCATION AND DEPTH OF ALL UNDERGROUND MECHANICAL, ELECTRICAL, PLUMBING, AND/OR CIVIL WORK PRIOR TO CONSTRUCTION. NOTED LOCATIONS SHALL BE SHOWN ON THE STRUCTURAL DRAWINGS. UTILITY LINE TRENCHES SHALL NOT UNDERMINE FOUNDATIONS.

A. FOUNDATIONS BUILT PRIOR TO THE INSTALLATION OF UNDERGROUND UTILITIES SHALL BE STEPED OR DROPPED COMPLETELY BELOW THE UTILITY LINE.

B. WHERE UNDERGROUND UTILITIES ARE IN PLACE PRIOR TO FOUNDATION CONSTRUCTION THEY ARE TO BE ENGAGED PER TYPICAL DETAILS.

8. NO FOUNDATION CONCRETE SHALL BE POURED PRIOR TO INSPECTION AND APPROVAL OF SOIL BEARING CAPACITY BY GEOTECHNICAL ENGINEER.

A. UNSUITABLE EXISTING FILL AT THE LOCATION OF SPREAD OR STRIP FOOTINGS SHALL BE UNDERCUT TO STABLE NATURAL SOIL TO THE SATISFACTION AND APPROVAL OF THE MECHANICAL ENGINEER. TECHNICAL ENGINEER SHALL PROVIDE A CONTROLLED DENSITY FILL (CDF).

9. CMU WALL CONSTRUCTION:

A. 8" CMU W/ #5 @ 32" O.C. VERTICAL REINFORCEMENT UNLESS NOTED OTHERWISE.

B. 12" CMU W/ #8 @ 32" O.C. VERTICAL REINFORCEMENT AT GYM.

10. ALL NON-LOAD BEARING MASONRY WALLS SHALL BE PLACED ON A THICKENED, 6" REFERENCE ARCHITECTURAL WALL DRAWINGS FOR WALL LOCATIONS AND EXTENTS AND SEE TYPICAL DETAIL ON S-302.

11. "MP" DENOTES MASONRY PIER. MASONRY PIERS SHALL EXTEND TO THE FULL HEIGHT OF WALL UNLESS NOTED OTHERWISE. SEE TYPICAL MASONRY DETAILS.

WALL STRIP FOOTING SCHEDULE				
MARK	SIZE		REINFORCING	REMARKS
	WIDTH	DEPTH		
WF2.0	2' - 0"	1' - 0"	CONT. (2)#5	
WF2.0A	2' - 0"	2' - 6"	CONT. (3)#5 T&B	
WF3.0	3' - 0"	1' - 0"	CONT. (3)#5	
WF3.0A	3' - 0"	2' - 6"	CONT. (4)#5 T&B	
WF5.0A	5' - 0"	2' - 6"	#5 @ 12" OC EW T&B	

LEVEL SCHEDULE	
NAME	ELEVATION
ROOF FRAMING - MECH ROOM	32' - 0"
ROOF FRAMING PLAN	28' - 0"
SECOND FLOOR	13' - 4"
T/STL SECOND FLOOR	12' - 4"
FIRST FLOOR	0' - 0"
T/ FOUNDATION (TYP UNO)	-1' - 4"

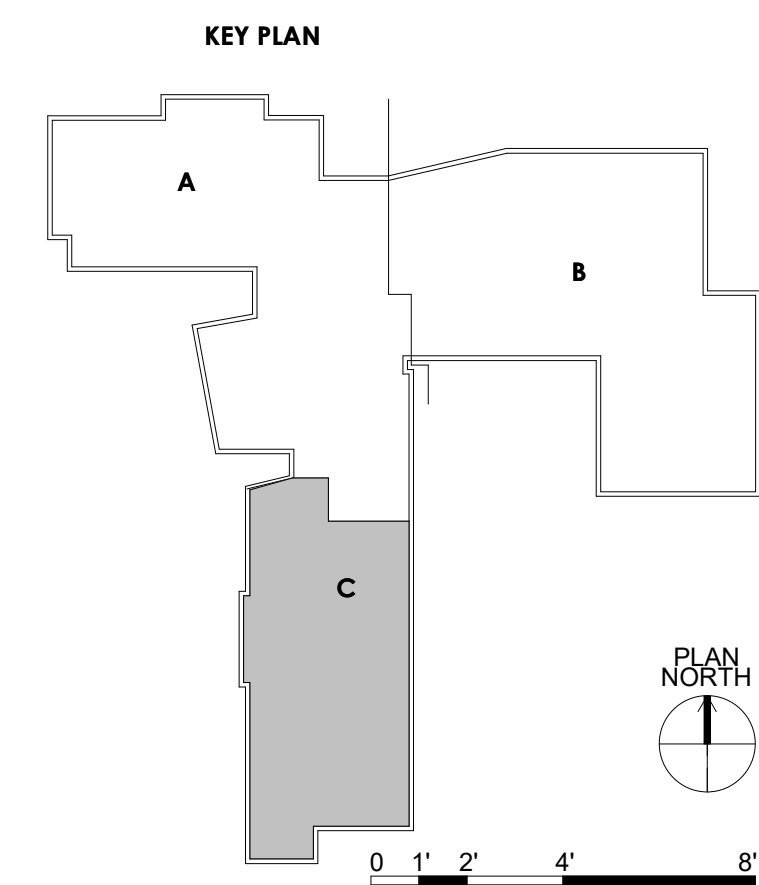

ARCHITECTURAL VISION GROUP, LTD
ARCHITECTS • PLANNERS
23850 SPERRY DRIVE CLEVELAND, OHIO 44145

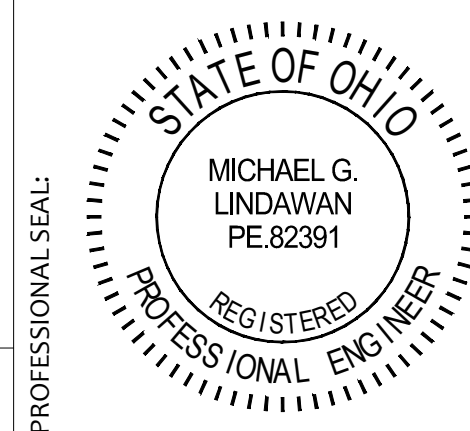
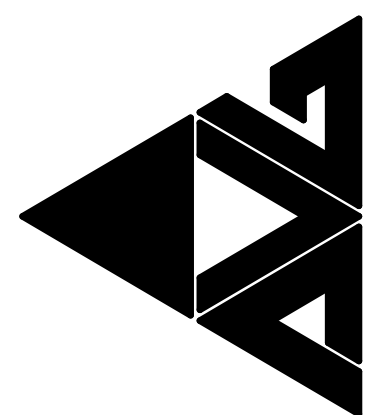

MASSILLON CITY SCHOOL
MASSILLON WEST ELEMENTARY
PK-3
250 29TH STREET NW, MASSILLON, OHIO 44646
MASSILLON CITY SCHOOL DISTRICT MASSILLON, OHIO

[illegible]

PROJECT NO	2203-1
DRAWN BY	Author
CHECKED BY	Checke
DATE	

FOUNDATION
PLAN UNIT C

SCALE: 1/8" = 1'-0"

SHEET NO

S-101-C