

THE CRITICAL STORM WAS CALCULATED TO BE THE 25-YEAR STORM

WDV REQUIRED BELOW PERMANENT WATER SURFACE -	50,461.57 CUBIC FEET (INCLUDES 20% FOR SEDIMENT STORAGE)
WDV PROVIDED BELOW PERMANENT WATER SURFACE -	81,273 CUBIC FEET
WDV REQUIRED ABOVE PERMANENT WATER SURFACE -	42,051.3 CUBIC FEET
WDV PROVIDED ABOVE PERMANENT WATER SURFACE -	42,185.43 CUBIC FEET

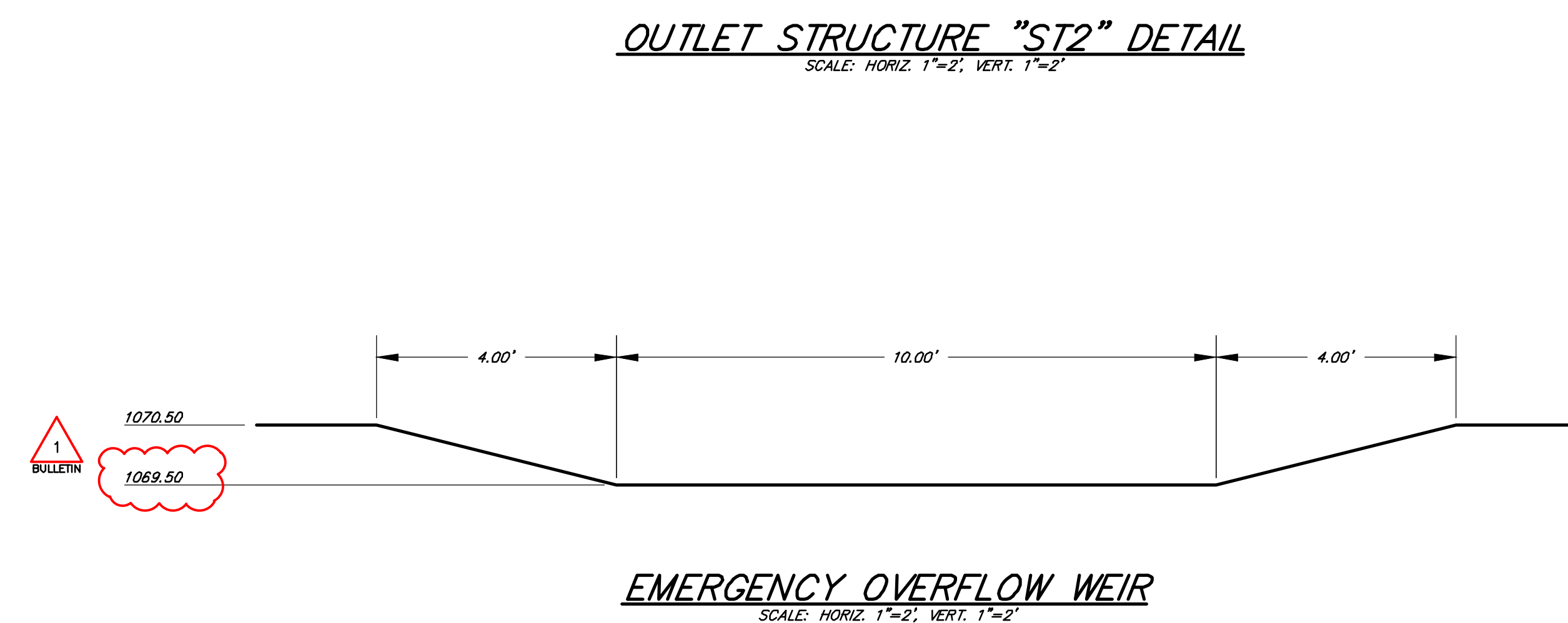
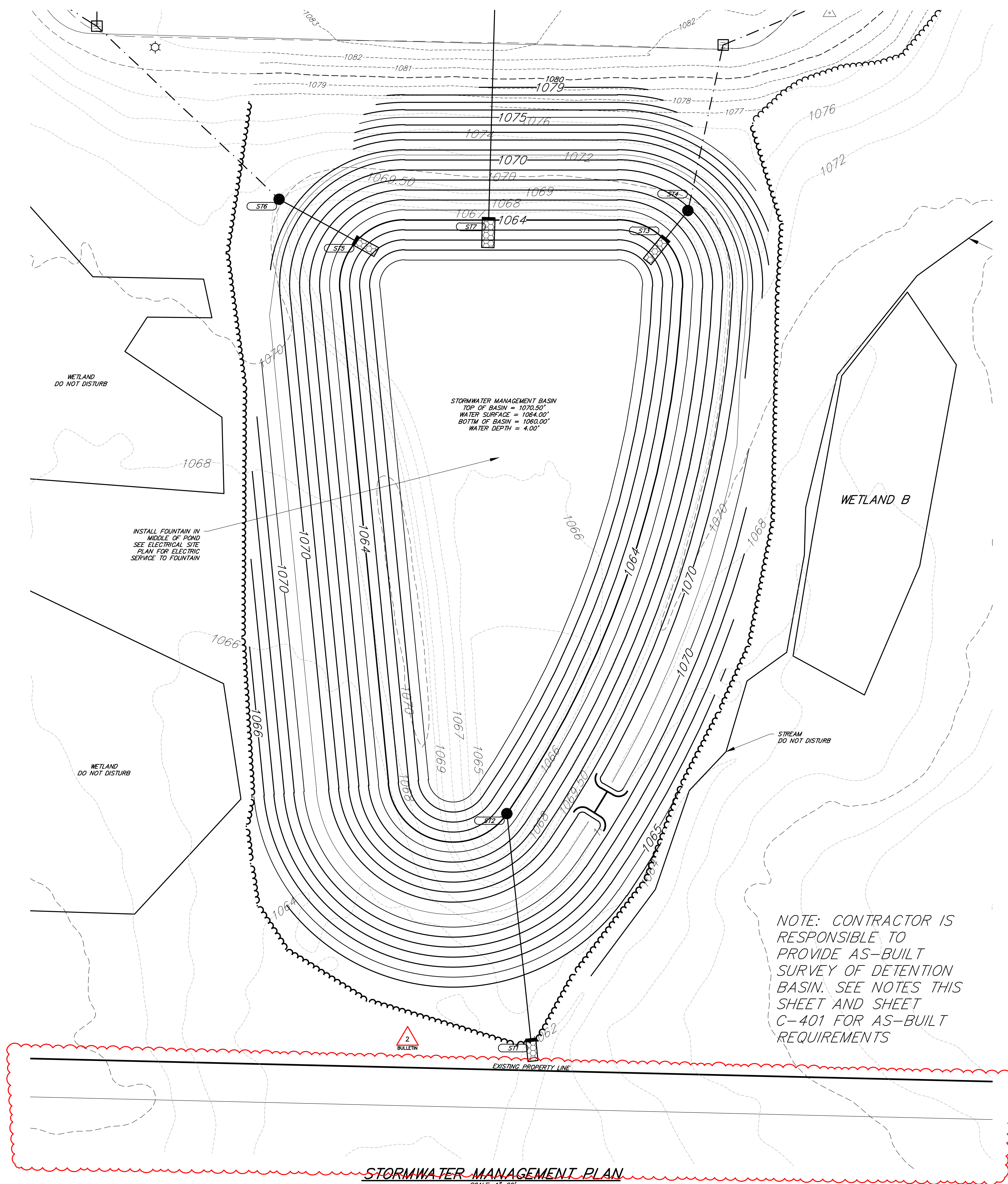
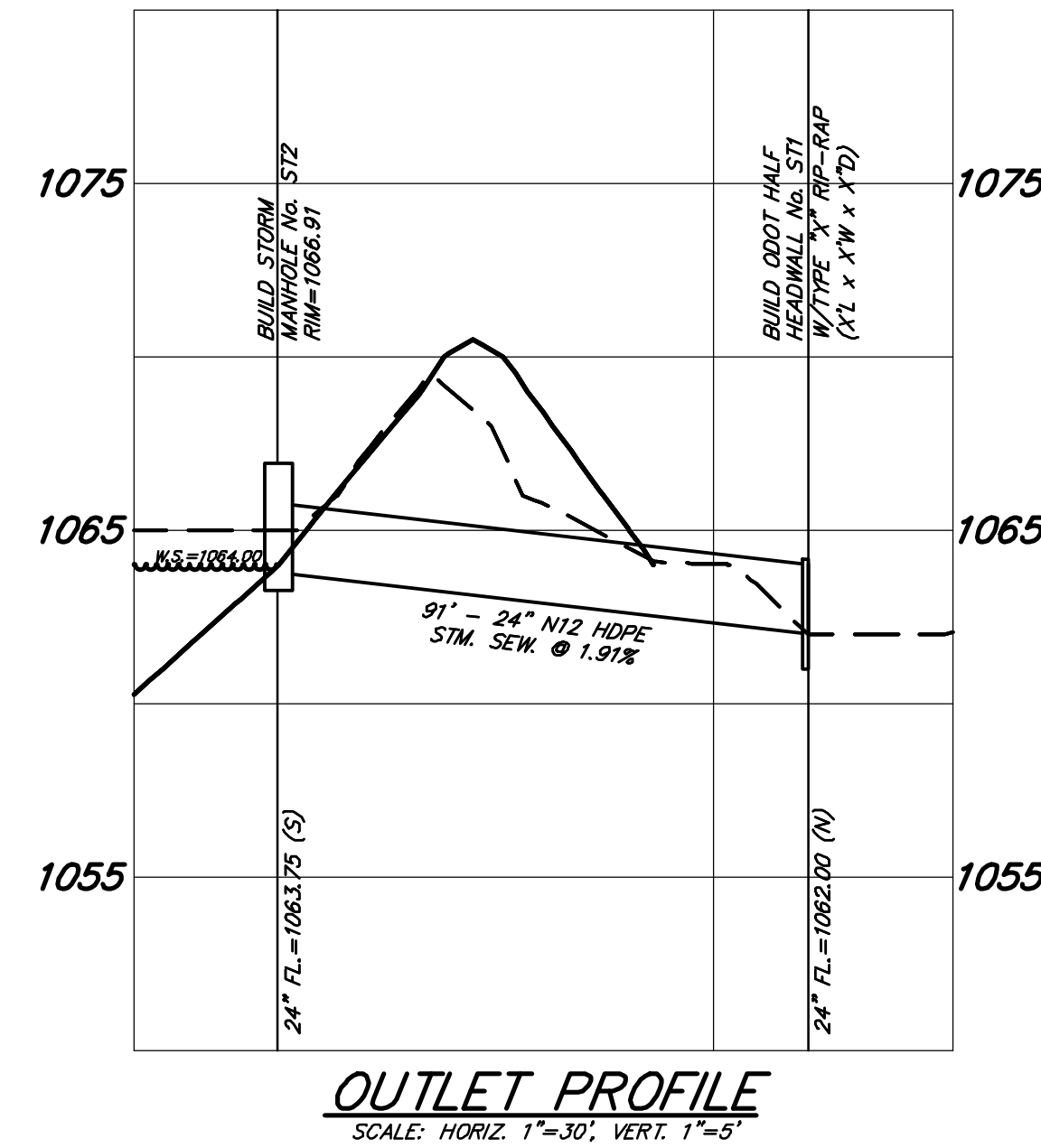
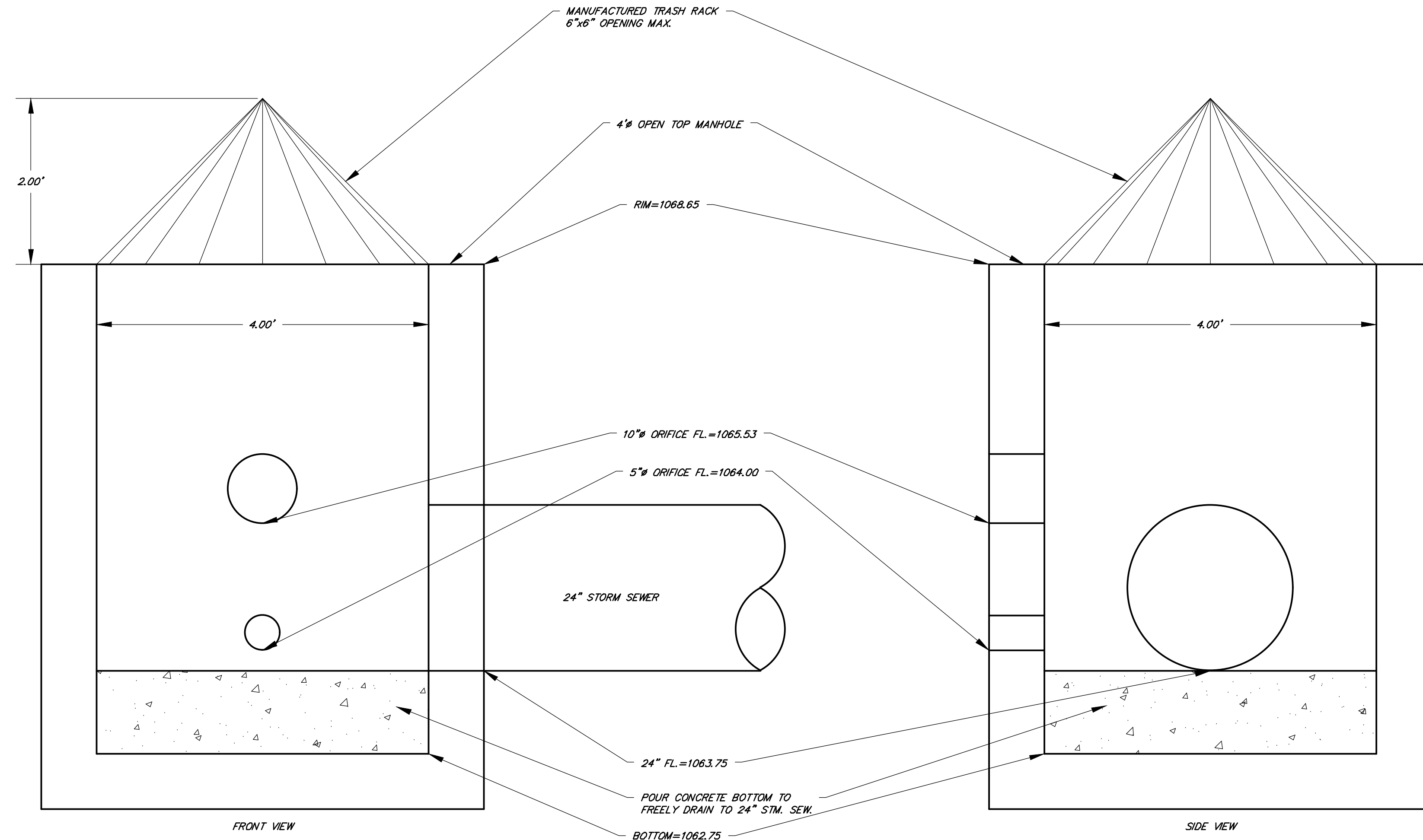

STORMWATER MANAGEMENT BASIN STORAGE (ABOVE PERMANENT POOL)	
ELEVATION (FEET)	VOLUME (CUFBG)
1064	0
1065	26,628
1066	55,981
1067	88,160
1068	123,264
1069	161,394
1070	202,651
1070.50	224,869

STORMWATER MANAGEMENT BASIN STORAGE (PERMANENT POOL)	
ELEVATION (FEET)	VOLUME (CUFBG)
1060	01
1061	16,733
1062	33,789
1063	57,269
1064	81,273

STORMWATER MANAGEMENT BASIN NOTES

- (1) THE FINAL STORMWATER MANAGEMENT BASIN SHALL NOT BE INSTALLED UNTIL THE END OF THE DESIGN. SEE SHEET C-10 FOR DISCUSSION ON USING THE STORMWATER MANAGEMENT BASIN AS A SEDIMENT BASIN WHILE THE SITE IS UNDER CONSTRUCTION.
- (2) THE CONTRACTOR SHALL INSTALL THE STORMWATER MANAGEMENT BASIN AS SHOWN ON THIS PLAN AT THE END OF THE PROJECT.
- (3) THIS DETENTION BASIN SHALL MAINTAIN A PERMANENT WATER PLEVEL AT ALL TIMES. THE DESIGN SHALL PROVIDE OVER-DRAINAGE WITHIN THE POOL ENCLOSED WITHIN THE POOL AND PLACE A CLAY LINER TO OBTAIN THE DESIRED GRADES, POOL ELEVATIONS AND MAINTAIN A PERMANENT WATER POOL.
- (4) THE CONTRACTOR SHALL COMPLETELY DEWATER THE SEDIMENT BASIN PRIOR TO BEGINNING ANY REGRADING ANY PARTS OF THE SEDIMENT BASIN TO ACHIEVE THE FINAL PLAIN ELEVATIONS OF THE STORMWATER MANAGEMENT BASIN.
- (5) THE CONTRACTOR IS RESPONSIBLE FOR ALL EXPENSES TO CONVERT THE SEDIMENT BASIN TO THE FINAL STORMWATER MANAGEMENT BASIN. THIS INCLUDES, BUT IS NOT LIMITED TO, THE FOLLOWING: HIRING OF A PROFESSIONAL SURVEYOR IN BOTH PAPER COPY AND ELECTRONIC AUTOCAD FILE, TO THE PROJECT ENGINEER, TO THE STORMWATER MANAGEMENT BASIN AREA AND THE SEDIMENT BASIN; MODIFICATION OF THE OULET STRUCTURE, CLEANING OF THE OULET STRUCTURE AND SITE STORM SEWER.
- (6) AFTER THE COMPLETION OF THE STORMWATER MANAGEMENT BASIN CONVERSION OF THE OULET STRUCTURE, THE CONTRACTOR SHALL PROVIDE AN ABSOLUTE SURVEY DRAWN BY AN OHIO REGISTERED PROFESSIONAL SURVEYOR IN BOTH PAPER COPY AND ELECTRONIC AUTOCAD FILE, TO THE PROJECT ENGINEER, TO THE STORMWATER MANAGEMENT BASIN AREA AND THE SEDIMENT BASIN.
- (7) DEVIATION FROM THE DESIGN ELEVATIONS AND LOCATIONS OF MORE THAN 1/8" VERTICALLY OR 1" HORIZONTALLY FOR THE OULET STRUCTURE, INCLUDING RIMS, FLOWLINES, ORFLOWS, ORFLOWS AND/OR SLOPES WILL NOT BE ACCEPTED.
- (8) DEVIATION OF 1% OR GREATER FROM THE DESIGN STORAGE VOLUME AT EACH CONTROL ELEVATION WILL NOT BE ACCEPTED.
- (9) THE WATER QUALITY VOLUME MUST BE MET IN ITS ENTIRETY IN ACCORDANCE WITH OHIO EPA GENERAL CONSTRUCTION PERMITS.
- (10) THE STORMWATER MANAGEMENT BASIN SHALL NOT AT ANY TIME DISCHARGE STORM WATER AT A HIGHER RATE THAN ANY ALLOWABLE DISCHARGE RATE FOR EACH STORM EVENT.
- (11) THE CONTRACTOR SHALL BE RESPONSIBLE FOR ALL EXPENSES TO HAVE A PROFESSIONAL SURVEYOR TO PERFORM AN ABSOLUTE SURVEY, AS WELL AS REGRADE THE BASIN TO THE DESIGN ELEVATIONS AND LOCATIONS AND ADJUST OR REPLACE THE OULET STRUCTURE UNTIL SAID ABSOLUTE DRAININGS DEMONSTRATE THAT THE WORK IS COMPLETE AND ACCEPTABLE TO THE PROJECT ENGINEER.
- (12) AT THE END OF THE PROJECT, AFTER FINAL SITE STABILIZATION IS COMPLETE (70%+ VEGETATIVE COVER ESTABLISHED), THE CONTRACTOR SHALL SUBMIT VIDEO EVIDENCE OF ALL STORM SERIES TO PROVE THE STORM SERIES ARE CLEAR OF ANY OBSTACLES. SUCH VIDEO EVIDENCE SHALL BE SUBMITTED IN ACCORDANCE WITH QDOT CITY OF COLUMBUS REQUIREMENTS AND A PERFORMANCE REPORT SHALL BE SUBMITTED ALONG WITH THE VIDEO FILES FOR REVIEW IN ACCORDANCE WITH QDOT CITY OF COLUMBUS REQUIREMENTS. THE VIDEO EVIDENCE SHALL BE SUBMITTED TO THE PROJECT ENGINEER USING THE ACT-V-PROCESS RECOMMENDED BY THE MANUFACTURER AND RESUMED NEW VIDEO EVIDENCE AND PERFORMANCE REPORT OF THE PROJECT ENGINEER.
- (13) IN THE EVENT THE CONTRACTOR FAILS TO PROVIDE ADEQUATE CLOSE OUT DOCUMENTS INCLUDING ASBESTOS AND VIDEO INSPECTIONS, THE DESIGN TEAM RESERVES THE RIGHT TO PERFORM AND/OR SUBCONTRACT THE REQUIRED SERVICES REQUIRED TO PROVIDE THE REQUIRED ASBESTOS RECORDS AND VIDEO INSPECTIONS. THE CONTRACTOR WILL THEN BE BACK CHARGED FOR THE COST OF THESE TESTS AND RECORDS.

The "Basis of Bearings" for this survey is **Grid North** of the Ohio State Plane Coordinate System, NAD83(2011), North Zone as established by GPS Observations.

BENCHMARK #1:  
EX. SAN. M.H. C  
RIM = 1085.63

BENCHMARK #2:  
EX. SAN. M.G. W  
RIM = 1081.83

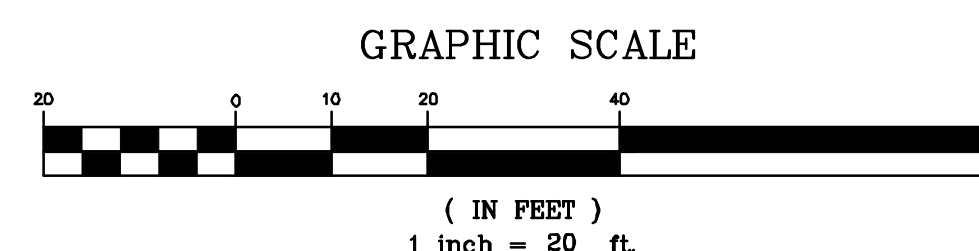

PROJECT NO  
2203-1

ARCHITECTURAL VISION GROUP, LTD  
ARCHITECTS • PLANNERS  
23850 SPERRY DRIVE CLEVELAND, OHIO 44145

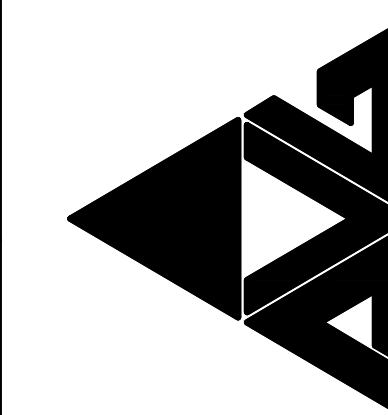

**CONSULTANT:**

  
**LEWIS AND CLARK PROFESSIONALS**  
INC.  
Civil Engineering & Land Surveying

8691 WADSWORTH ROAD  
SUITE 100  
WADSWORTH, OH 44281  
PH (330) 335-8232  
FX (330) 335-0242  
[WWW.LANDPROSING.COM](http://WWW.LANDPROSING.COM)

MASSILON CITY SCHOOL  
WEST SIDE CAMPUS  
250 39th St NW, Massillon, OH 44647

[illegible]

PROJECT NO	2203-1
DRAWN BY	
CHECKED BY	
DATE	09.14.2022

# STORMWATER MANAGEMENT BASIN PLAN

SCALE: 1" = 20'

SHEET NO  
C-701

— PLAN PREPARED BY —  
**IS LAND PROFESSIONALS INC.**

**CIVIL ENGINEERING**      **LAND SURVEYING**  
8691 WADSWORTH ROAD      SUITE 10  
WADSWORTH, OH 44281      (330) 335-823



22-071 STORMWATER MANAGEMENT BASIN PLANDWN