

NOTE

CONTROL AND BENCH MARK BASED FROM WWTTP 2000 UPGRADE PLANS.

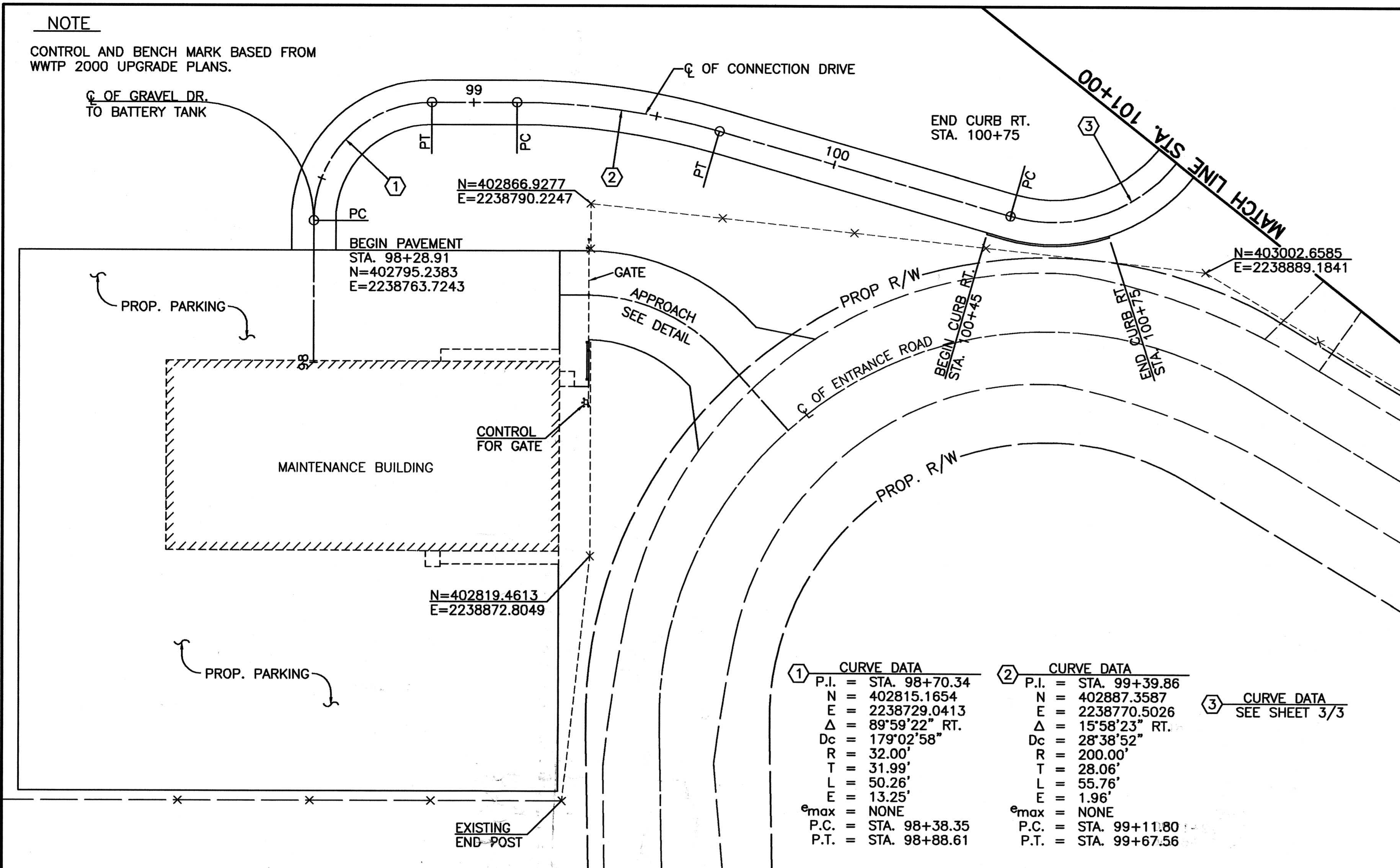

PROP. GRADE	134.73	134.08	133.44	132.91	131.98	130.64	128.90	125.00
140								140
135								135
130								130
125								125
120								120
115								115
110								110
EXIST. GRADE	134.99	134.89	134.22	134.45	132.79	131.60	125	
	98	99	100	100	100	101		

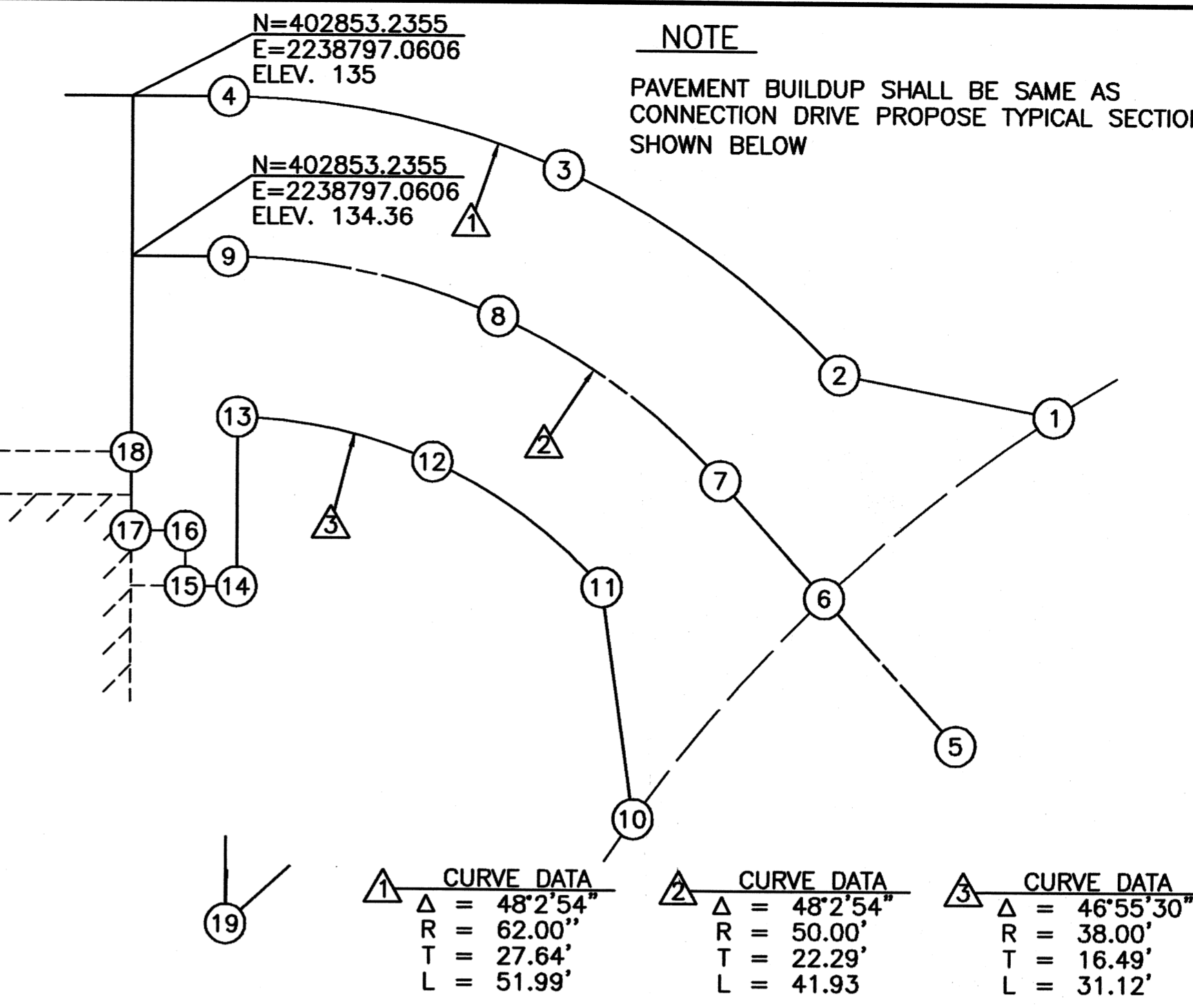

REF.	NORTH	EAST	ELEVATION
1	402901.7227	2238852.2244	132.65
2	402889.2635	2238841.4753	133.18
3	402878.7367	2238817.9134	134.01
4	402859.5291	2238800.6782	134.84
5	402883.0923	2238870.0209	N/A
6	402879.9908	2238855.5063	132.90
7	402877.5285	2238843.9829	133.19
8	402869.0390	2238824.9813	133.74
9	402853.5491	2238811.0820	134.24
10	402859.2069	2238862.7749	134.38
11	402865.7934	2238846.4905	133.10
12	402859.5593	2238832.3514	133.66
13	402848.2112	2238821.8633	134.65
14	402841.8799	2238832.8606	134.75
15	402838.5000	2238830.8148	134.96
16	402840.5457	2238827.3615	134.92
17	402836.9925	2238825.3158	135.00
18	402839.9312	2238820.2113	134.94

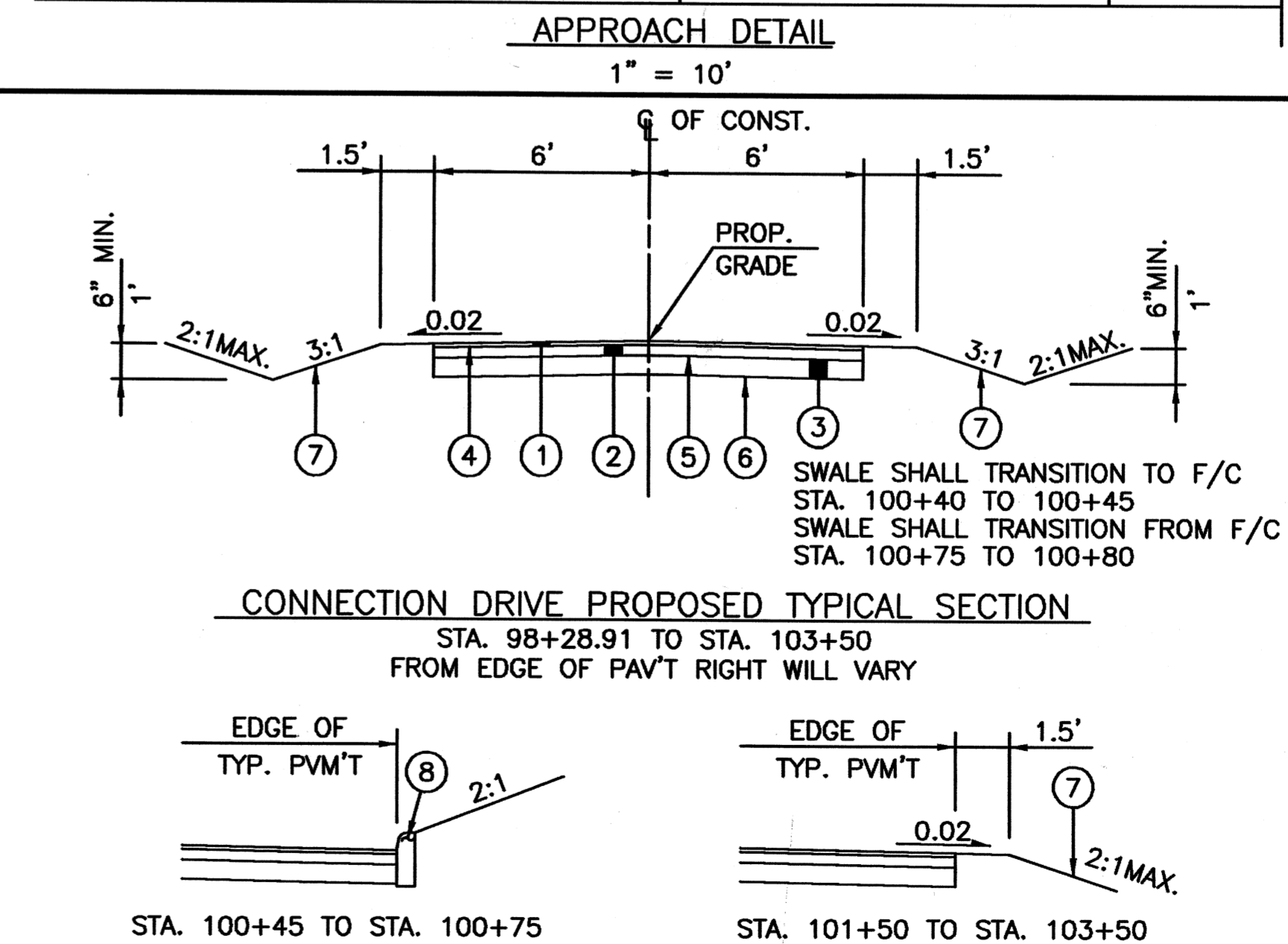

- ① - ITEM 404-1 1/2" ASPHALT CONCRETE
- ② - ITEM 402-4 1/2" ASPHALT CONCRETE
- ③ - ITEM 304-8" AGGREGATE BASE
- ④ - ITEM 407-TACK COAT
- ⑤ - ITEM 408-PRIME COAT
- ⑥ - ITEM 203-SUBGRADE COMPACTION
- ⑦ - ITEM 659-SEEDING AND MULCHING
- ⑧ - ITEM 609-TYPE 6 CONCRETE CURB

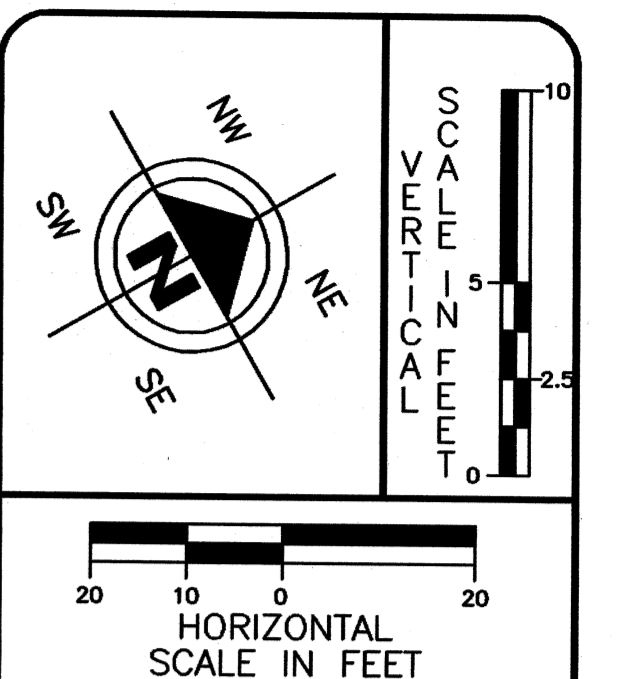

DRAWN BY: FPW
 CHECKED BY: SDH
 DATE: June 13, 2003
 DATE: June, 2003

Waste Water Treatment Plant
 Connection Drive and Approach Plan and Profile and Details
 City of Massillon
 Stark County, Ohio



REVISIONS:

DATE	DESCRIPTION

FILE NAME: xx.DWG
 ACCOUNT NUMBER: xxxxx

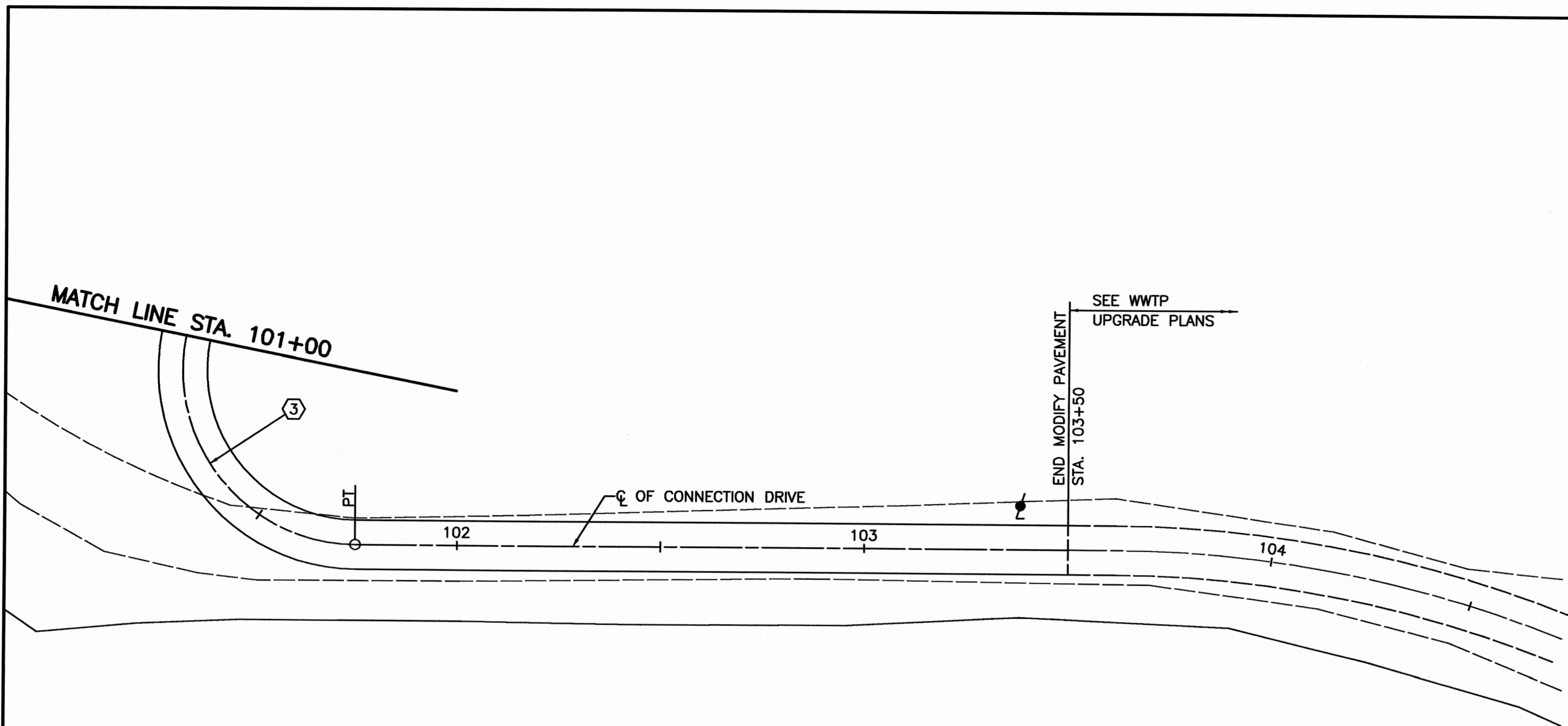

CURVE DATA

③
 P.I. = STA. 104+82.28
 Δ = 168°46'30" LT.
 D₈₀ = 134°48'49"
 R = 42.50'
 T = 432.48
 L = 125.19
 E = 392.06'
 P_{max} = NONE
 P.C. = STA. 100+49.80
 P.T. = STA. 101+75.00

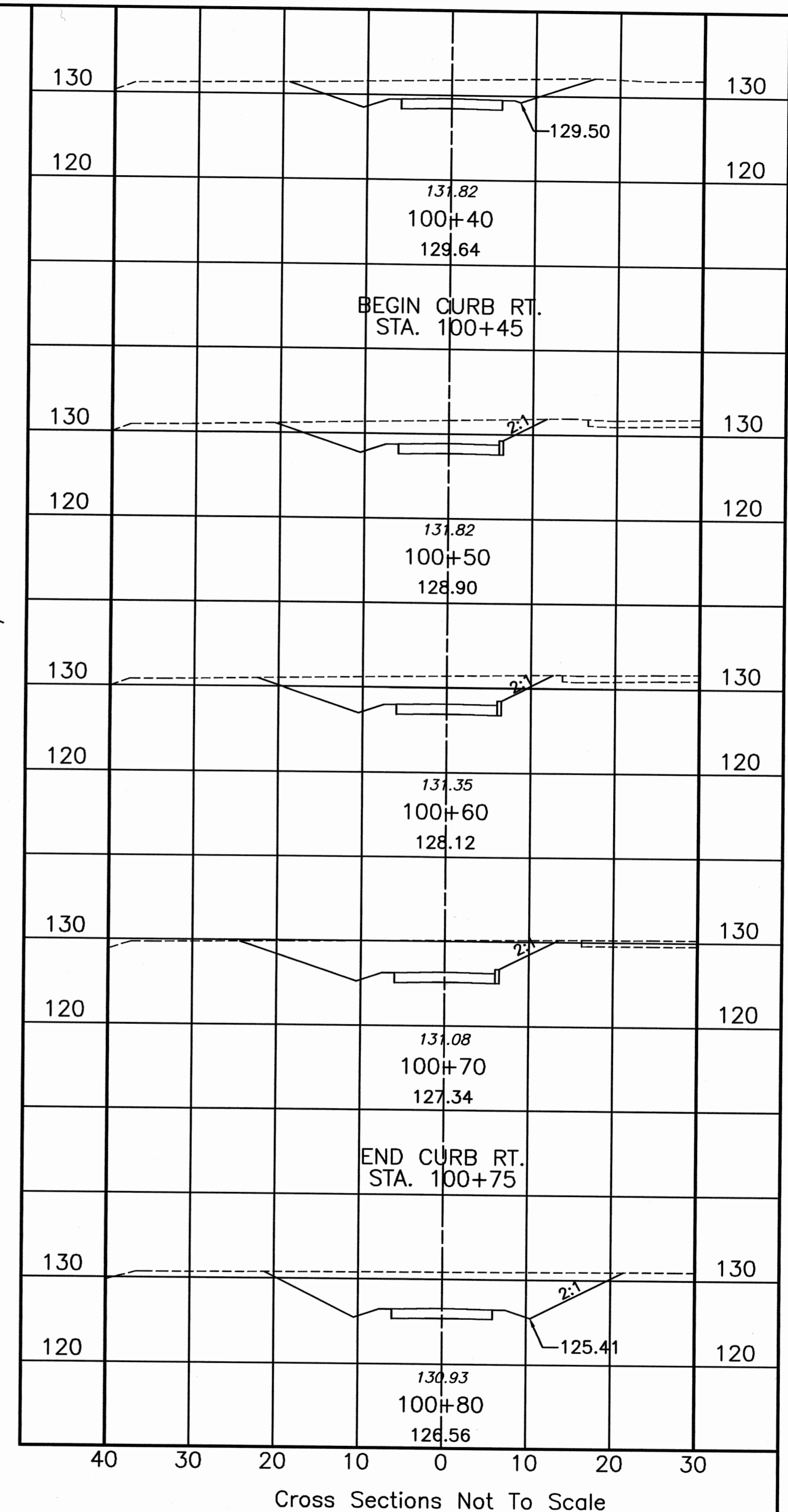
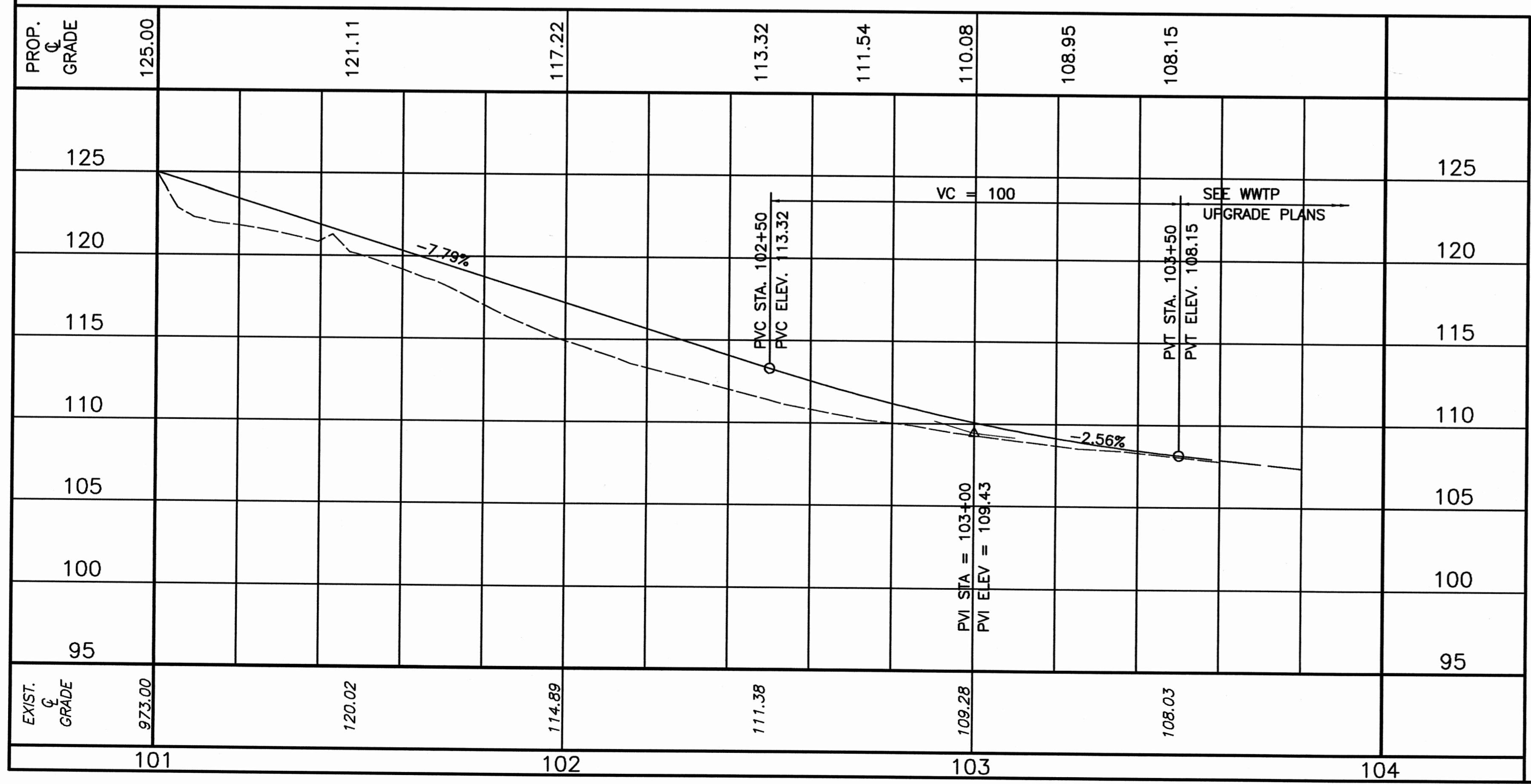

Cross Sections Not To Scale

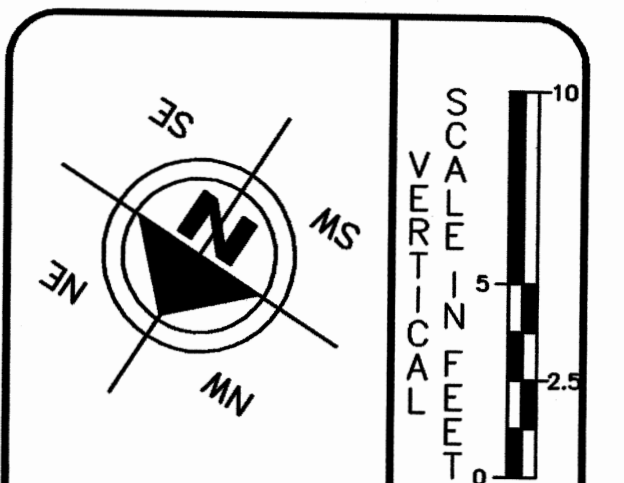

HORIZONTAL SCALE IN FEET
 20 10 0 10 20

DRAWN BY: FPW
 CHECKED BY: SDH
 DATE: June 13, 2003
 DATE: June, 2003

Waste Water Treatment Plant
 Connection Drive Plan and Profile Sta. 101+00 to Sta. 104+50 and Cross Sections
 City of Massillon
 Stark County, Ohio



REVISIONS:

DATE	DESCRIPTION

FILE NAME: IPDR2PP.DWG
 ACCOUNT NUMBER: WPCLF

GRADING AROUND THE CURVE SHALL BE NO GREATER THAN 2:1 UNLESS OTHERWISE DIRECTED BY THE ENGINEER.

ALL ELEV. ARE SHOWN @ EDGE OF PAVEMENT.

PROPOSED FENCE TO BE PARALLEL WITH THE WEST SIDE OF THE PROPOSED CURB - 7' OFFSET.

WWTP ROAD AT ENTRANCE SHALL HAVE 4" DROP CURB.

CONTROL BASED ON WWTP UPGRADE 2000 PLANS.

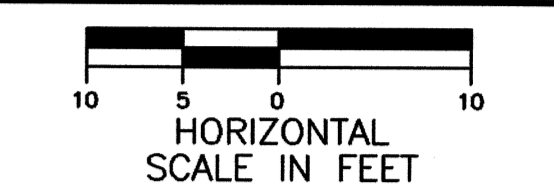
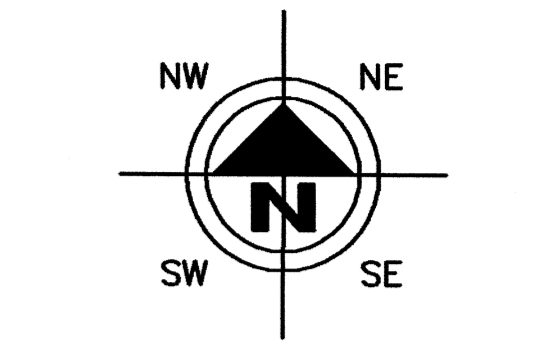
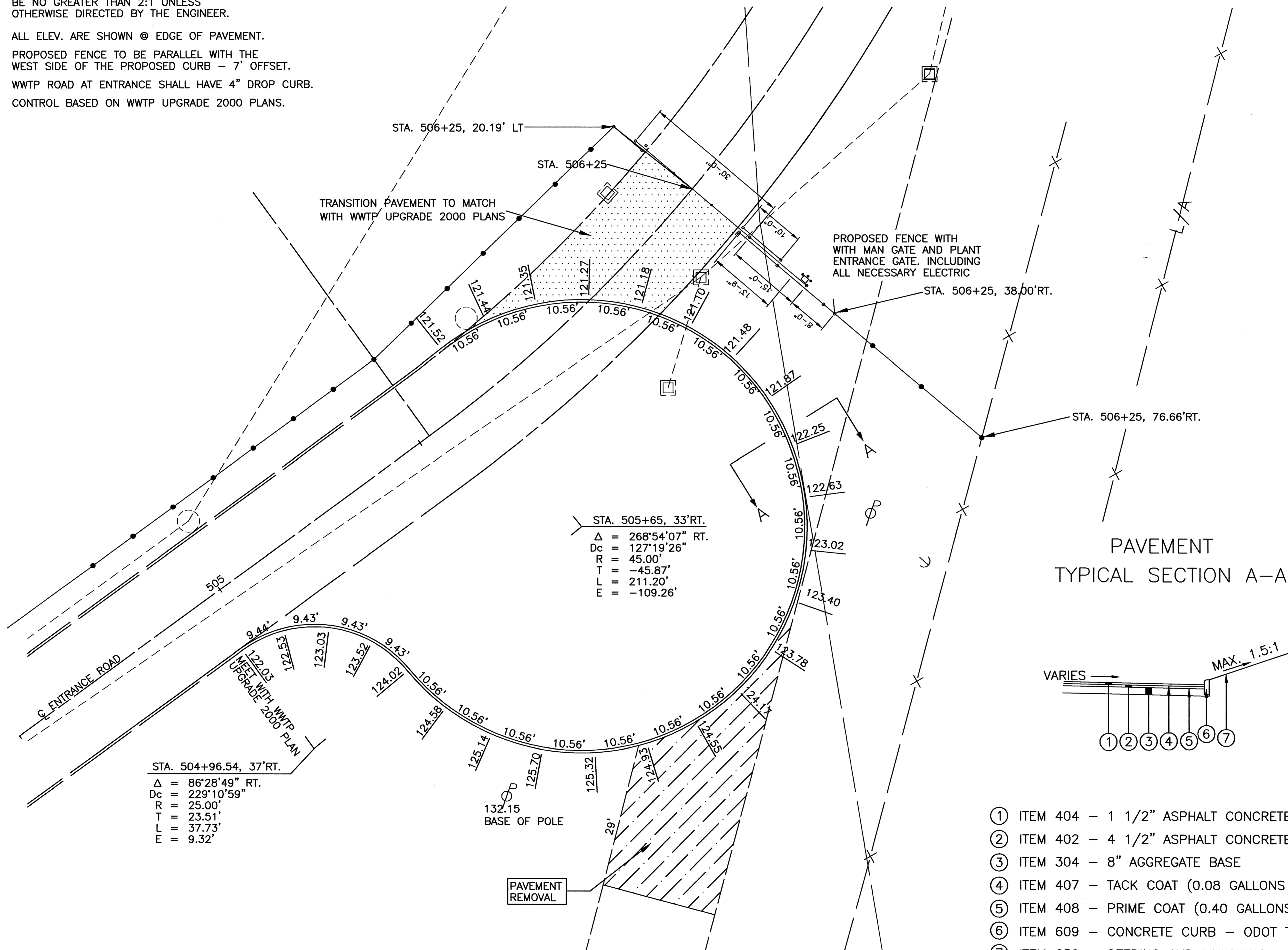

DRAWN BY: FPW	CHECKED BY: GM
DATE: April 12, 2004	DATE: April 12, 2004

Treatment Drive. Cul-De-Sac
 Detail
 City of Massillon
 Stark County, Ohio



REVISIONS:	
DATE	DESCRIPTION

ELECTRONIC FILE NAME:
CULDETAIL.DWG

ACCOUNT NUMBER:
WWTP

- ① ITEM 404 - 1 1/2" ASPHALT CONCRETE
- ② ITEM 402 - 4 1/2" ASPHALT CONCRETE
- ③ ITEM 304 - 8" AGGREGATE BASE
- ④ ITEM 407 - TACK COAT (0.08 GALLONS PER SQ. YD.)
- ⑤ ITEM 408 - PRIME COAT (0.40 GALLONS PER SQ. YD.)
- ⑥ ITEM 609 - CONCRETE CURB - ODOT TYPE 6
- ⑦ ITEM 659 - SEEDING AND MULCHING